

ACC EXPANSION

BLPC/PFRC JOINT MEETING #9

FEBRUARY 19, 2020



WELCOME



PROJECT UPDATES



PROJECT UPDATES

1. **January 22, 2020: Community Meeting**
2. **January 23, 2020: APS/ACG Work Session (Transportation, Parking)**
3. **January 27, 2020: BLPC/PFRC Leadership Meeting**
4. **February 5, 2020: APS/ACG Work Session (Transportation, Parking)**
5. **February 7, 2020: APS/ACG Work Session (Utilities, Storm Water Management)**

AGENDA



ALMOST THERE!

2020							
January				February			
W 01	W 02	W 03	W 04	W 01	W 02	W 03	W 04
						19	26

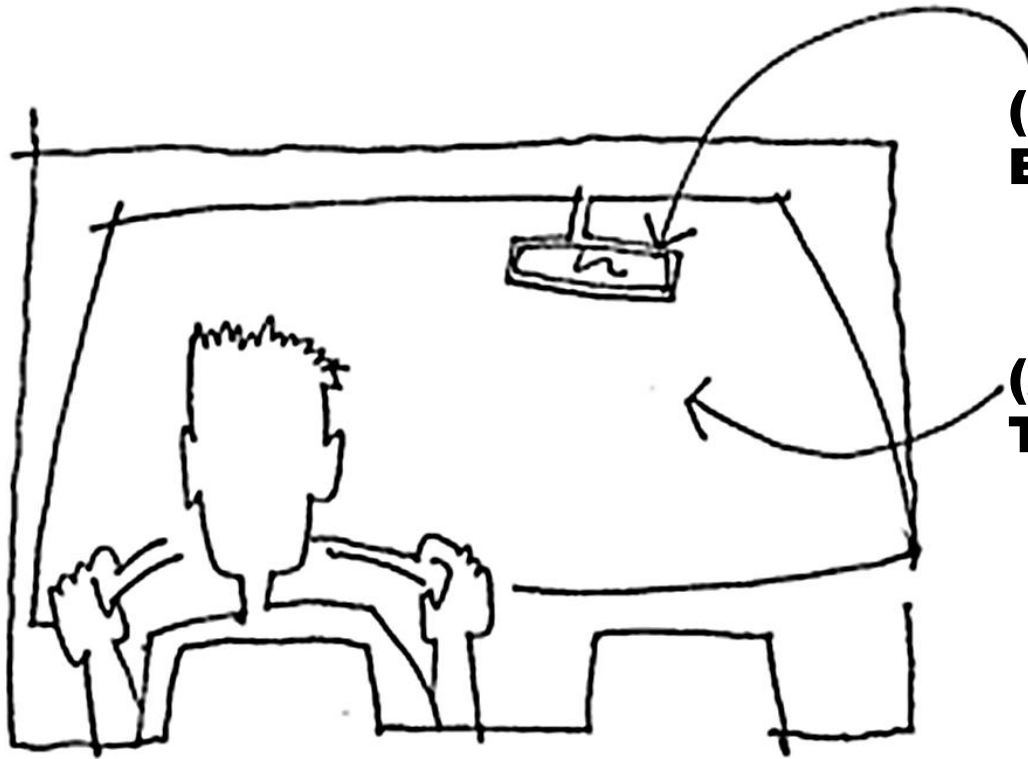

**(8) MEETINGS
BEHIND US!**

**(2) MEETINGS
TO GO!**

#9 Proposed Concept Design

- Building Plans - Program Alignment
- Massing and Architectural Expression
- Transportation/Parking/Site
- Phasing
- Public Comment

Outcome

Secure committee input/ feedback and endorsement, prepare letters of recommendation to School and County Boards.

#10 Final Concept Design

- Concept Design Documents
- Next Steps for BLPC/PFRC
- Public Comment

Outcome

Celebrate successful committee effort to develop and recommend Concept Design to School and County Boards.

AGENDA

1. Welcome
2. Project Updates
3. Concept Design
 - Brief review
 - Converging on a concept
 - Meet your concept
4. Committee Discussion
5. Public Comment
6. Adjourn

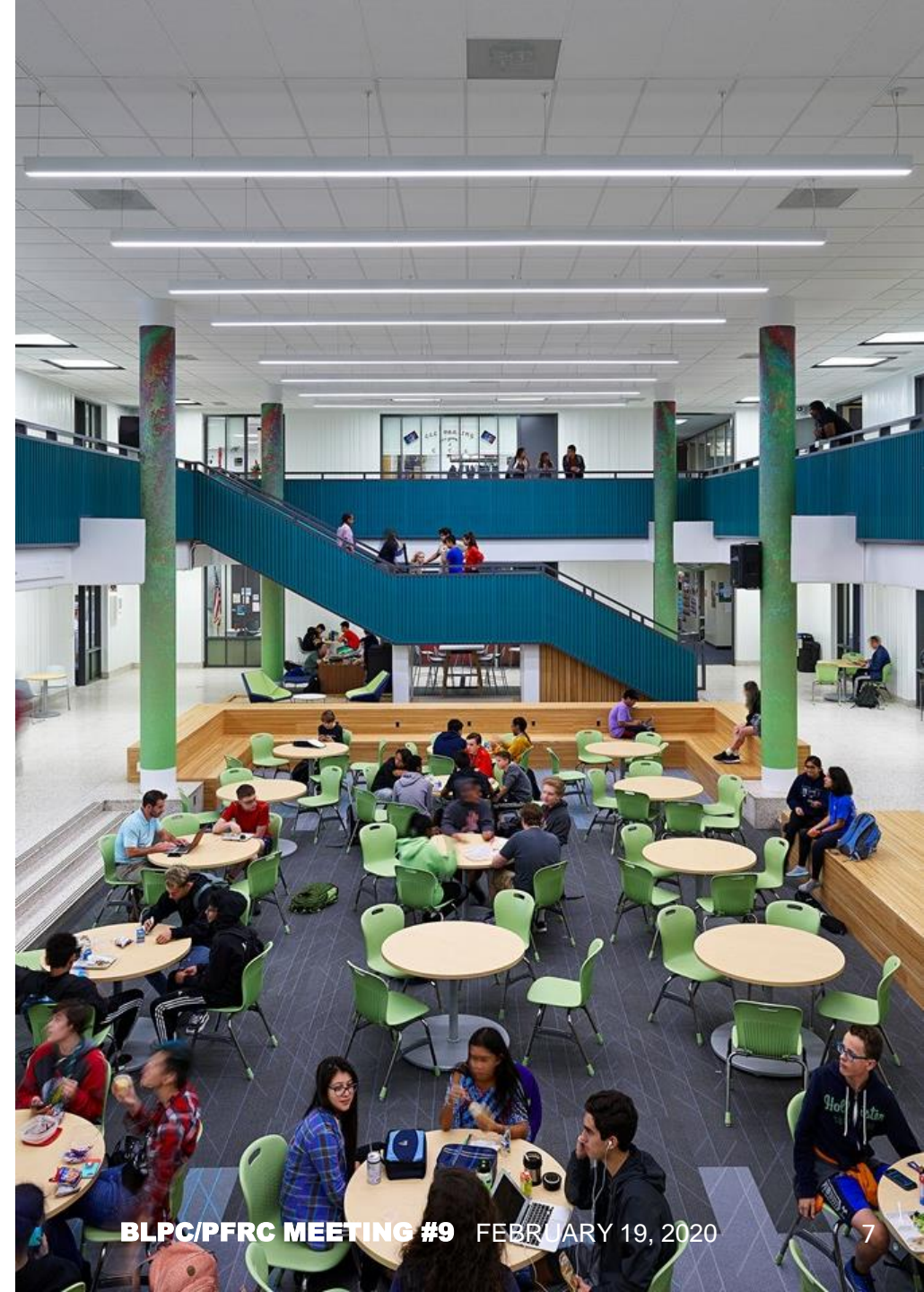

CONCEPT DESIGN



MEETING 2: CCWG RECOMMENDATIONS

“In all its deliberations, the CCWG expressed that the Career Center site should be considered the **‘Jewel of the Pike,’** a site that will improve upon available **community amenities**, contribute prominently to **place-making on the Pike**, and whose **exterior architecture** will equal the **unique and excellent education** offered within its buildings.”

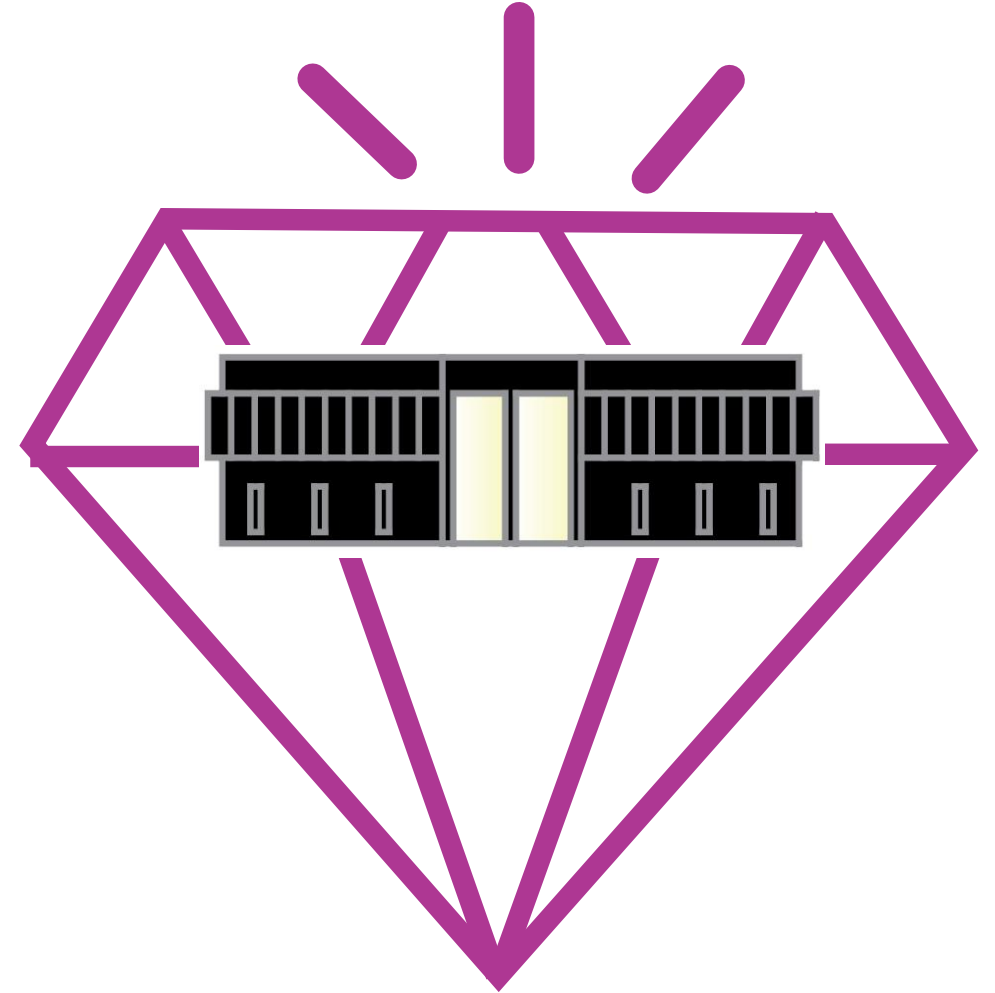

TRANSLATING THE ED SPECS

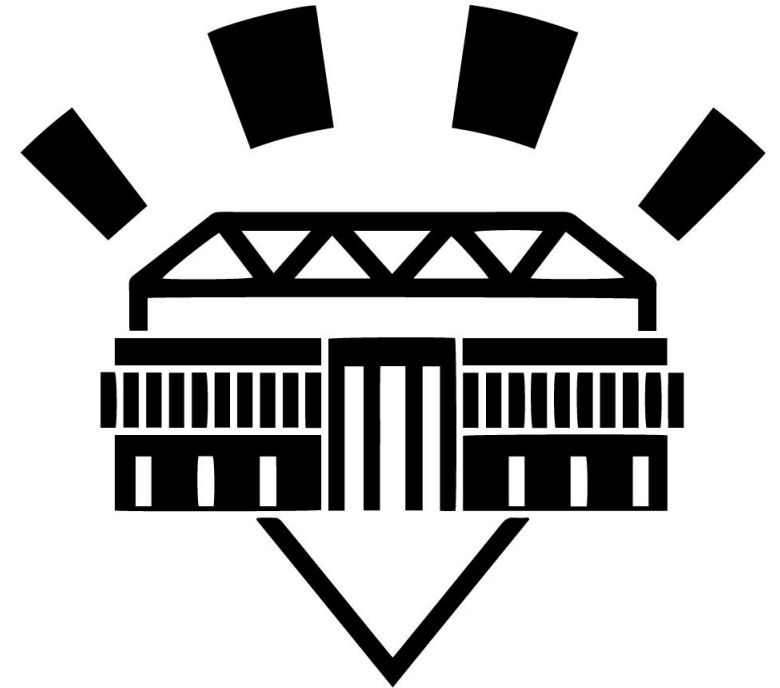
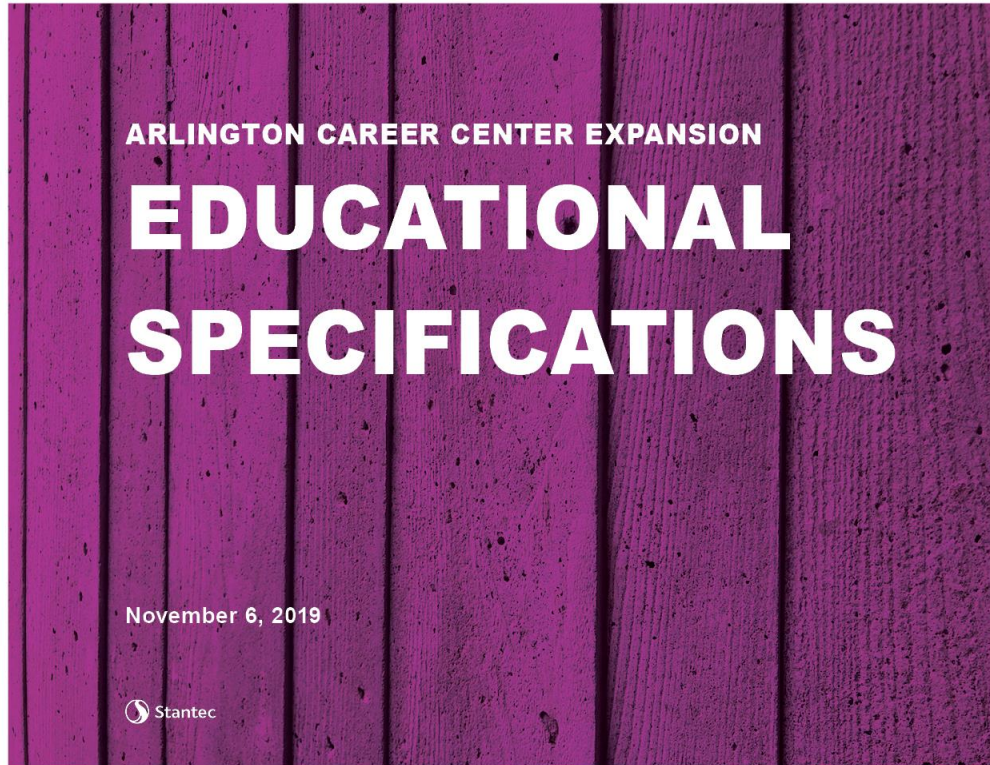

TRANSLATING THE ED SPECS

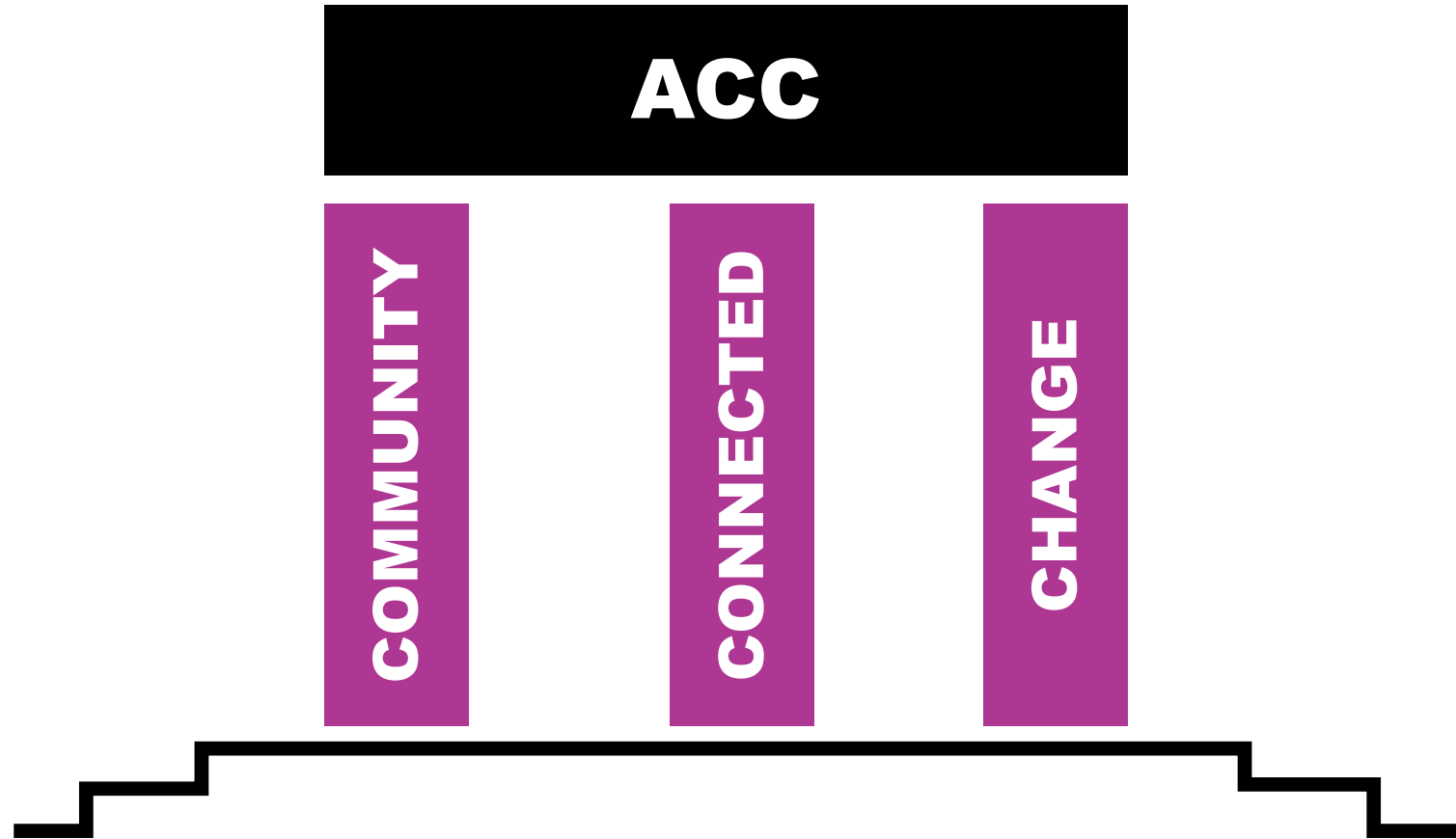

TRANSLATING THE ED SPECS

CONNECTED

- Students and staff at ACC connected in common purpose and experience
- Different instructional programs and students are united as a community of learners

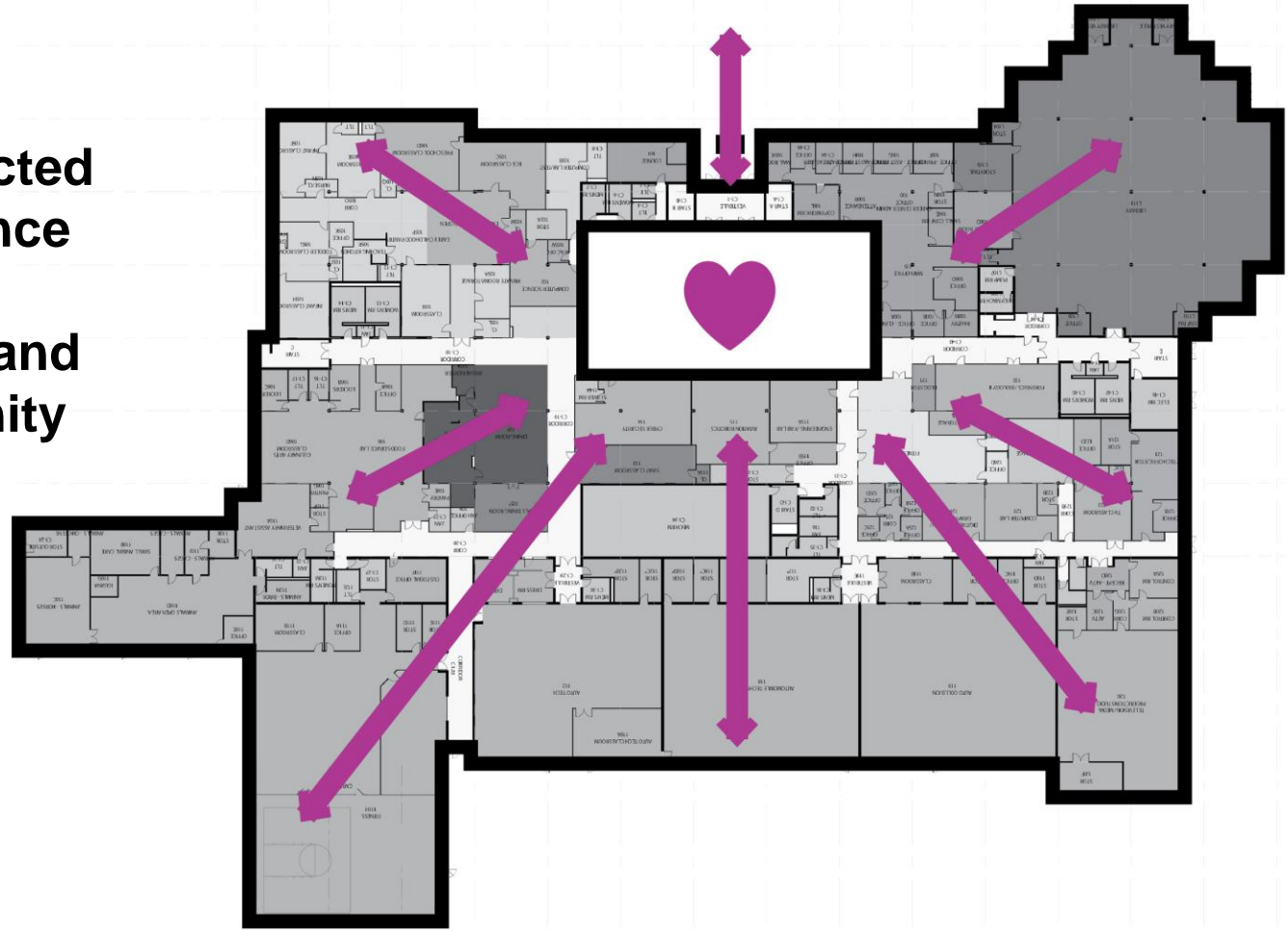

TRANSLATING THE ED SPECS

**HOW MUCH MORE AREA (SF)
IS NEEDED?**

370,800 SF (ED SPEC)

- 167,000 SF (EXISTING)

203,800 SF (NEEDED)

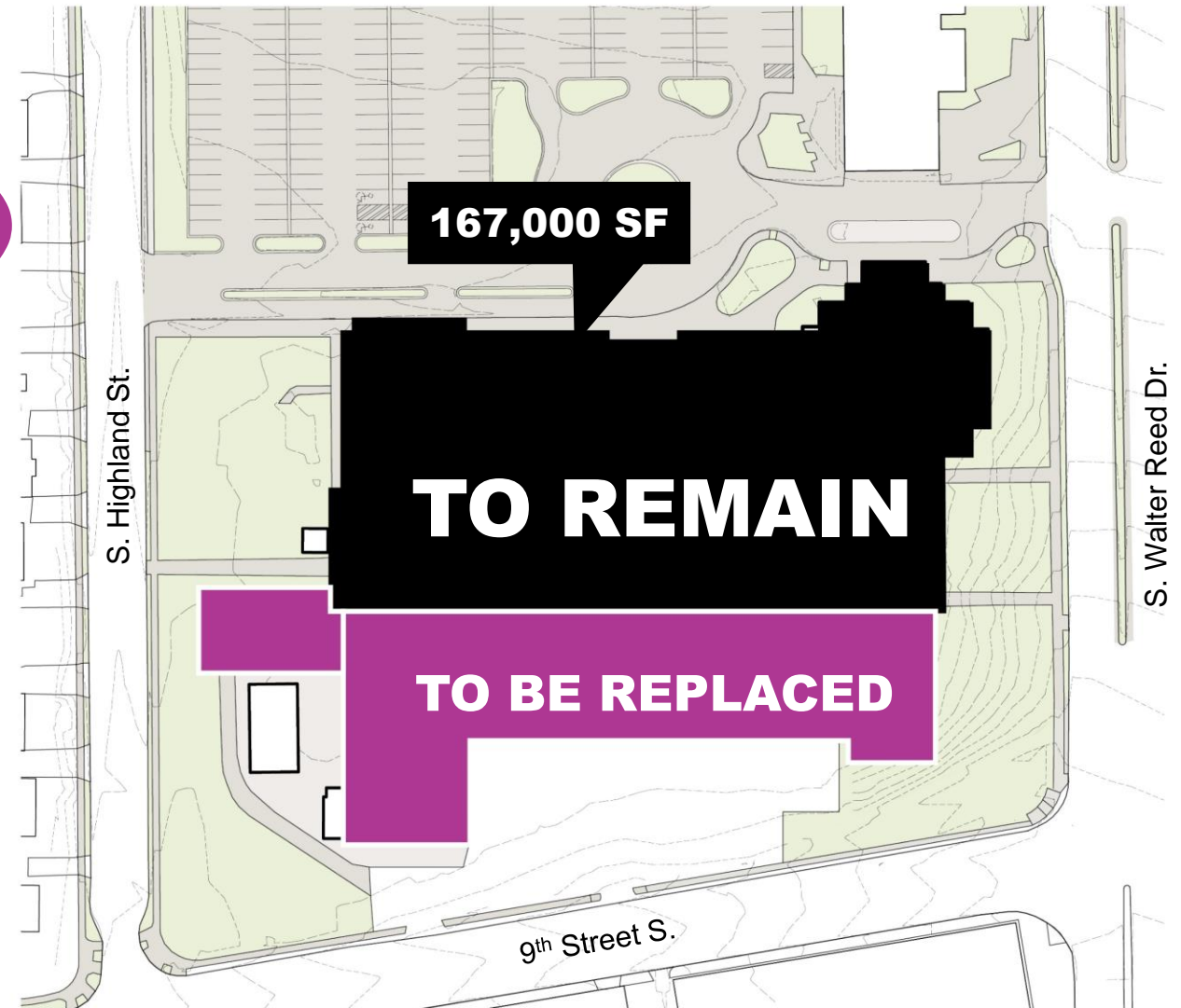

MEETING 7: AREAS OF EARLY AGREEMENT

1. CTE / Auto Programs Relocation
2. Community Program Location
 - Gym / Auditorium
3. Service Location

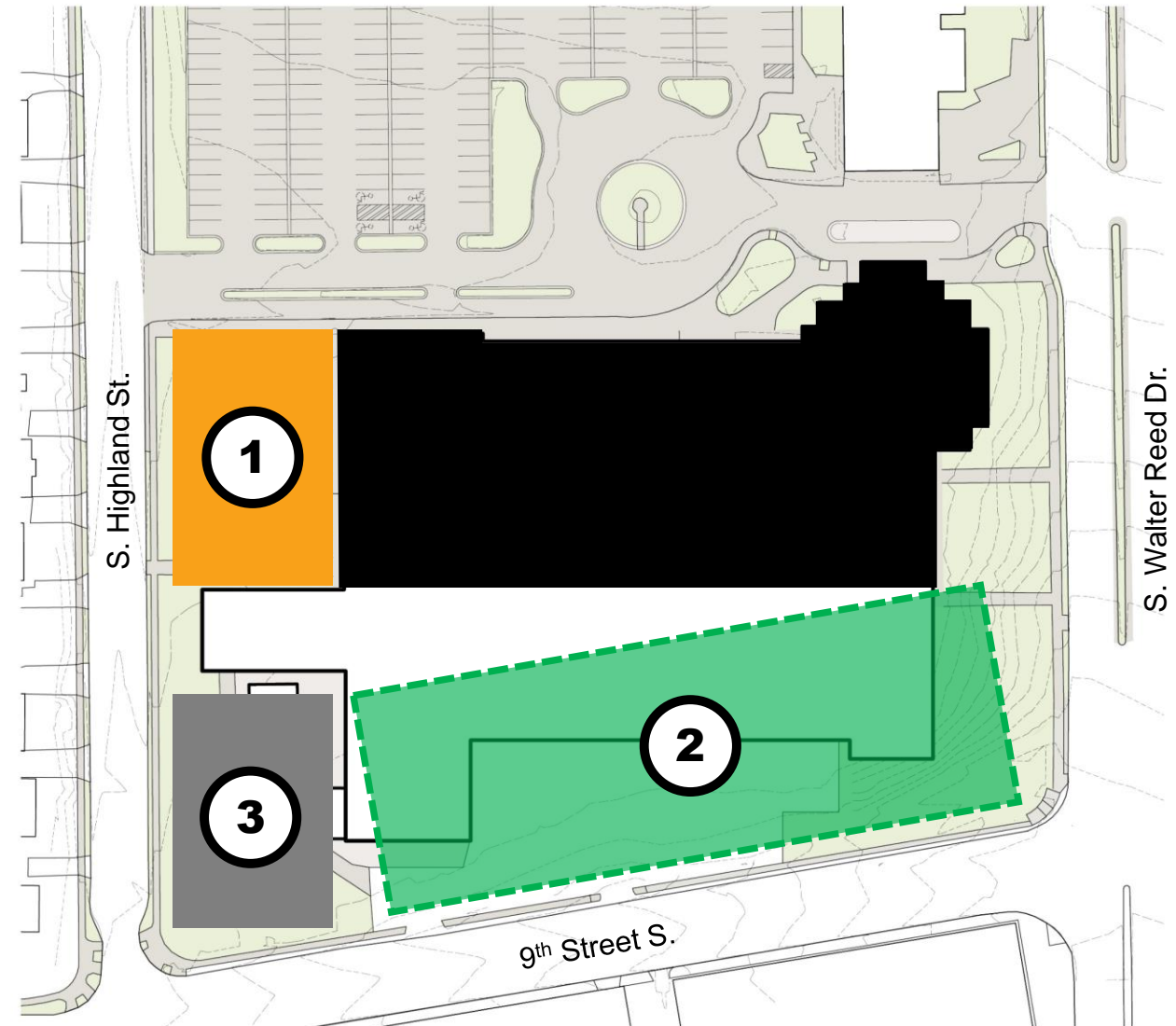

MEETING 7: INITIAL MASSING STUDIES

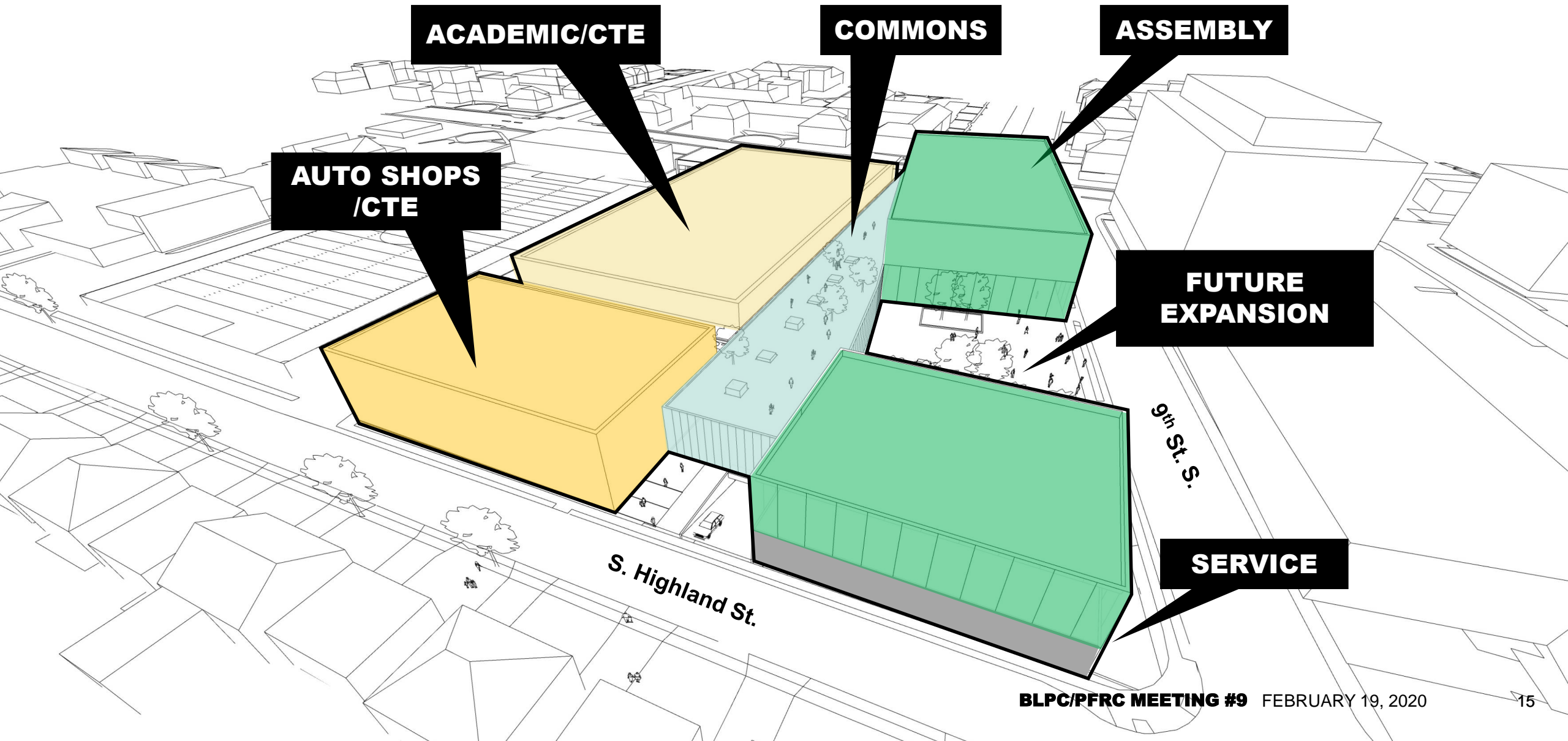

MEETING 7: FURTHER CONSIDERATIONS

1. Circulation pattern through the building
2. Formal Entry @ 9th St. S. and S. Walter Reed Dr.
3. Bus loading/unloading @ 9th St. S.
4. 8'-10' Slope from Highland to Walter Reed
5. Service/Delivery Location
6. Tree Preservation



MEETING 8: FURTHER CONSIDERATIONS

1. Circulation pattern through the building
2. Formal Entry @ 9th St. S. and S. Walter Reed Dr.
3. Bus loading/unloading @ 9th St. S.
4. 8'-10' Slope from Highland to Walter Reed
5. Service/Delivery Location
6. Tree Preservation



MEETING 8: FURTHER CONSIDERATIONS

1. Circulation pattern through the building
2. Formal Entry @ 9th St. S. and S. Walter Reed Dr.
3. Bus loading/unloading @ 9th St. S.
4. 8'-10' Slope from Highland to Walter Reed
5. Service/Delivery Location
6. Tree Preservation
7. Future Expansion, Building Height



MEETING 8: FUTURE EXPANSION

1. Along 9th St. S., between Gym and Auditorium.

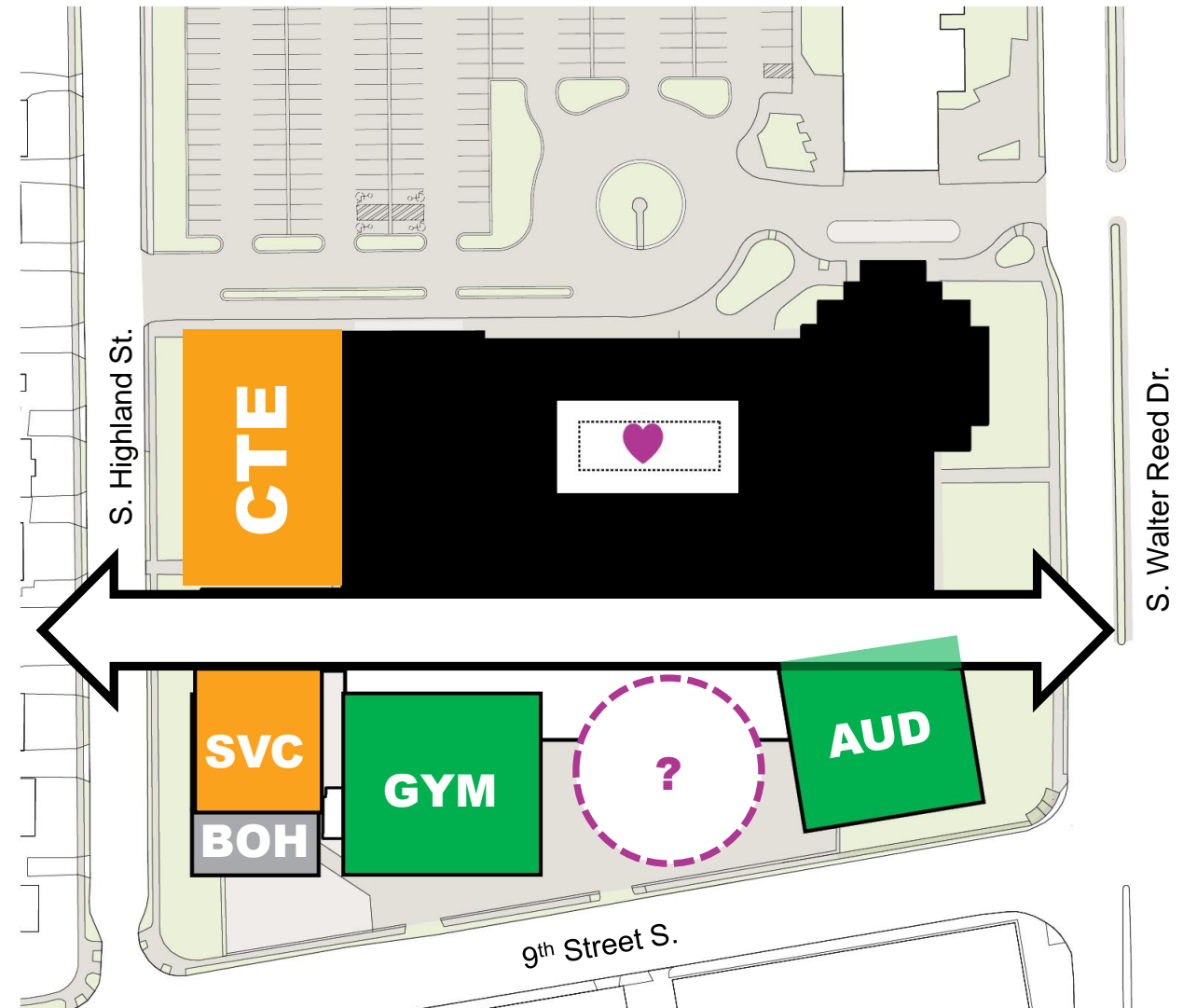

MEETING 8: FUTURE EXPANSION

1. Along 9th St. S., between Gym and Auditorium.
2. Somewhere else along 9th St. S.?

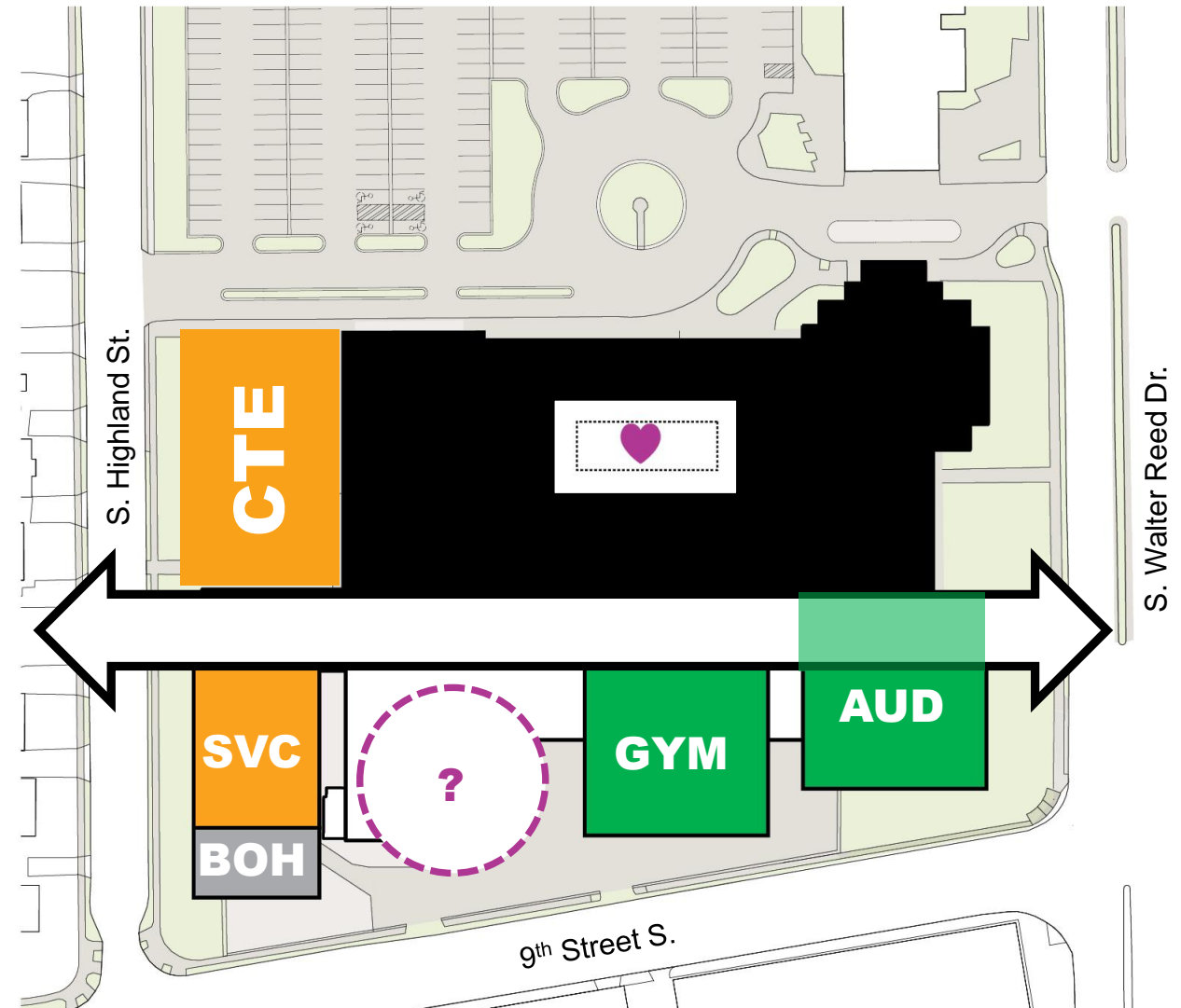

MEETING 8: FUTURE EXPANSION

1. Along 9th St. S., between Gym and Auditorium.
2. Somewhere else along 9th St. S.?
3. On the corner of 9th St. S. and S. Highland St.?

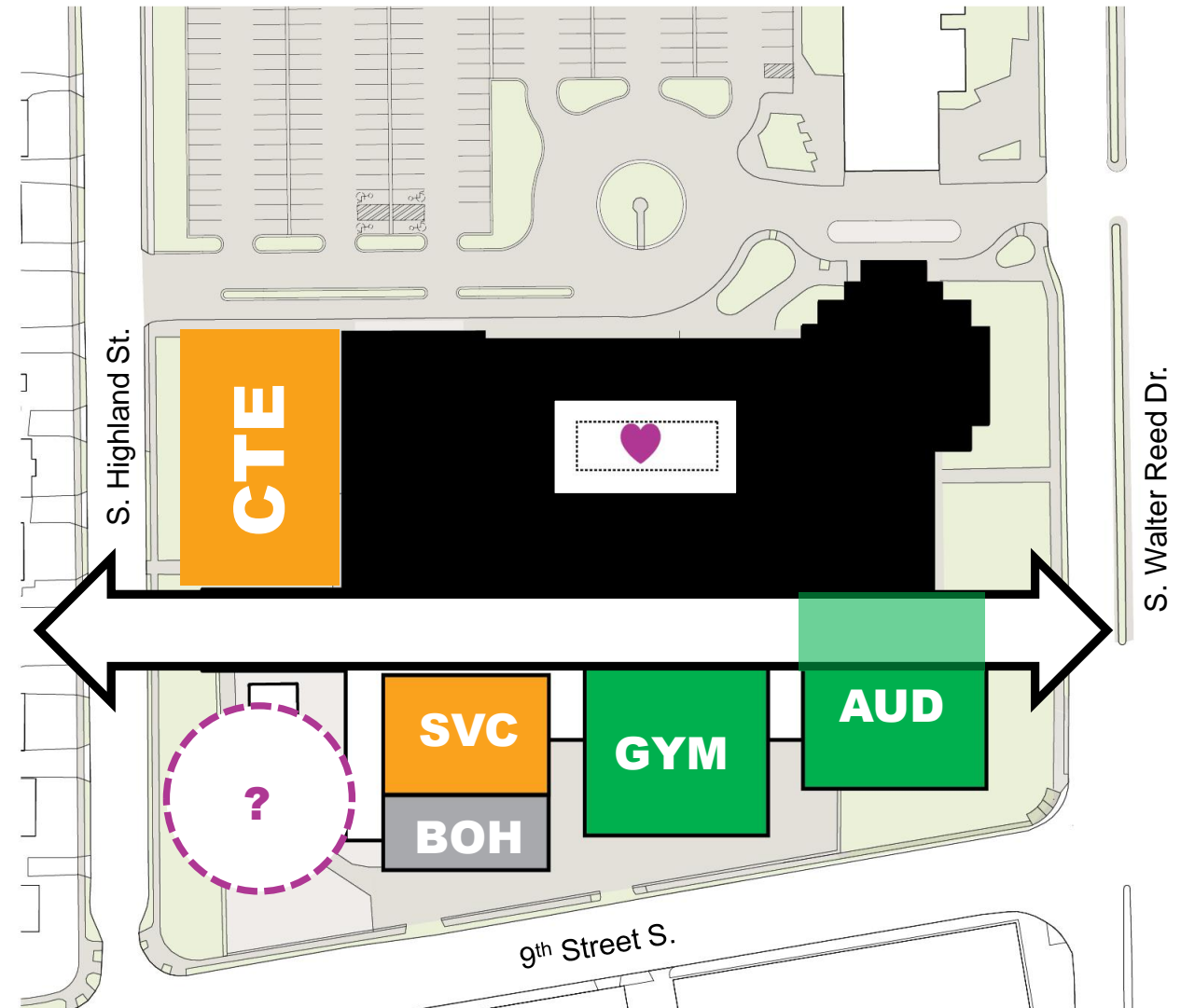

MEETING 8: PRELIMINARY PARTI STUDIES

PARTI 1

BRIDGING OLD AND NEW IN A VILLAGE-LIKE COMPOSITION!

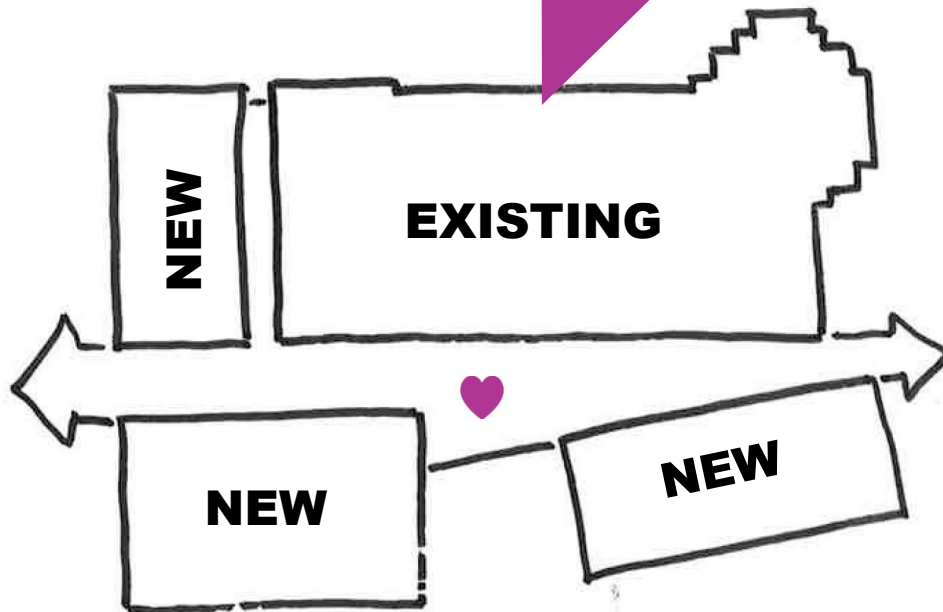

“THE VILLAGE”

PARTI 2

PARALLEL BARS THAT CREATE SCALE, INFORMED BY EXISTING STRUCTURE!



“TOWN GRID”

MEETING 8: PRELIMINARY PARTI STUDIES

PARTI 1

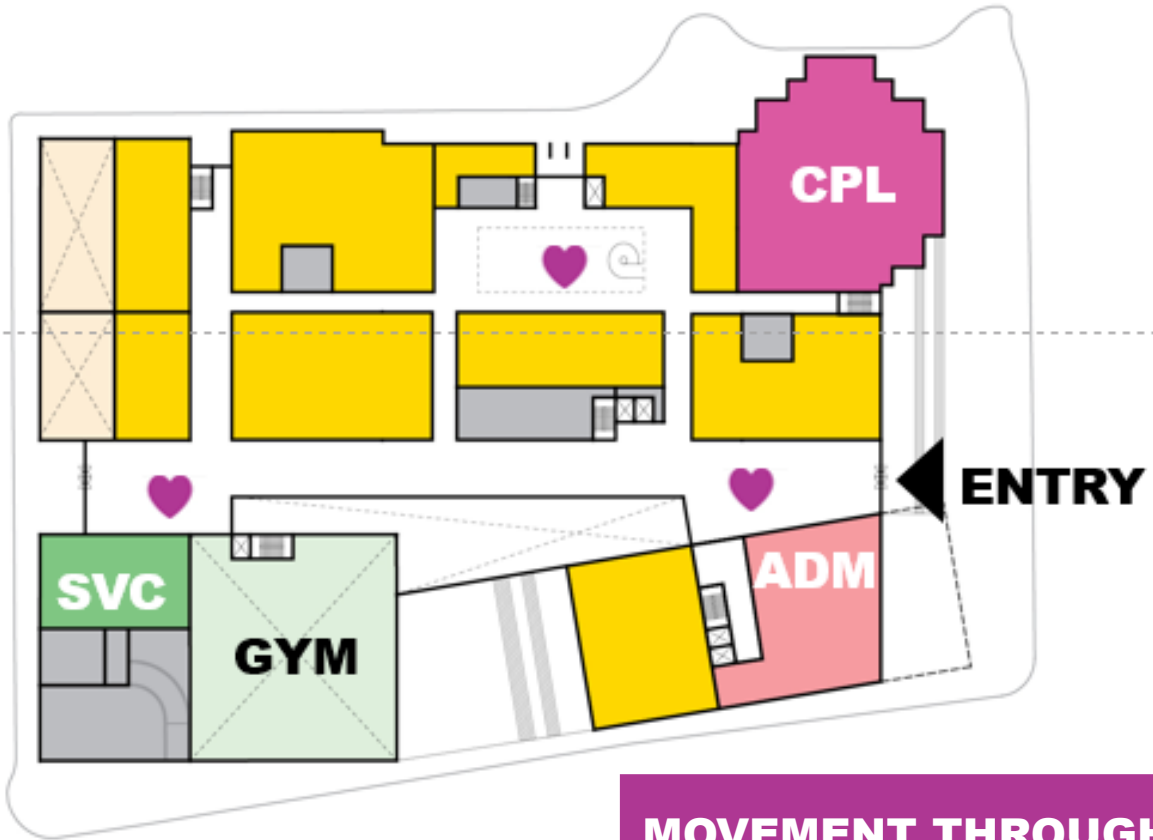

LVL 01

**MOVEMENT THROUGH
SCHOOL AS
ORGANIZING IDEA!**

PARTI 2

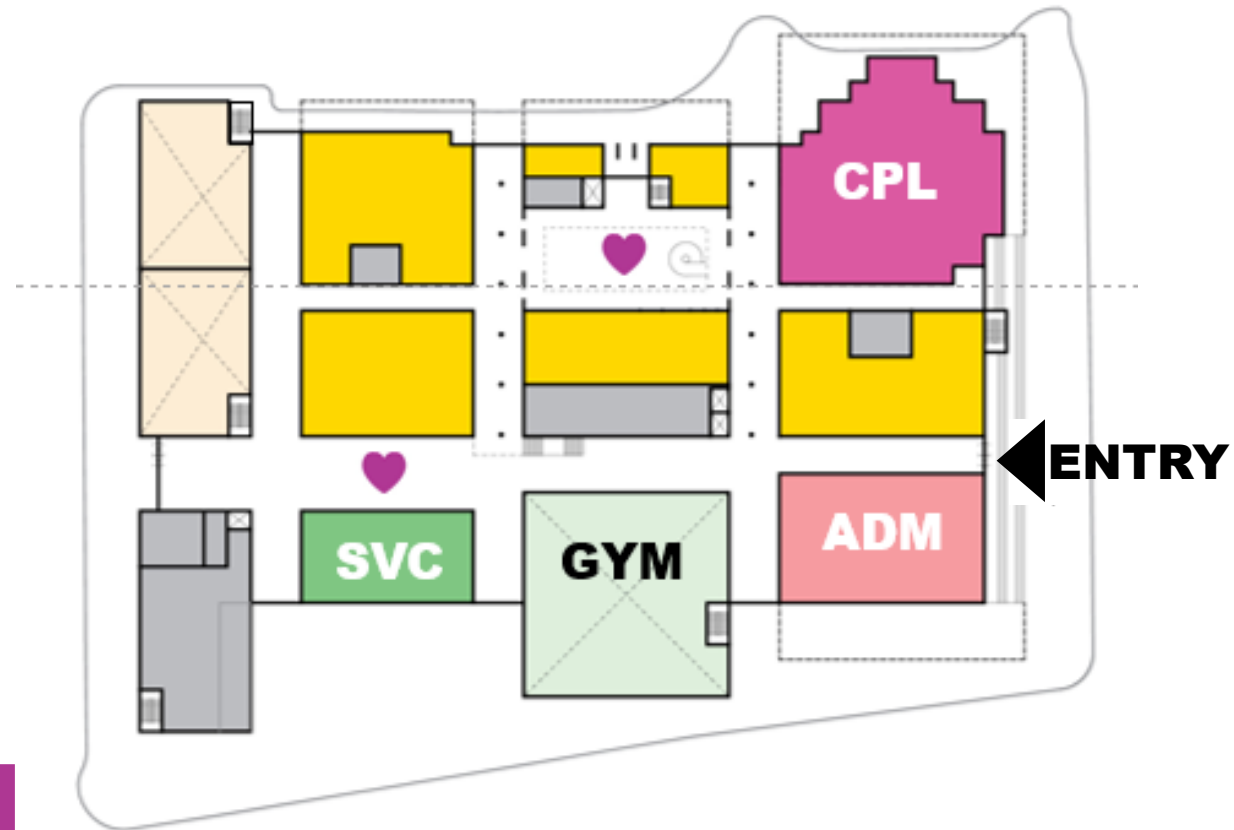

LVL 01

MEETING 8: PRELIMINARY PARTI STUDIES

PARTI 1

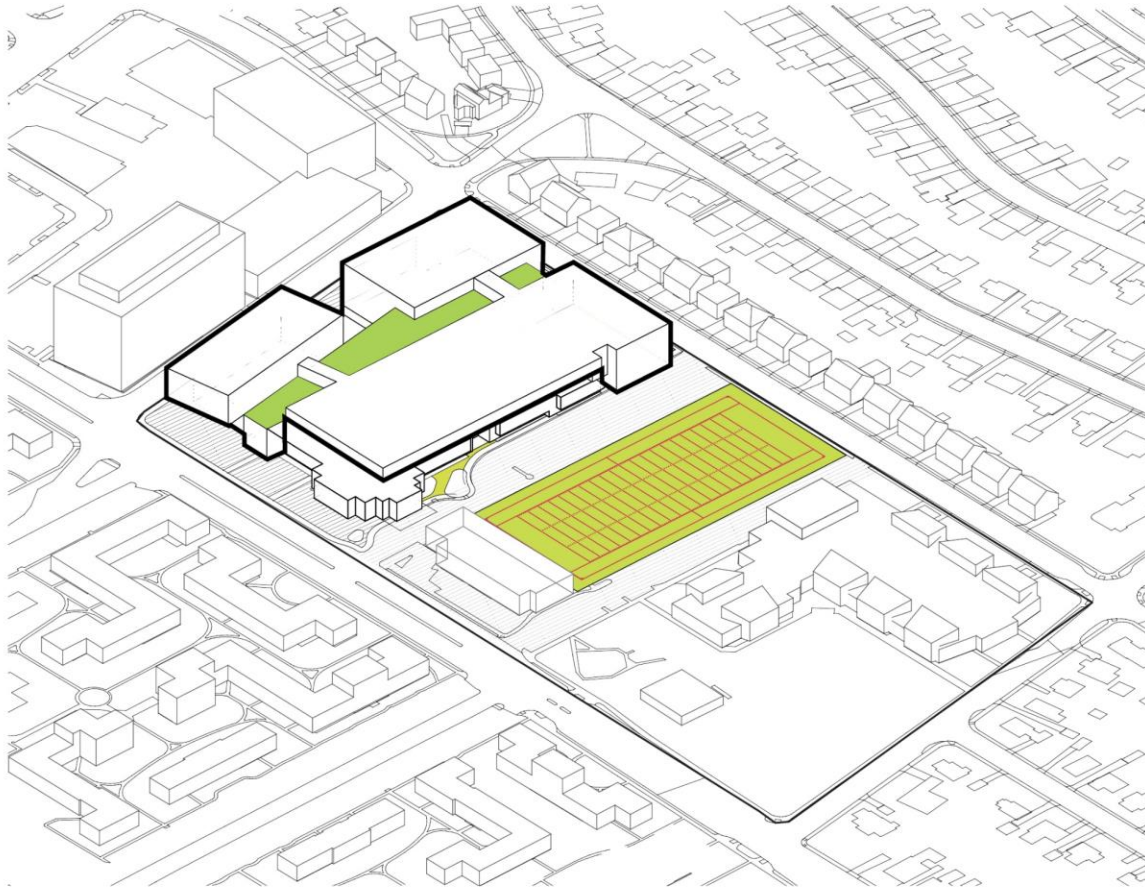

PARTI 2

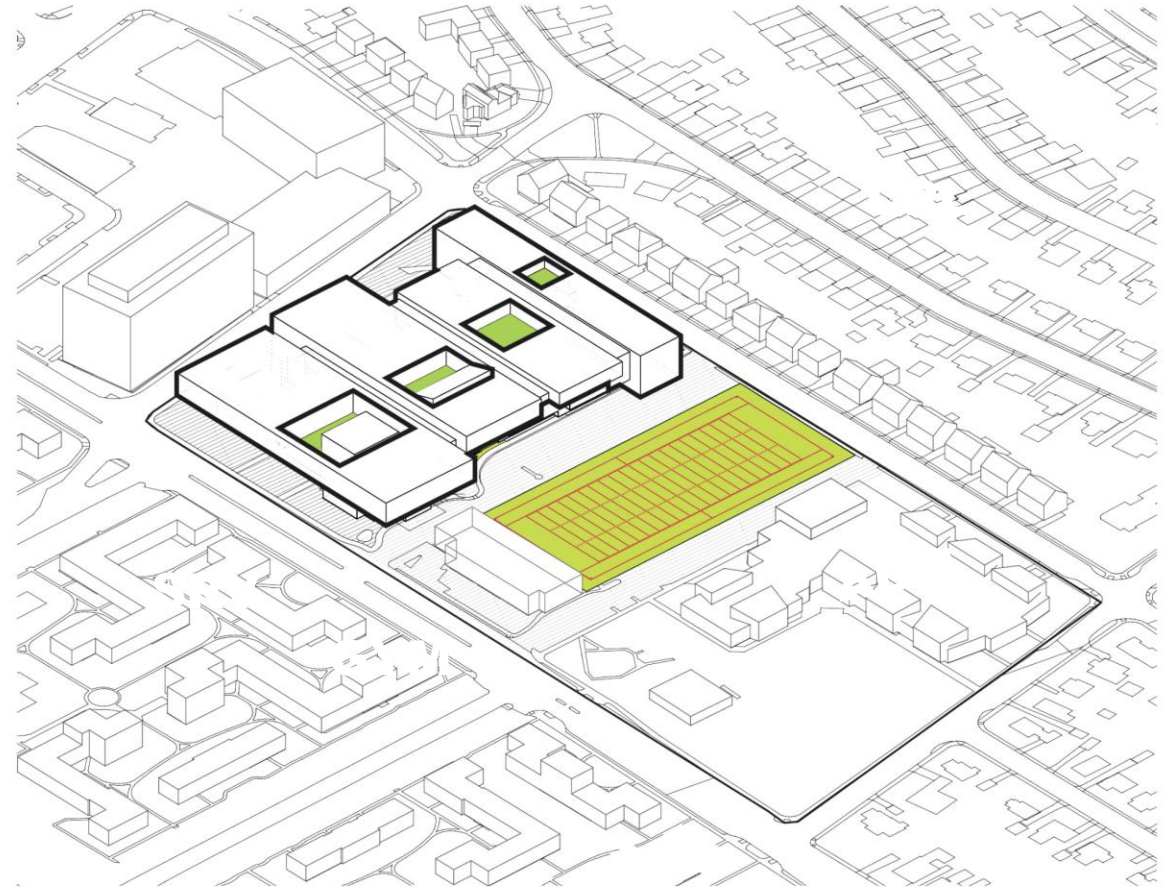

A black and white photograph of a group of men in a meeting room. They are gathered around a long table covered with a large document, possibly architectural plans or a report. The men are looking at the document with interest and focus. The image has a purple tint. Overlaid on the left side of the image is the text 'CONVERGING ON A CONCEPT FOR ACC' in large, white, bold, sans-serif capital letters.

CONVERGING ON A CONCEPT FOR ACC

PROPOSED PHASE 1 AT-A-GLANCE:

1. 25' setback along S. Highland St.
2. Two-story above grade with stepped-back high roof area.
3. One level below grade (Auto).
4. Sufficient space for:
 - Auto Tech & Auto Body
 - Animal Science
 - TV Production
 - Electricity
 - Multi-Purpose

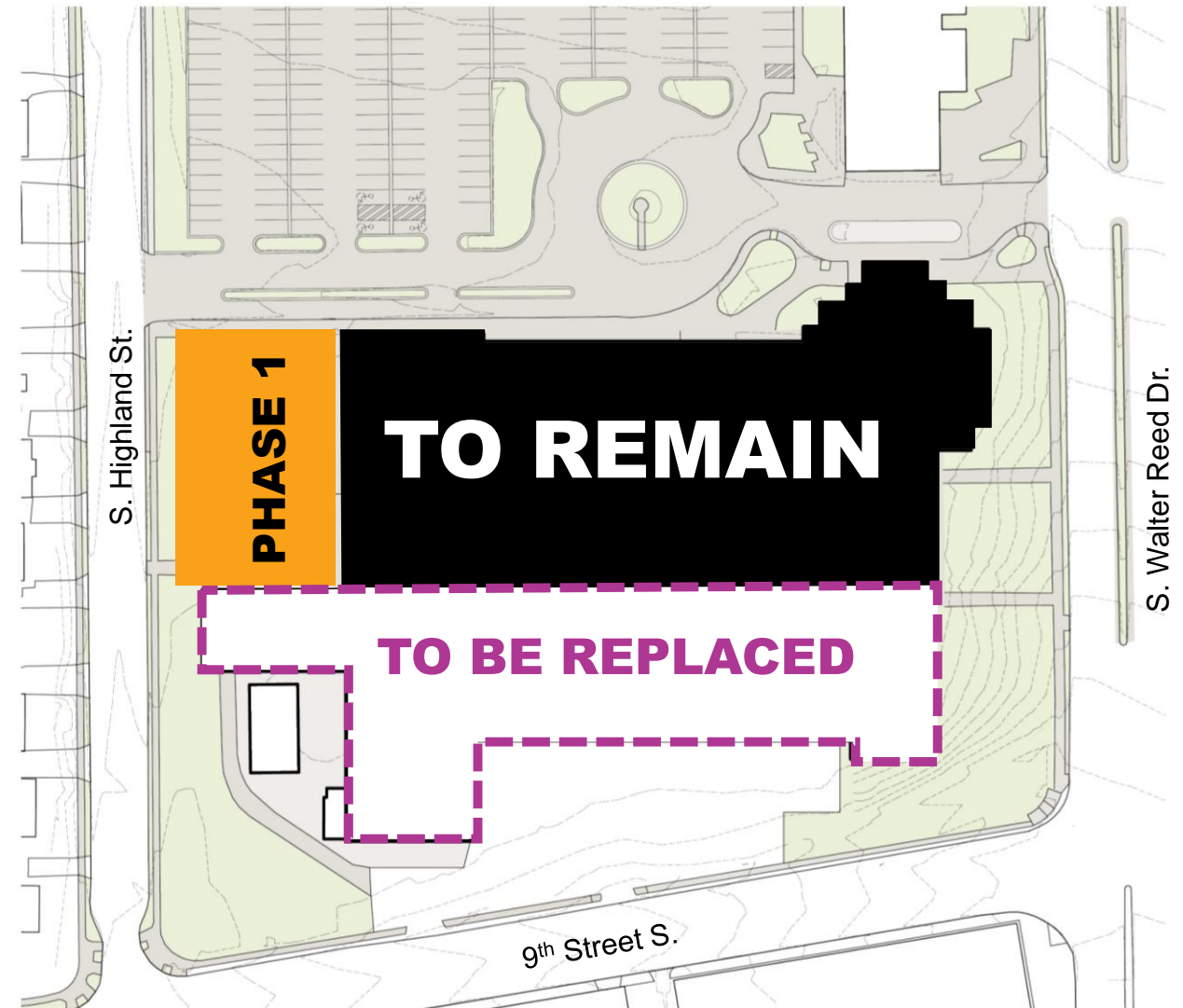

PROPOSED PHASE 1 AT-A-GLANCE:

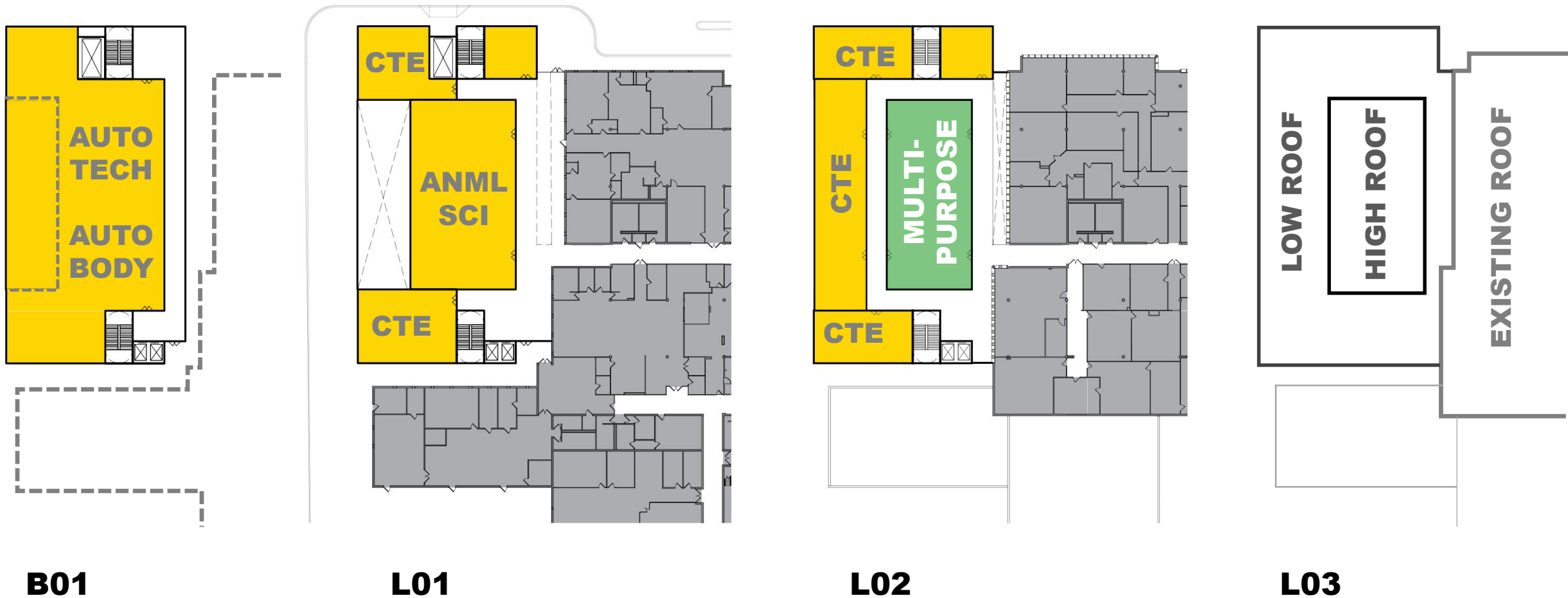

PROPOSED PHASE 1 AT-A-GLANCE:

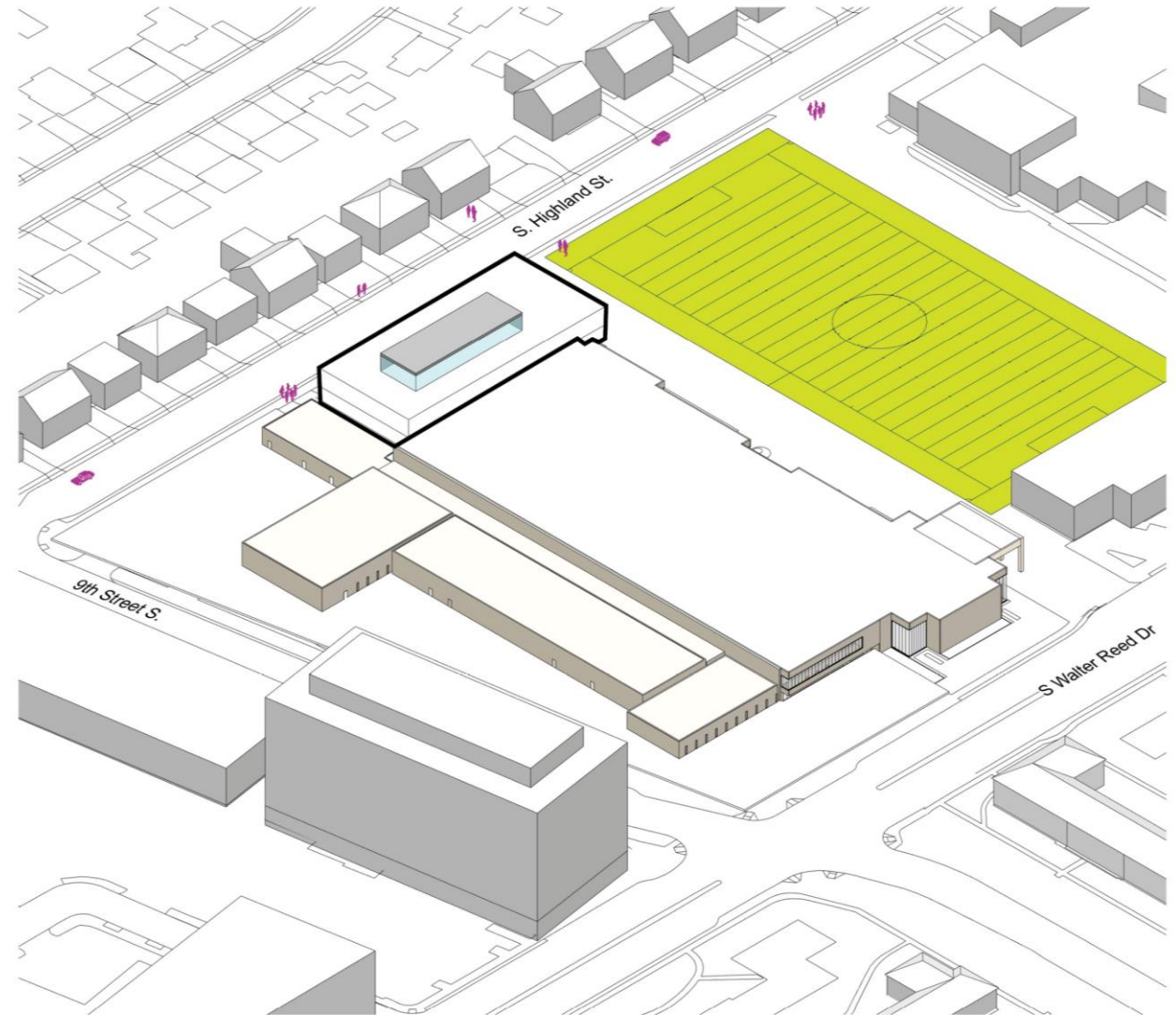
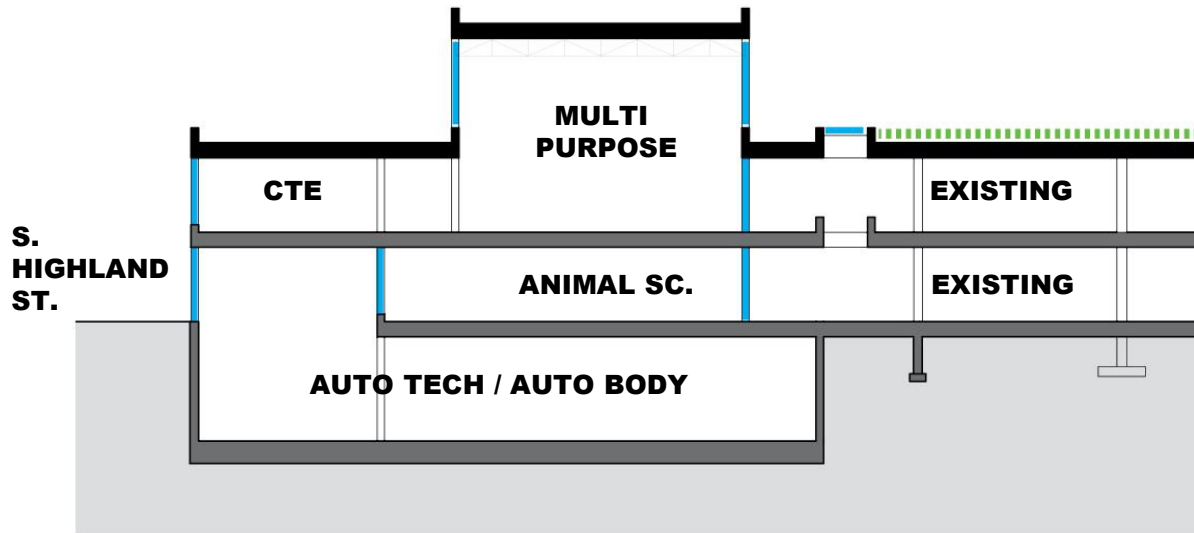

WHAT FOLLOWS PHASE 1?

A: EVERYTHING ELSE!

- Instructionally and spatially integrated, responsive to Ed Specs
- Reflects the ideas and input of the BLPC/PFRC committee and the recommendations of the CCWG
- Well-considered approach to project phasing
- Optimizes future opportunities at the ACC site

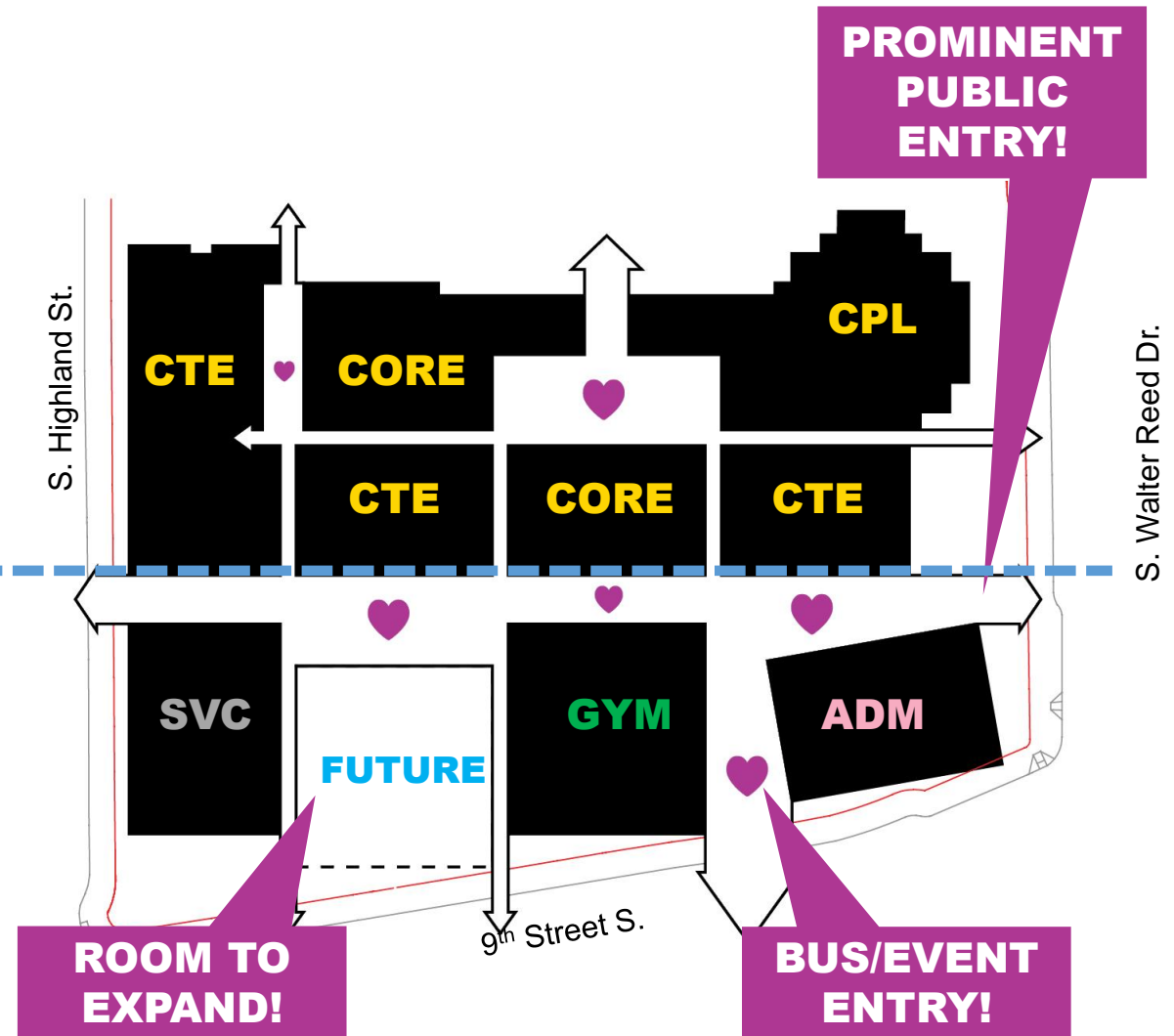

WHAT FOLLOWS PHASE 1?

A: EVERYTHING ELSE!

- Instructionally and spatially integrated, responsive to Ed Specs
- Reflects the ideas and input of the BLPC/PFRC committee and the recommendations of the CCWG
- Well-considered approach to project phasing
- Optimizes future opportunities at the ACC site

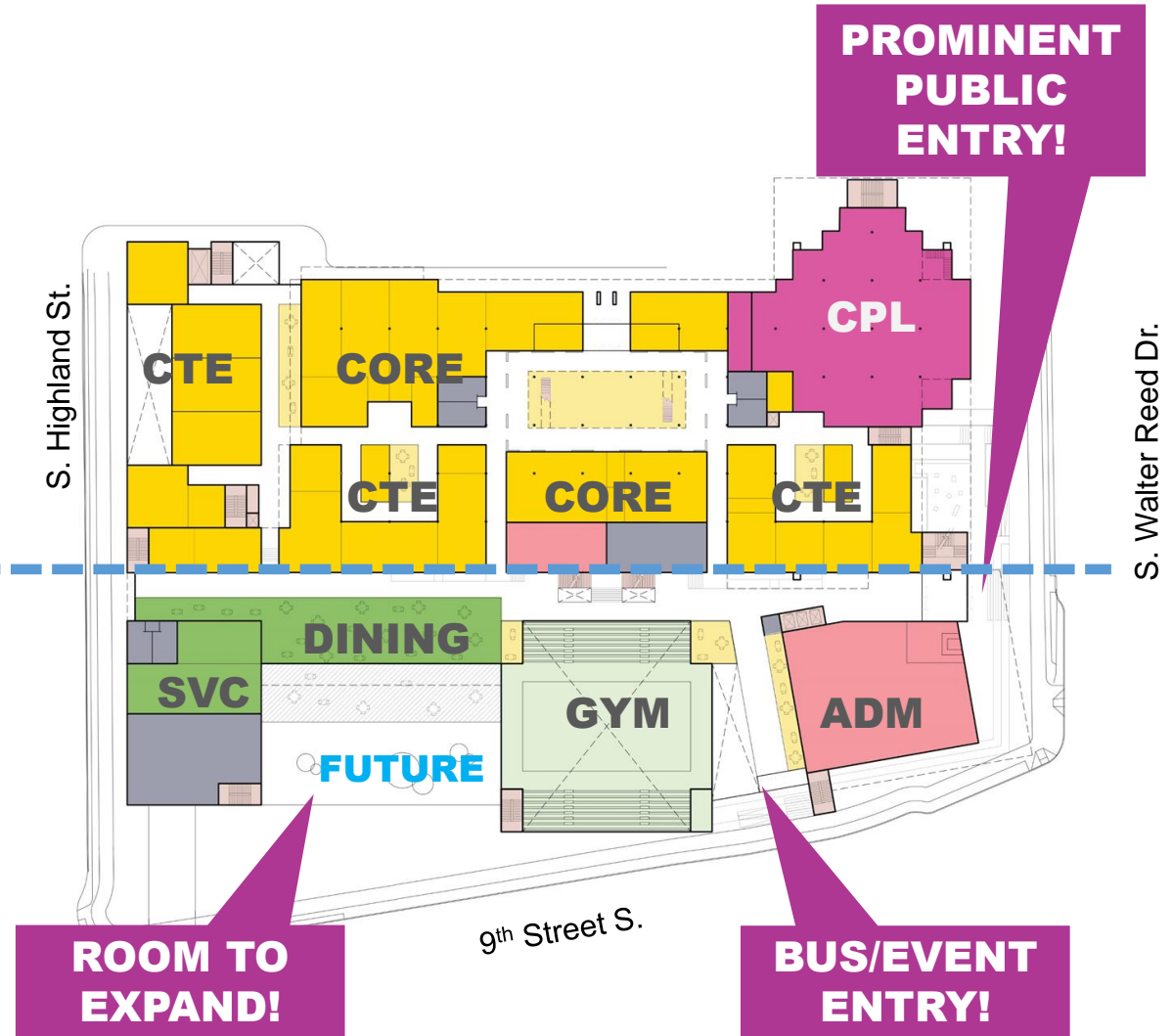

HEIGHT CONSIDERATION AND MASSING

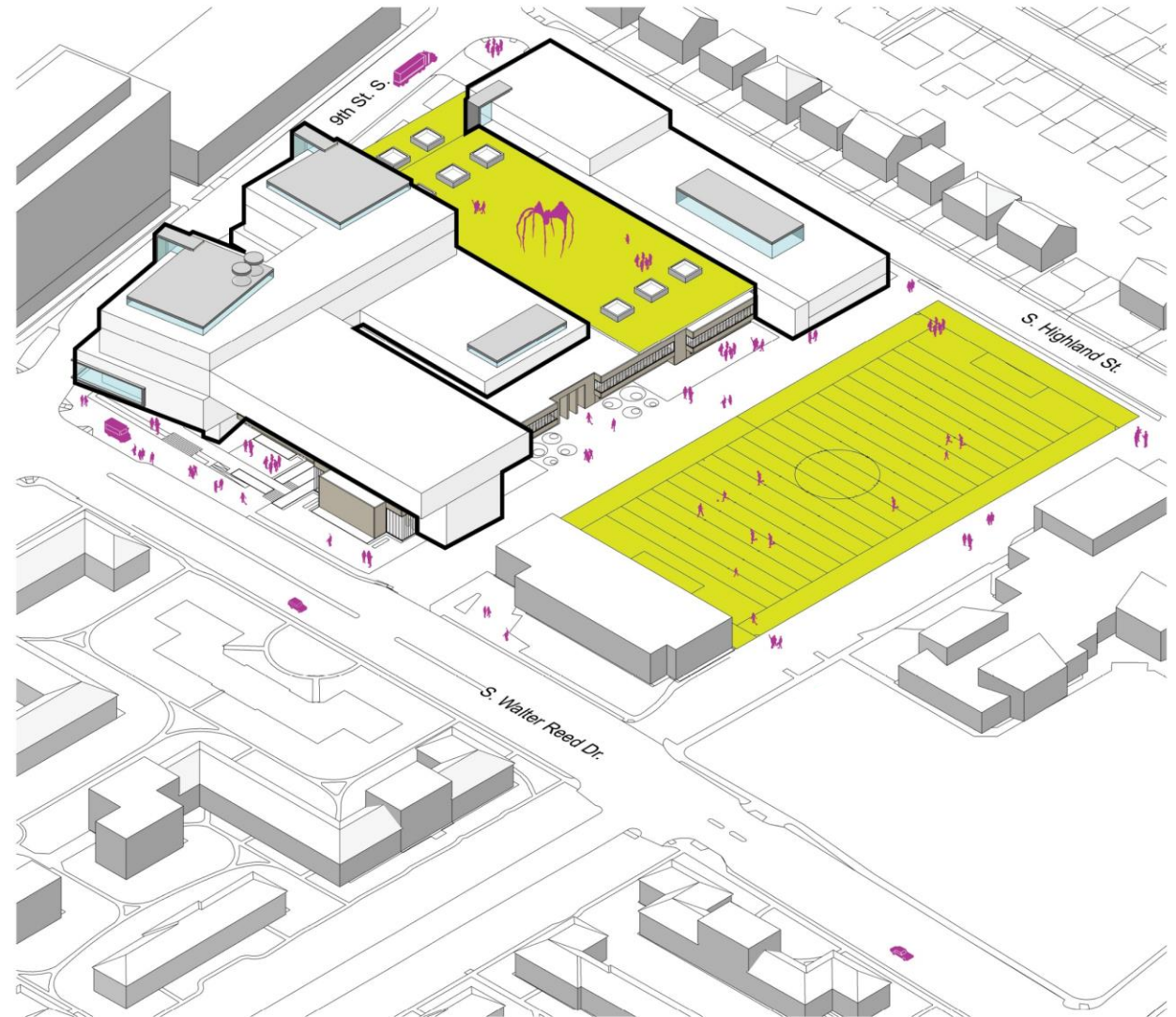
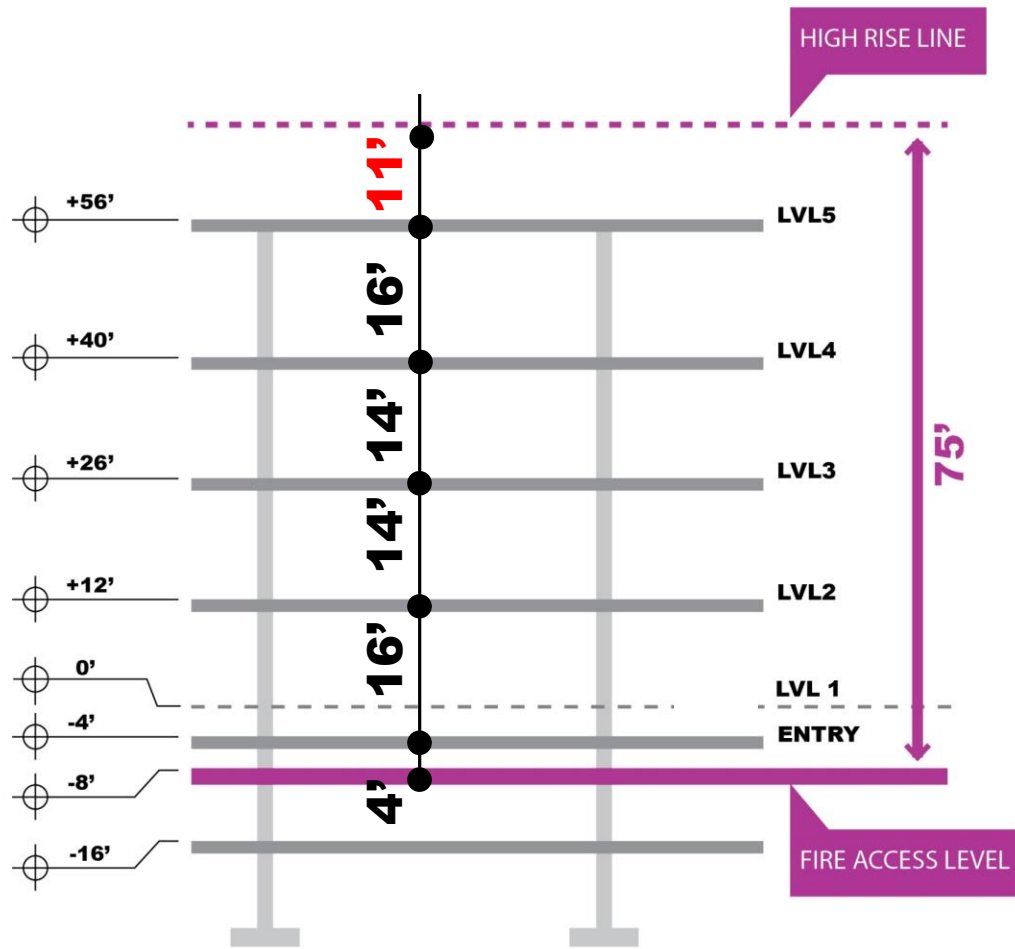

MEET YOUR CONCEPT!



LEVEL 1: (elev. -4' to level w/ exist. 1st floor)

FEATURES:

- Main visitor entrance and bus/event entrance
- Columbia Pike Library
- Main office
- Classrooms and labs
- Student dining
- Kitchen and service



LEVEL 1: (elev. -4' to level w/ exist. 1st floor)

FEATURES:

- Main visitor entrance and bus/event entrance
- Columbia Pike Library
- Main office
- Classrooms and labs
- Student dining
- Kitchen and service
- POOL?

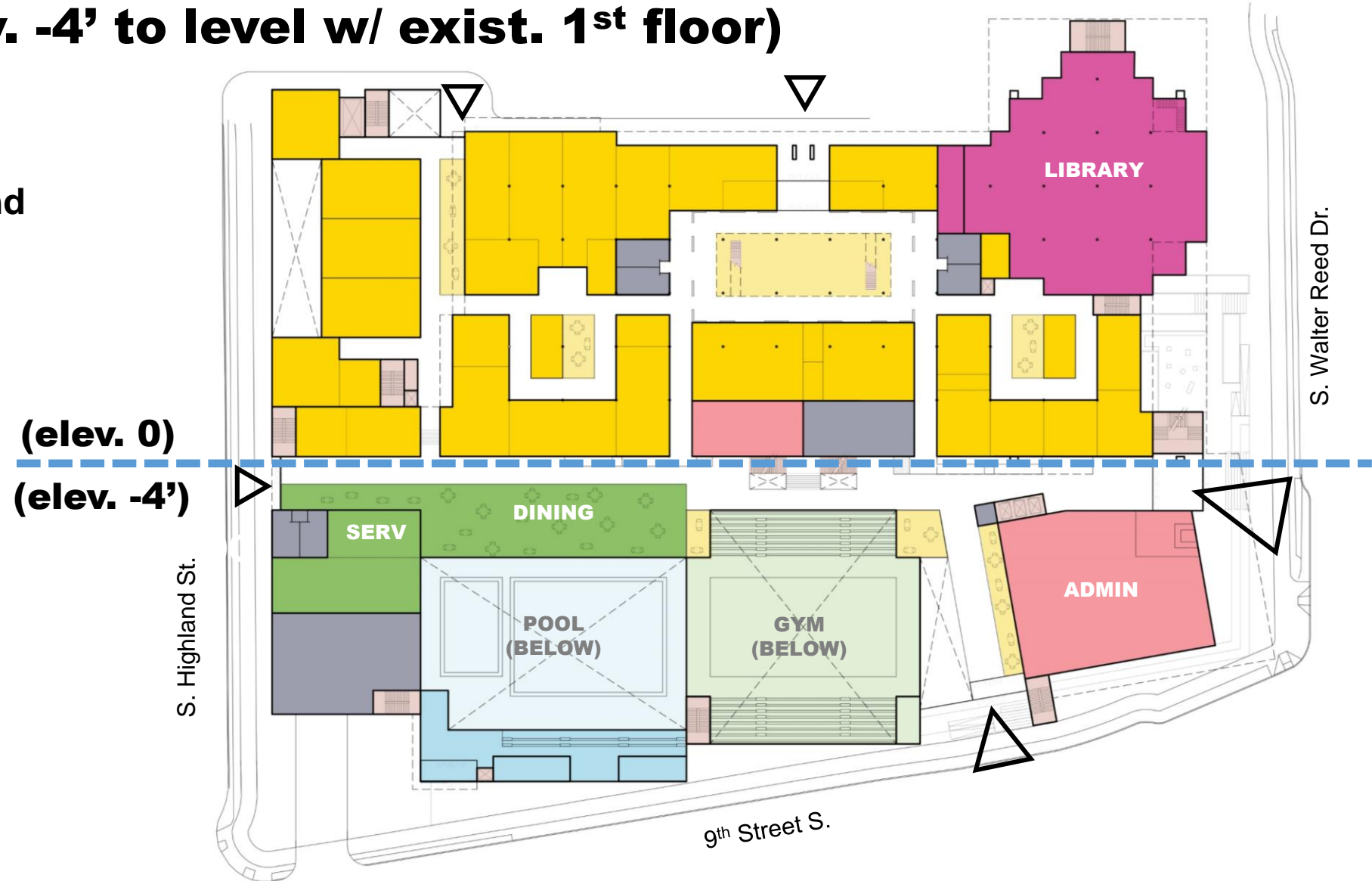

LEVEL B: (elev. -16' below exist. 1st floor)

FEATURES:

- Competition Gymnasium, incl. concessions, toilets, etc.
- Wrestling Room
- Student Locker Rooms
- Auto Tech/Auto Body

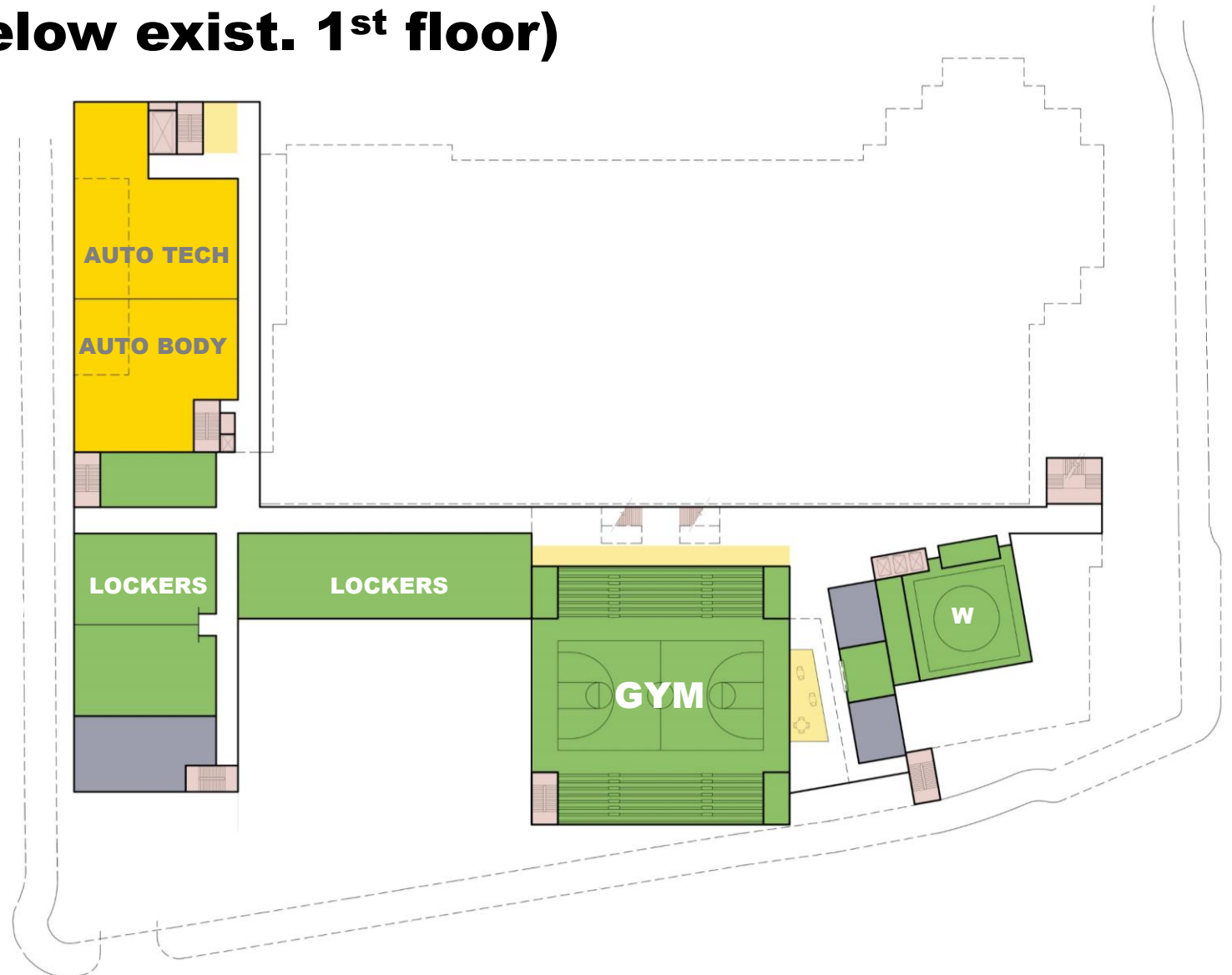

LEVEL B: (elev. -16' below exist. 1st floor)

FEATURES:

- Competition Gymnasium, incl. concessions, toilets, etc.
- Wrestling Room
- Student Locker Rooms
- Auto Tech/Auto Body
- POOL?

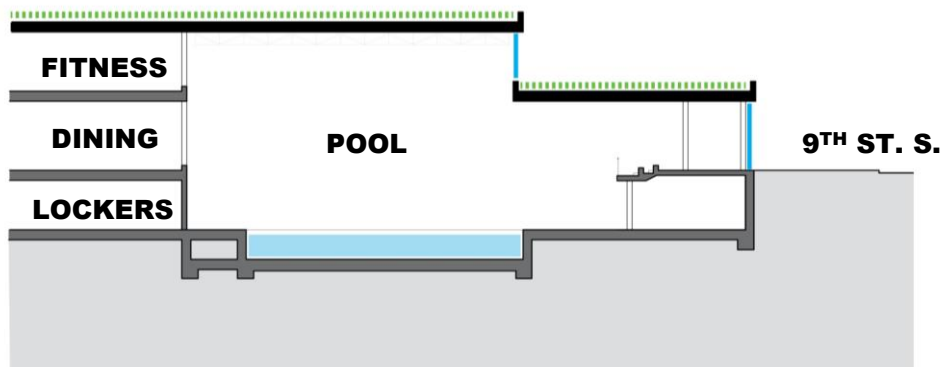

VIEW FROM BUS/EVENT ENTRY

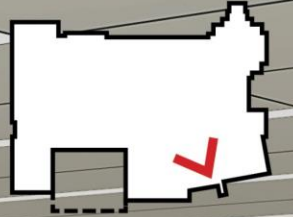

VIEW FROM BUS/EVENT ENTRY

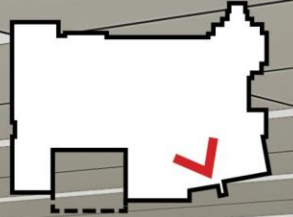

LEVEL 2: (elev. +12' above exist. 1st floor)

FEATURES:

- Auditorium
- Auxiliary Gymnasium
- Fitness area
- Classrooms and labs



LEVEL 3: (elev. +26' above exist. 1st floor)

FEATURES:

- Black Box
- Media Center
- Outdoor courtyard
- Classrooms and labs



LEVEL 3: (elev. +26' above exist. 1st floor)

FEATURES:

- Black Box
- Media Center
- Outdoor courtyard
- Classrooms and labs
- ROOM TO GROW

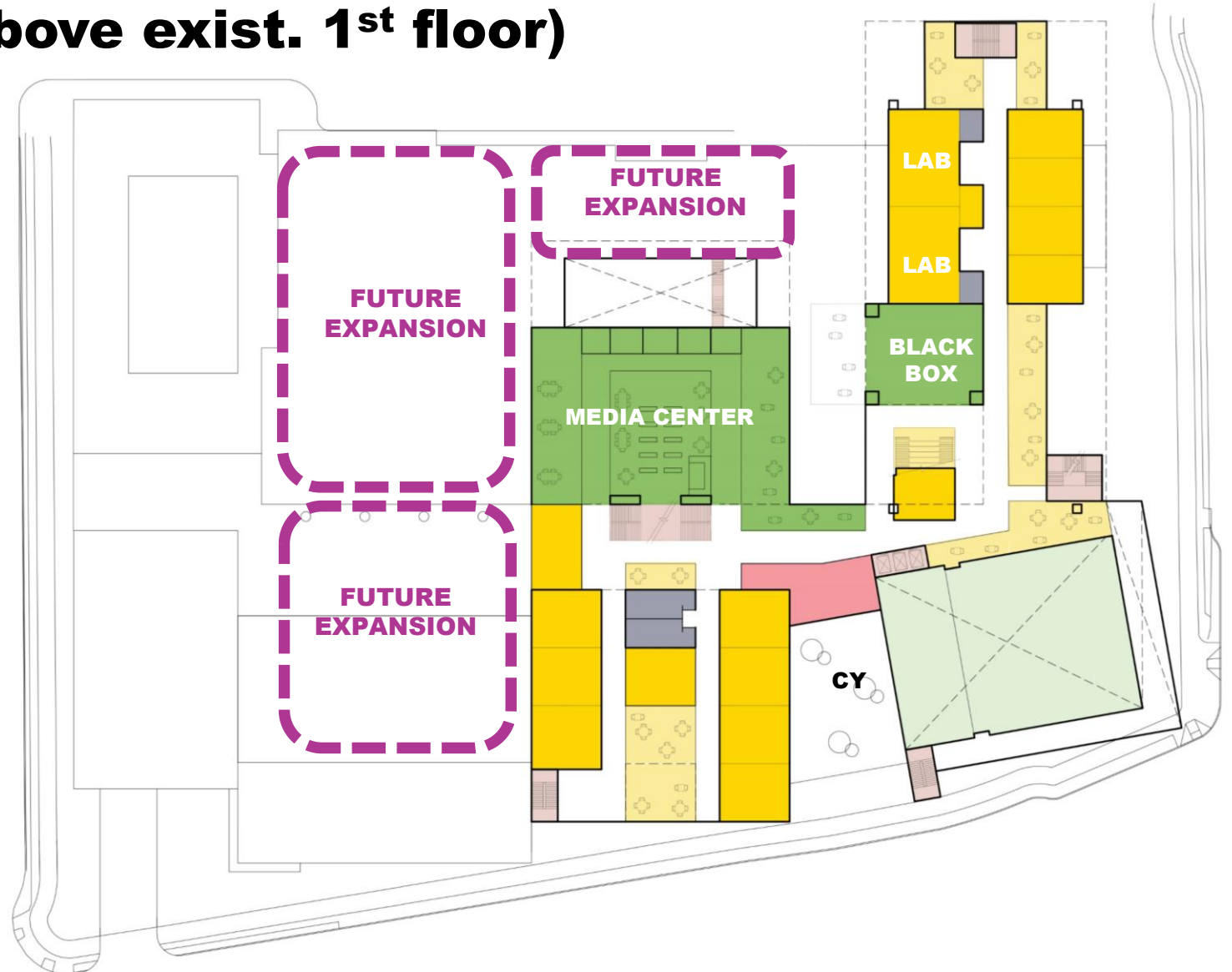

VIEW FROM ATRIUM

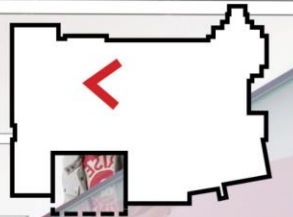

VIEW FROM ATRIUM

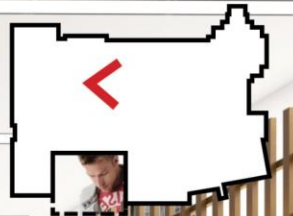

LEVEL 4: (elev. +40' above exist. 1st floor)

FEATURES:

- Learning Stair
- Classrooms and labs



VIEW FROM 4TH FLOOR TO BLACK BOX



VIEW FROM 4TH FLOOR TO BLACK BOX

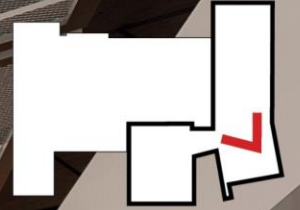

04

LEVEL 5: (elev. +56' above exist. 1st floor)

FEATURES:

- Fine / Performing Arts
- Classrooms and labs



LEVEL 5: (elev. +56' above exist. 1st floor)

FEATURES:

- Fine / Performing Arts
- Classrooms and labs
- ROOM TO GROW



CONCEPT AT-A-GLANCE

ENTRY PLAZA

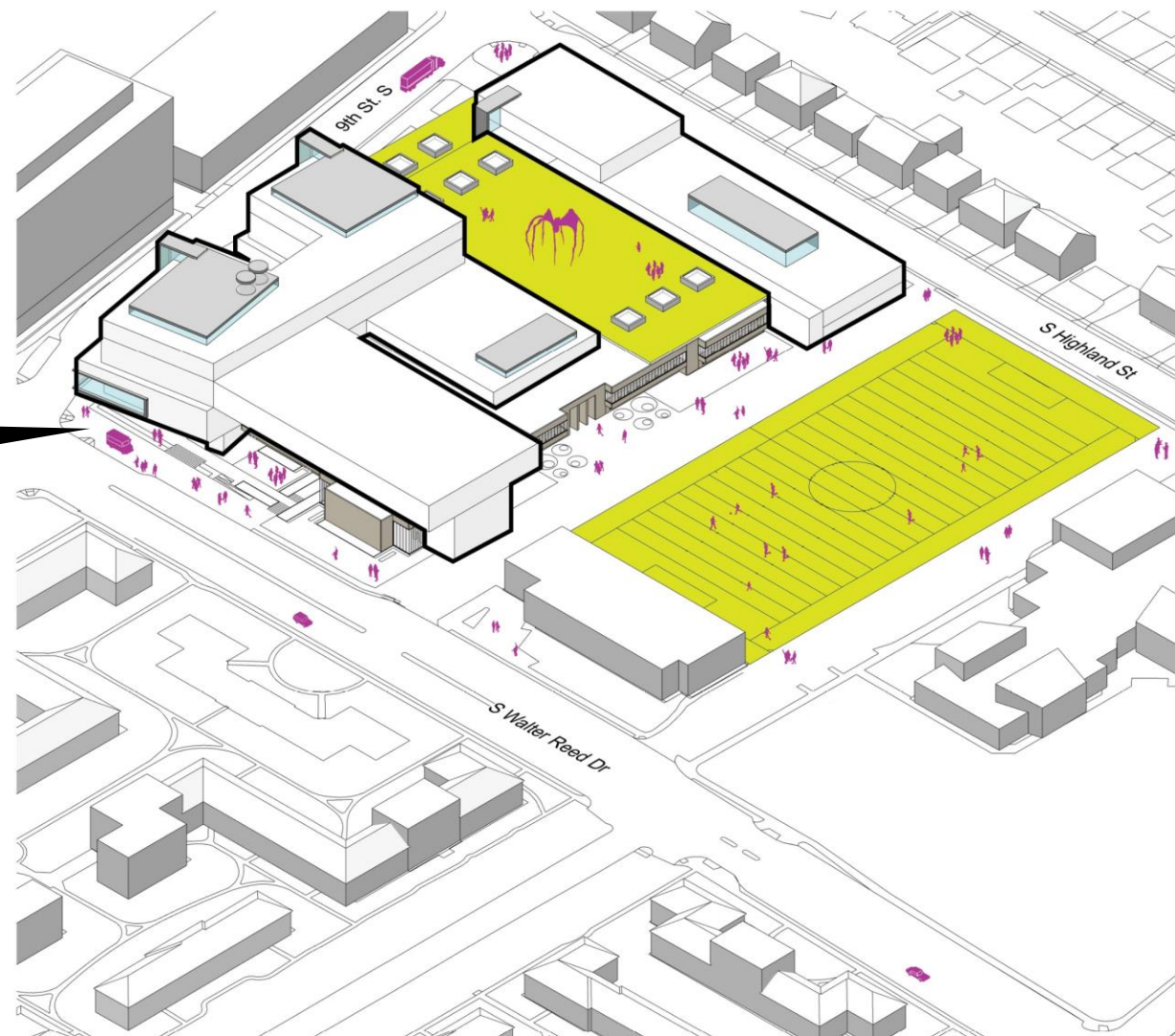

VIEW FROM INTERSECTION AT 9TH ST. AND S. WALTER REED DR.

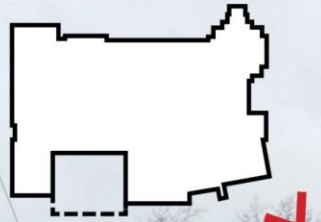

VIEW FROM INTERSECTION AT 9TH ST. AND S. WALTER REED DR.



VIEW ACROSS S. WALTER REED DR.

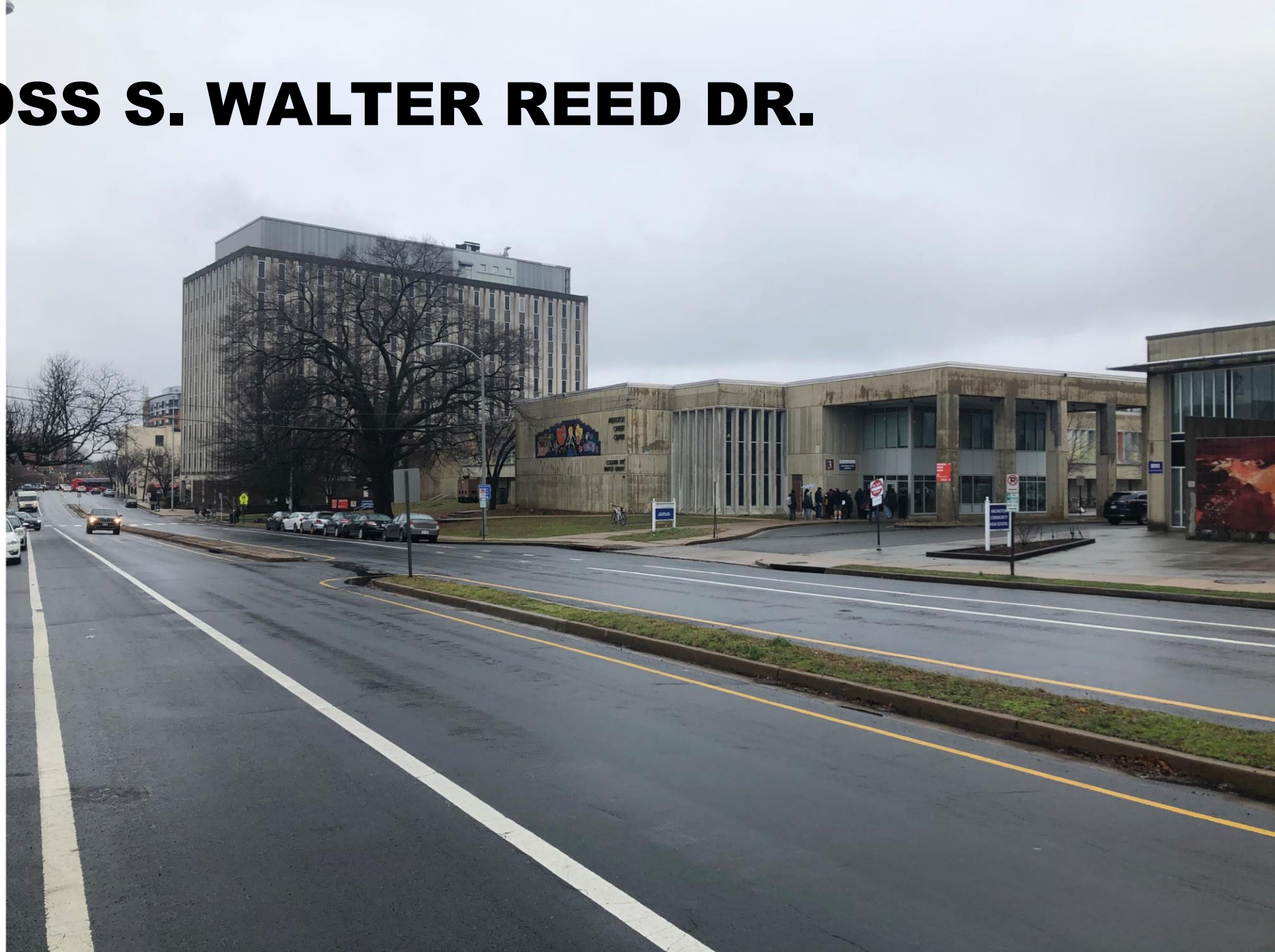
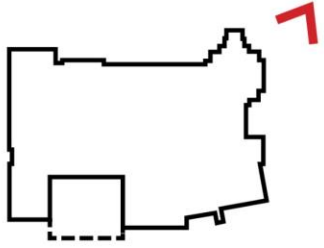

VIEW ACROSS S. WALTER REED DR.

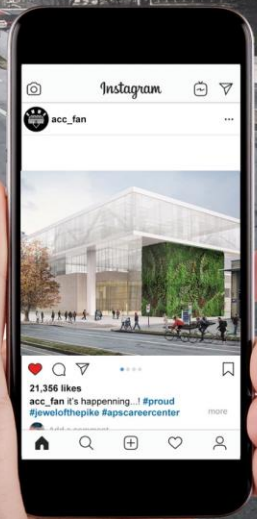
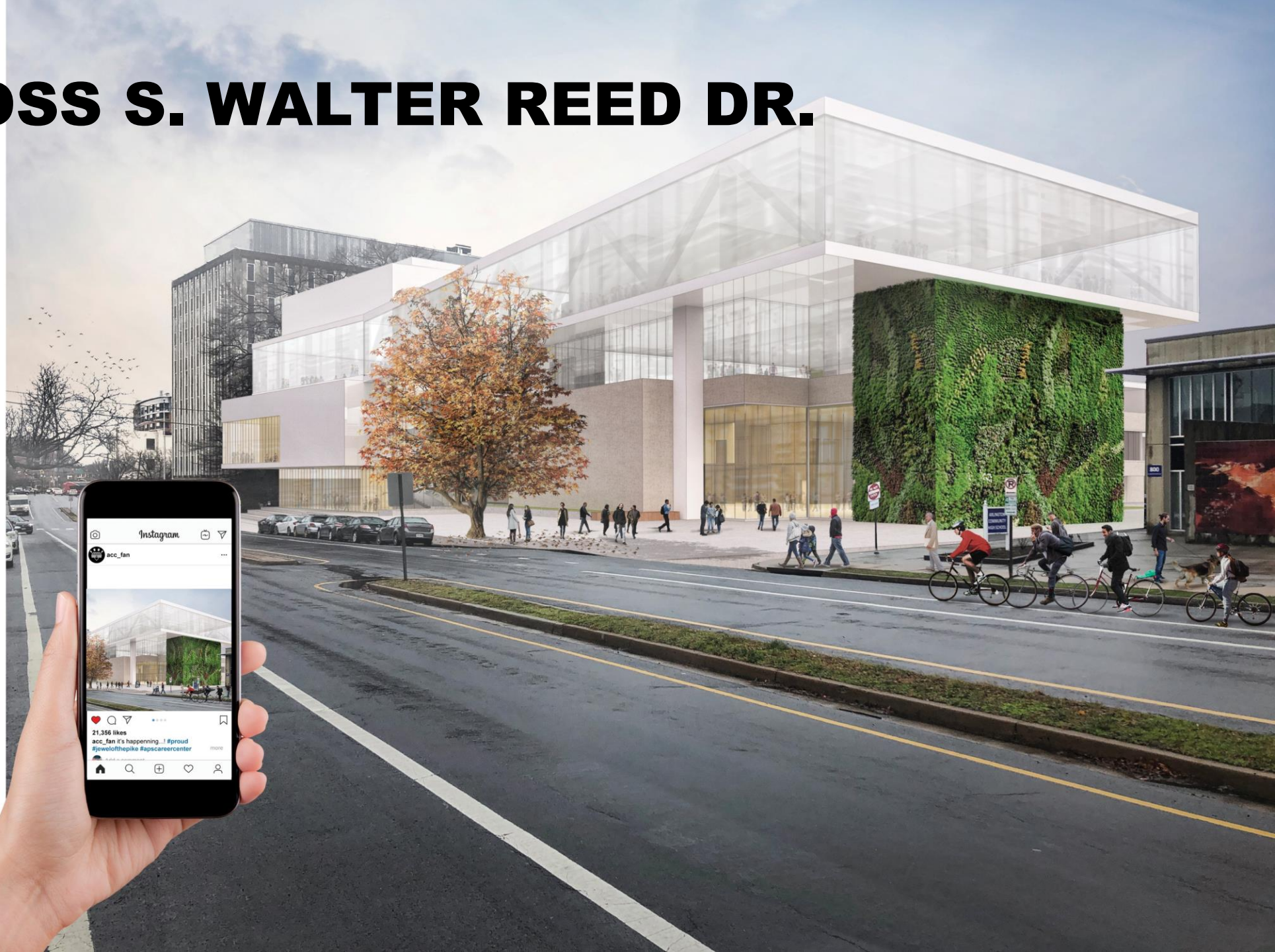
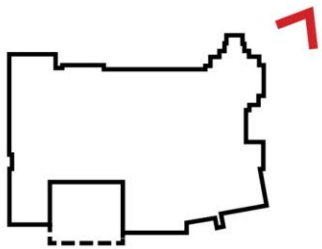

CONCEPT AT-A-GLANCE

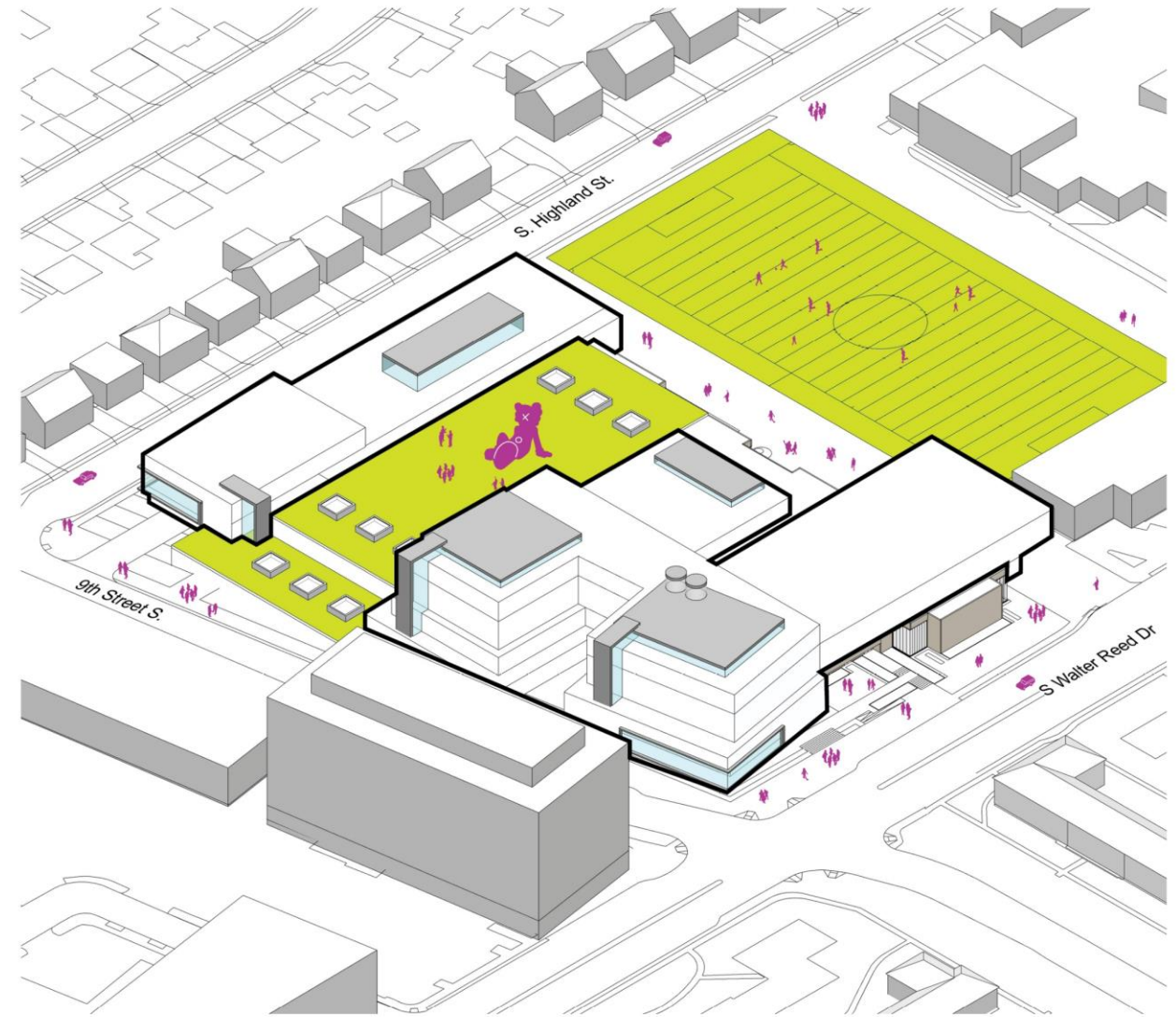

CONCEPT AT-A-GLANCE

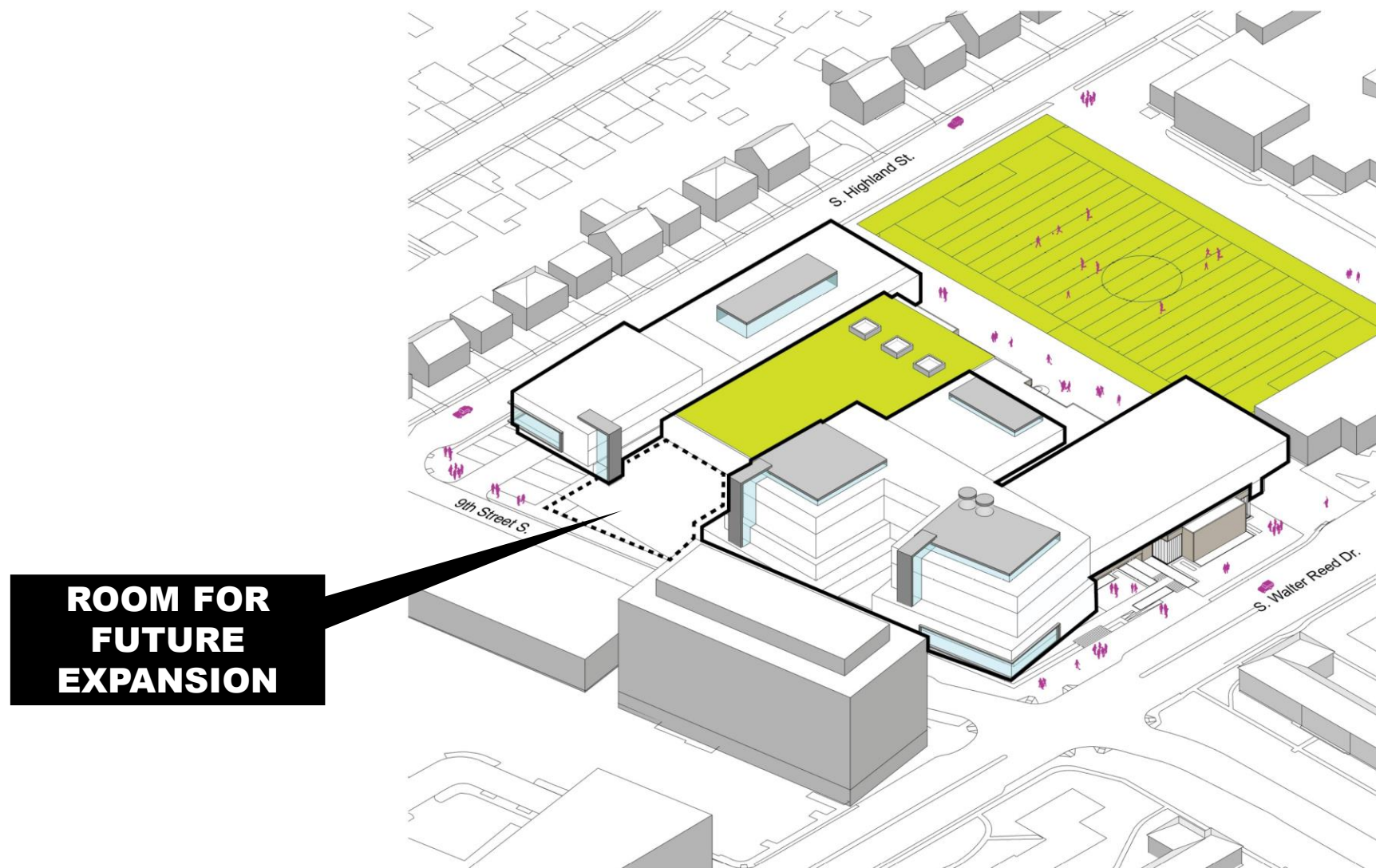

VIEW FROM INTERSECTION AT S. HIGHLAND ST. AND 9TH ST. S.

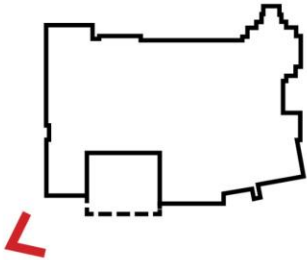

VIEW FROM INTERSECTION AT S. HIGHLAND ST. AND 9TH ST. S.

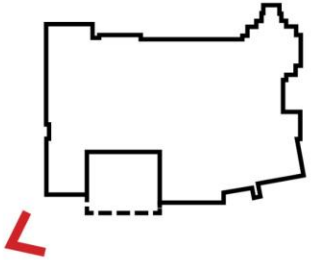

CONCEPT AT-A-GLANCE

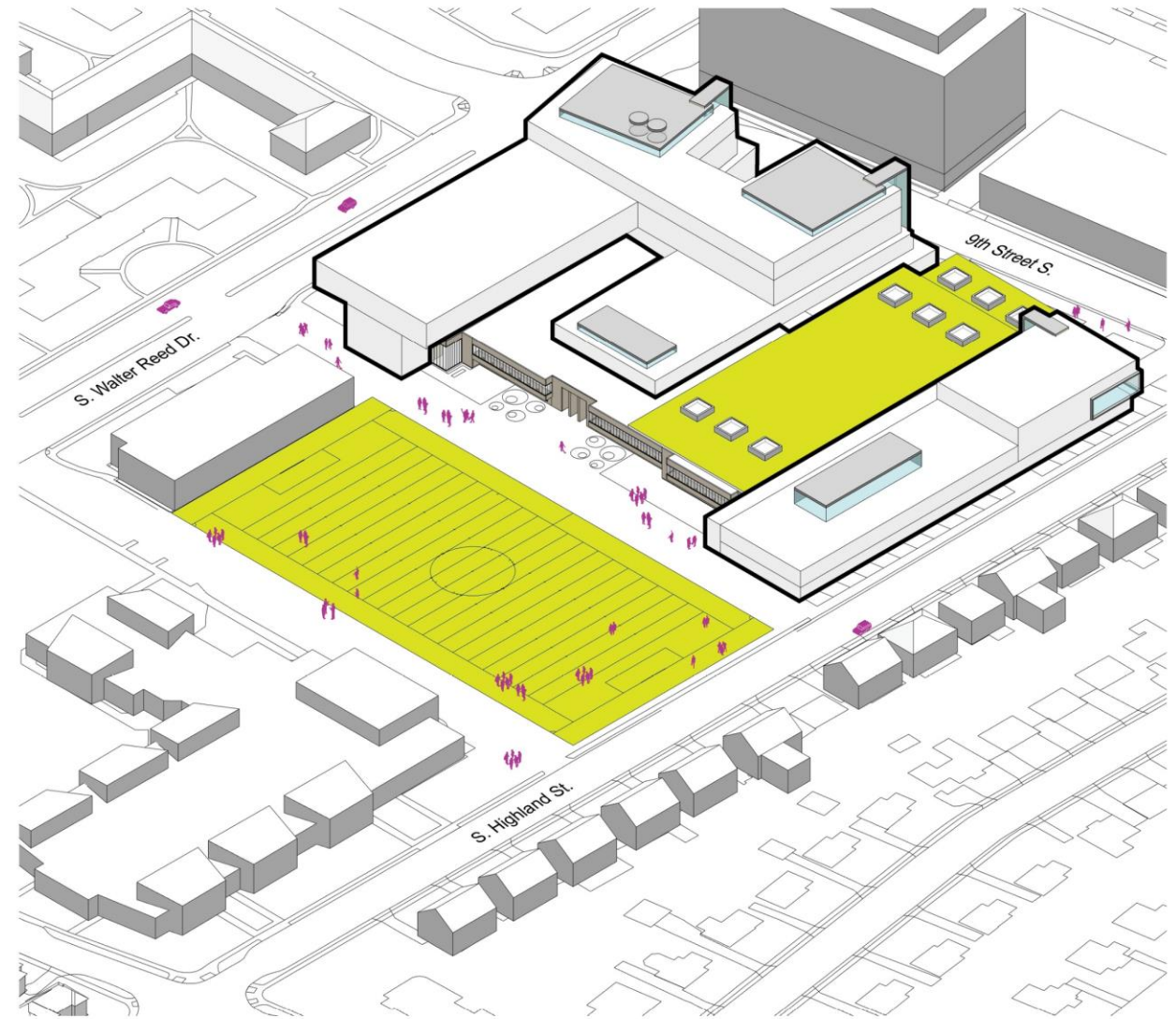

VIEW ACROSS S. HIGHLAND ST.

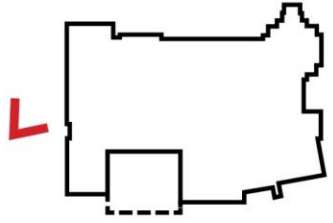

VIEW ACROSS S. HIGHLAND ST.

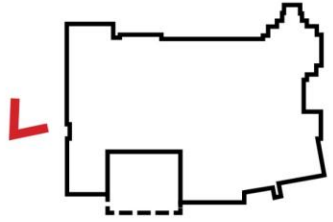

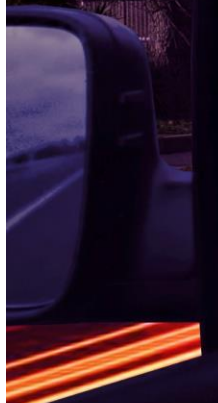

SPEED LIMIT 25

SPEED LIMIT 25

18:21
0.0 l/100km
13.0 °C
32677 372.2

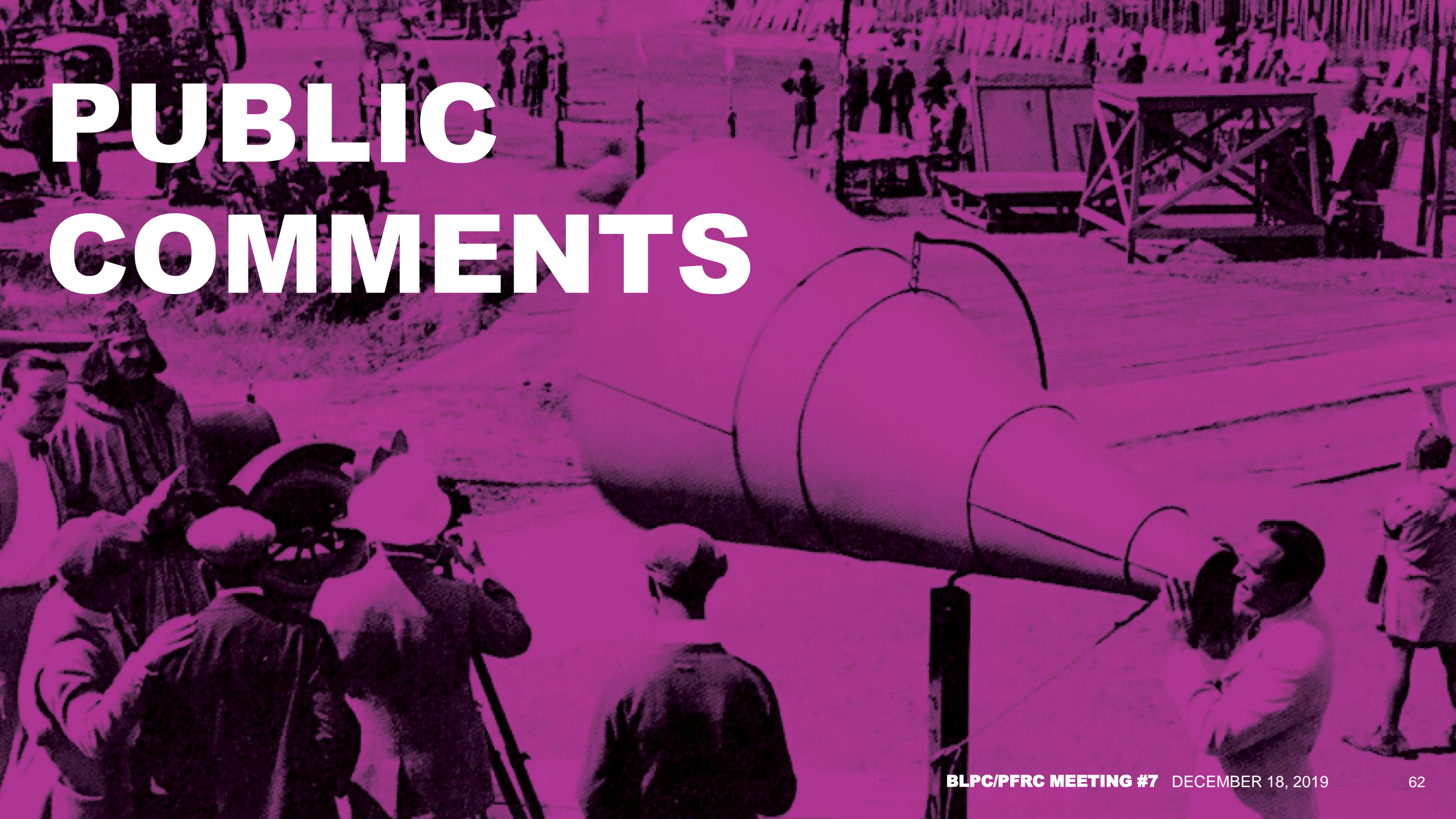

PUBLIC COMMENTS

ADJOURN



ADJOURN

As a reminder the APS Project Manager is:

Steve Stricker

(703) 228-7749

steven.stricker@apsva.us

Public meeting dates and past presentations are posted on the APS project website: <https://www.apsva.us/design-and-construction/arlington-career-center/>

Next meeting: **February 26, 2020 @ 7:00pm**

To provide feedback and/or comments to APS use: engage@apsva.us