

# ACC EXPANSION

**COMMUNITY MEETING**

**JANUARY 22, 2020**



# WELCOME



# AGENDA



# AGENDA

1. Introduction to the BLPC / PFRC Process
2. Highlights:
  - ACC Educational Specifications
  - Parking and Transportation
  - Group Design Exercise
  - Concept Design Drivers
3. Gallery Walk

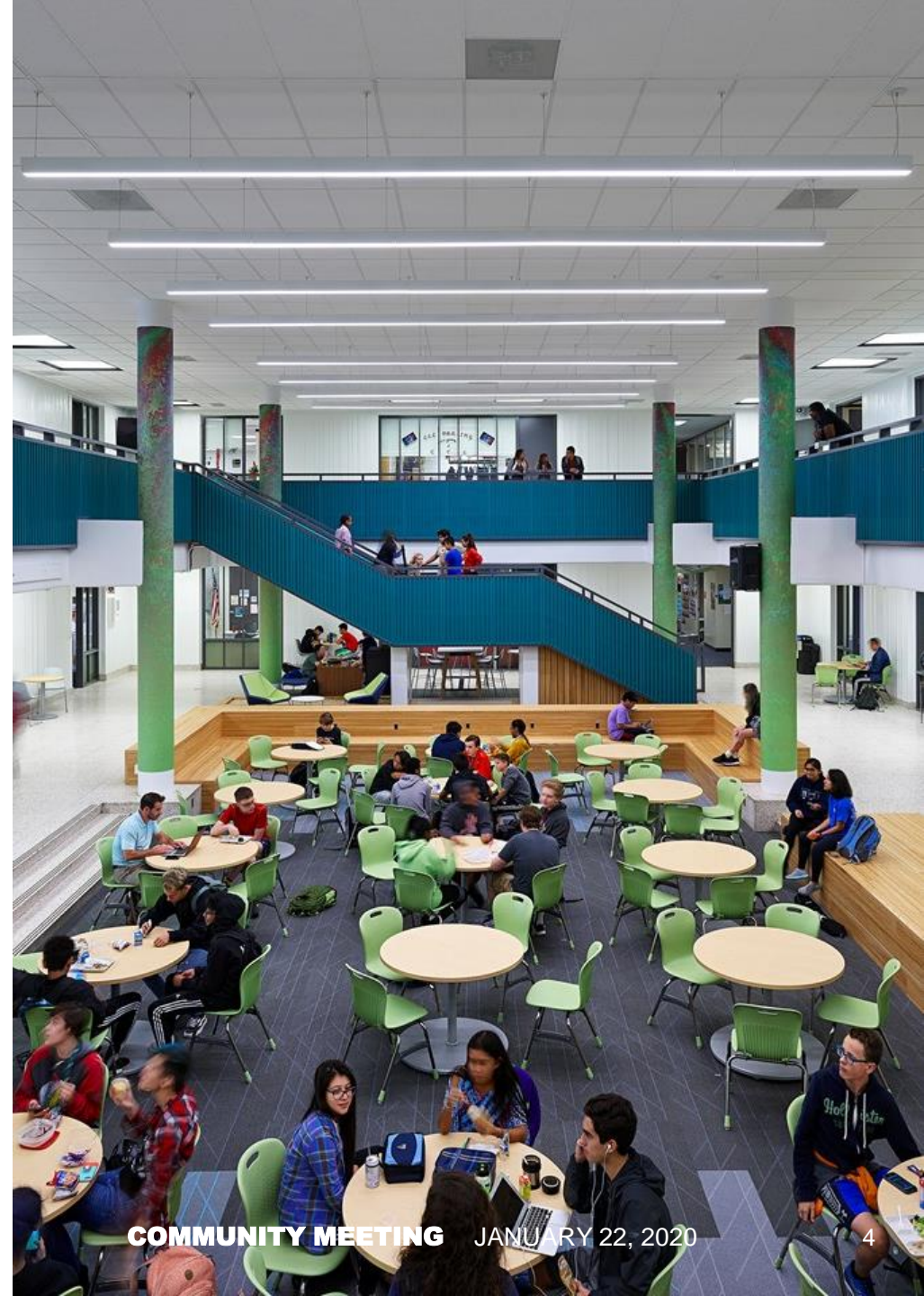

# INTRODUCTION



# CHECK IT OUT!

<https://www.apsva.us/design-and-construction/arlington-career-center/>

## Design and Construction

Design & Construction

Awards and Recognitions

Advisory Council on School Facilities and Capital Programs

Educational and Technical Specifications

Sustainability in School Facilities

Abingdon Addition/Renovations

Alice West Fleet Elementary School

**Arlington Career Center Expansion**

Education Center Reuse

Dorothy Hamm Middle School

New Elementary School at Reed Building

The Heights Building

Archived

Ashlawn Addition

Discovery

McKinley Additions/Renovations

## Arlington Career Center Expansion

[Home](#) / [Design & Construction](#) / [Arlington Career Center Expansion](#)

### About the Career Center Expansion

The [FY 2019-28 Capital Improvement Plan \(CIP\)](#)

contains two Career Center expansion projects:

- Additional 250 Arlington Tech seats for a total of 600 Arlington Tech seats by Sept. 2021
- Creation of 800 new high school seats by Sept. 2025

The concept design phase for the Career Center Expansion is planned to begin in September 2019 including meetings with the Building Level Planning Committee (BLPC)/Public Facility Review Committee (PFRC). The process will include planning for continued growth of the Arlington Tech program. The School Board is scheduled to act on the concept design in March 2020. The concept design will inform development of the FY 2021-30 CIP, with School Board adoption expected in June 2020.

- Building Level Planning Committee (BLPC) [Membership](#)
- BLPC [Charge](#)
- Public Facilities Review Committee (PFRC) [webpage](#)
- Concept Design Phase Meeting [Schedule](#)

### Project Documents

- May 1, 2019 - Camp Casey Research and Historic Context [Report](#)
- September 5, 2018 - Career Center Working Group (CCWG) [webpage](#) and [final report](#)
- July 12, 2018 - Existing Conditions, Transportation Analysis [Report](#)
- June 30, 2017 - School Board Approves Options for High School Seats [news release](#)

### School Board Items

- May 9, 2019 - Career Center Summer Work 2019 [Presentation](#)
- March 14, 2019 - Career Center Update monitoring [Presentation](#)



**Meeting Schedule** \*\*\*All meetings will start at 7pm and be held Arlington Career Center Commons (816 S Walter Reed Dr) unless otherwise notified.\*\*\*

- September 17,

**SCHEDULED MEETINGS ARE SHOWN HERE**

- BLPC/PFRC
- October 29, 2019 - BLPC/PFRC
- November 20, 2019 - BLPC/PFRC
- December 3, 2019 - BLPC/PFRC
- December 18, 2019 - BLPC/PFRC
- January 15, 2020 - BLPC/PFRC
- January 22, 2020 - Community Meeting
- February 19, 2020 - BLPC/PFRC
- February 26,

**RECENT PRESENTATIONS TO SCHOOL BOARD**

\$\$\$ HOW MUCH, BY WHEN, FOR WHAT?

ROSTER, RESPONSIBILITIES, PARTICIPANTS AND PROCESS

(VERY) RELEVANT BACKGROUND INFORMATION

**COMMUNITY MEETING** JANUARY 22, 2020

# PROJECT OVERVIEW

800+ additional seats for ACC option programs

Expansion of Arlington Tech to 600 seats  
(As soon as possible)

High School-sized gym/assembly space

Performing Arts Center, Comprising Theater, Black Box Theater and Music classrooms

Cafeteria/  
Multi-use space

Multi-use outdoor synthetic turf field with bleachers

450 to 500 space parking garage below grade, or other parking scenarios

(to be developed in collaboration with Arlington County staff)



**BLPC CHARGE**  
ARLINGTON CAREER CENTER

Columbia Pike Library to remain in place

(unless or until a suitable new location is found)

Replacement, enhancement and/or expansion of all special facilities for existing Career Technical Education (CTE) programs that are demolished or altered as part of the project

Future phases of expansion to allow as many different options as possible for phasing, instructional programs and outdoor athletic facilities, including possible neighborhood High School seats

(as and when needed in the future)

# MEET YOUR TEAM

## BLPC / PFRC



**Ted Black** BLPC Chair

**Barbara Kanninen** School Board Liaison



**Jim Lantelme** PFRC Chair

**Katie Cristol** County Board Liaison

## STANTEC



**Derk Jeffrey**

**Francisco Waltersdorfer**

**Camilo Bearman**

**Haidi Liu**

## STAFF



**John Chadwick**

**Jeff Chambers**

**Ben Burgin**

**Steve Stricker**



**Brett Wallace** PFRC Coordinator

## DESIGN TEAM



**Robert B. Schiesel**

## CONSTRUCTION MANAGER



**Tyler Swartzwelder**



# THE JOURNEY WE'VE TAKEN

Meeting No. 1: BLPC/PFRC Charge, Urban Design, CIP ✓

Meeting No. 2: CCWG, Transportation Study ✓

Meeting No. 3: Ed Specs, ACC Programs ✓

Meeting No. 4: Design Exercise ✓

Meeting No. 5: Bus and Parent Pick Up / Drop Off ✓

Meeting No. 6: Parking ✓

Meeting No. 7: Auto Tech/Collision, Community  
Programs, Service ✓

Meeting No. 8: Concept Design Review ✓

*How do you eat an*  
ELEPHANT?

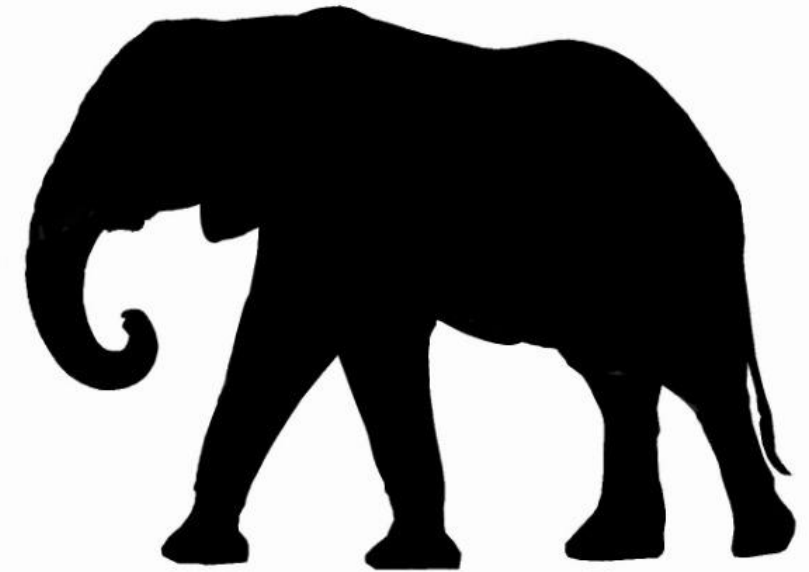

One bite at a time...

# HIGHLIGHTS: EDUCATIONAL SPECIFICATIONS

Arlington Career Center Expansion **DRAFT**  
 Space Program  
 9.24.19  
 Capacity: 1,000 (Academics) / 800 (High School Option Seats) + 400 (Arlington Tech, 200 CTE-only, 70 HLT, 60 Academic Academy, 70 PEP)  
 Student/Teacher Ratio: Arlington Tech: 20:1 (24:1 @ science lab), CTE: 20:1, HLT/Academic Academy 15:1, PEP/Special Ed 10:1  
 Utilization: 85%  
 Total Teaching Stations: 123 (119 CTE: 44, Arlington Tech: 57, Academy/HLT: 10, PEP: 8) + 5 (Visual/Perf. Arts) + 1 (Fitness)

PROGRAM AREA DESCRIPTION	NSF / Space	CTE	Art. Tech	Acad. / HLT	PEP	Total Spaces	NSF Ext'd	TS	NOTES
<b>ACADEMIC / TECHNICAL</b>									
<b>Core Instruction</b>									
Classroom	700		38	8		44	30,800	44	
Universal Lab (Science)	1,400		12	2		14	19,600	14	
Prep Room	400		6	1		7	2,800		
Chemical Stg	100		1			1	100		
<b>Subtotal</b>							<b>53,300</b>	<b>58</b>	
<b>Special Education</b>									
Special Needs Classroom	700		4		8	12	8,400		
Life Skills Lab	1,000				1	1	1,000		
Toilet / Changing	100				1	1	100		
Storage	200				1	1	100		

# ED SPECS FOR THE ACC EXPANSION

1. Developed through a series of collaborative meetings with representatives from Department of Teaching and Learning, Arlington Career Center and Facilities and Operations
2. Reflect APS and ACC pedagogy
3. Are adaptable to future instructional changes

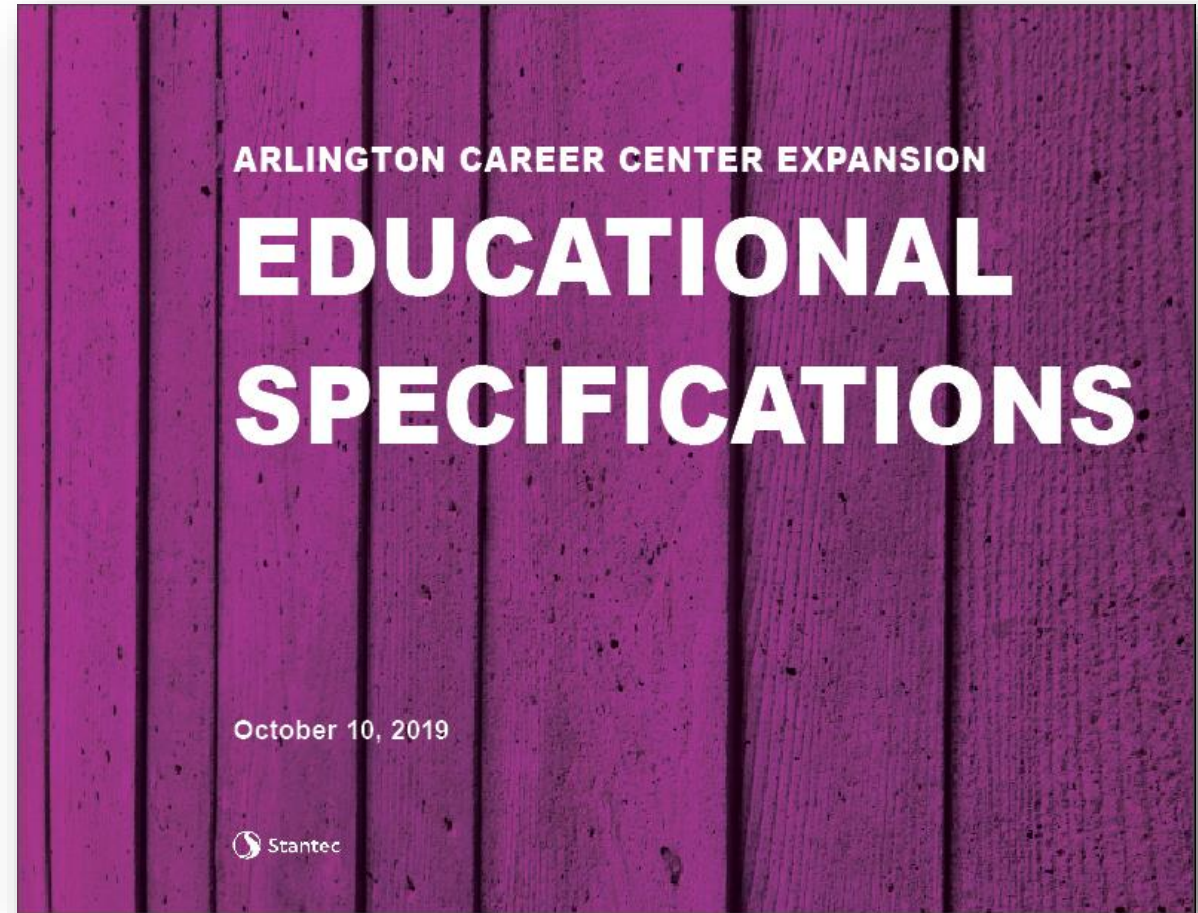

# FRAMEWORK FOR EXPANSION

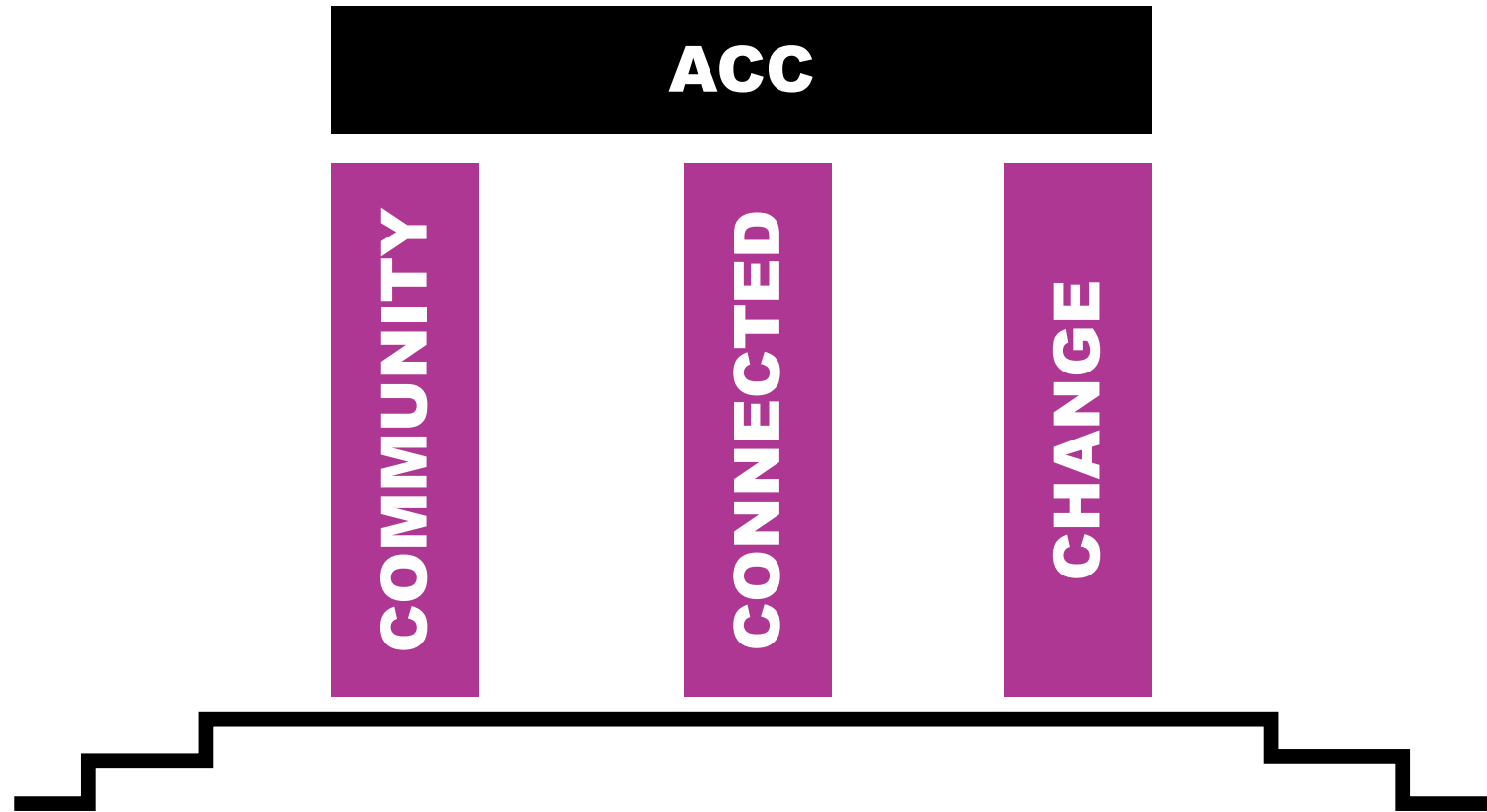

# SPACE PROGRAM AT-A-GLANCE

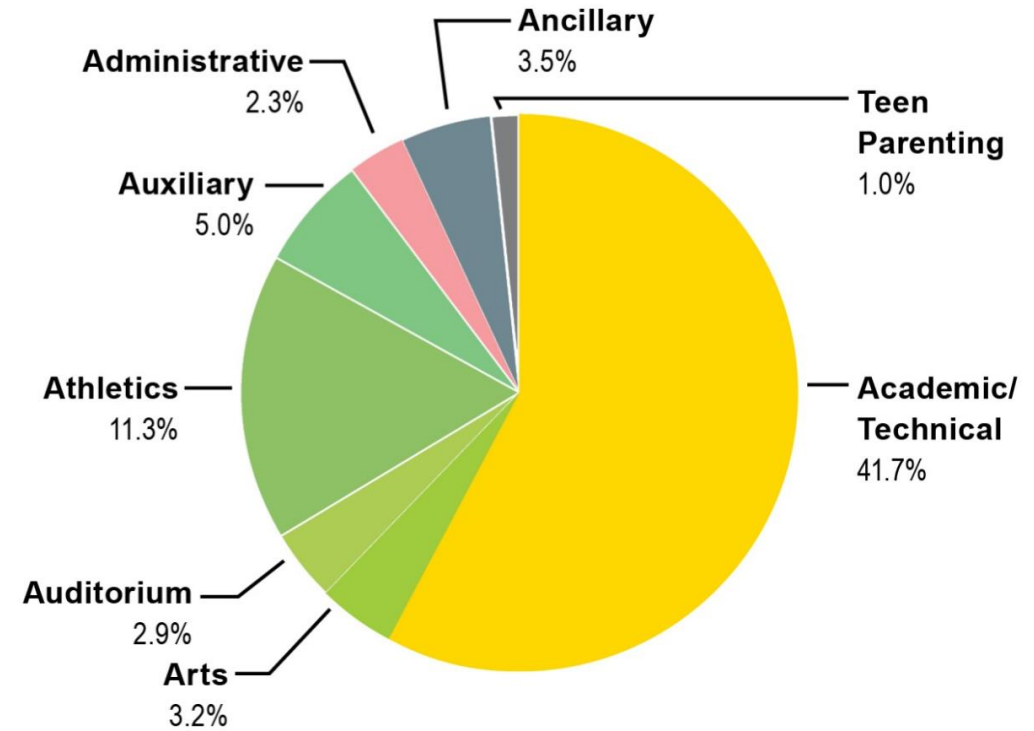
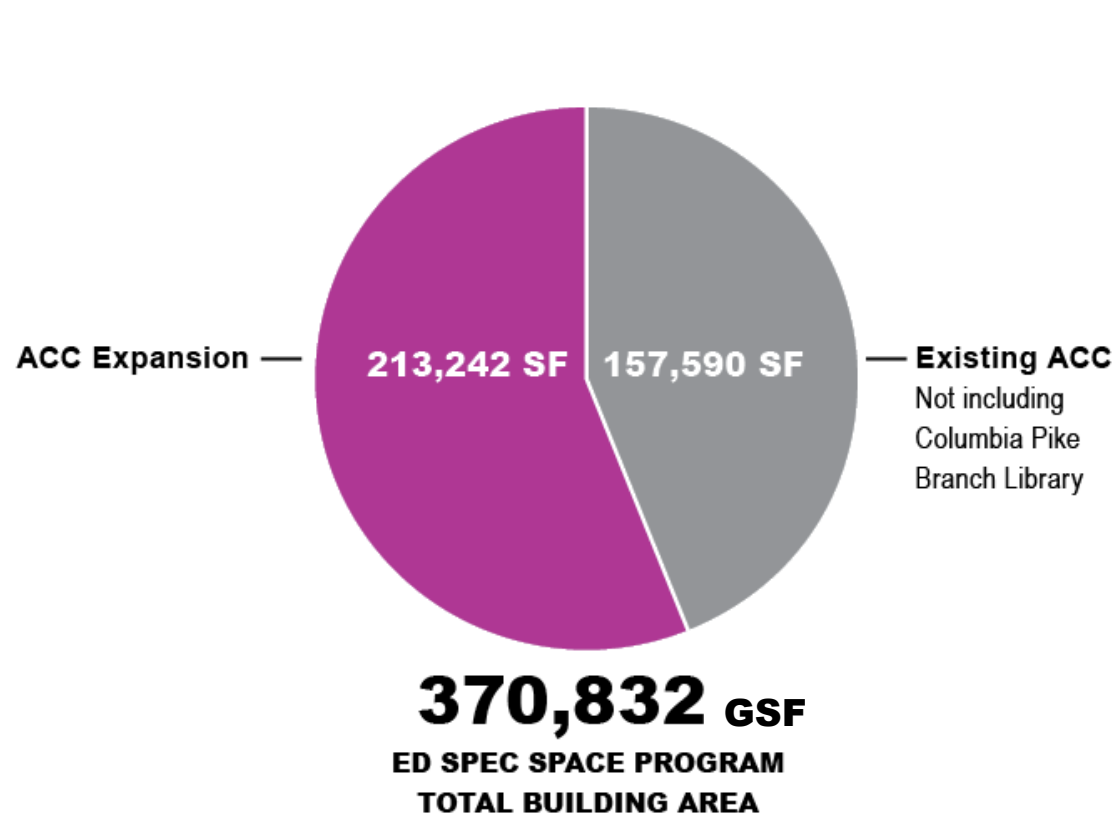

Note: GSF – Gross Square Footage



# HIGHLIGHTS: PARKING AND TRANSPORTATION

# Transportation Goals

1. Provide and promote multi-modal options to help reduce the amount of driving to the Career Center
2. Create a safe campus for all modes of travel
3. Minimize traffic impact generated by the Career Center
4. Minimize parking costs of project
5. Minimize on-street parking conflicts
6. Provide efficient and convenient transportation options for APS families and staff
7. Minimize space dedicated to transportation on CC campus

# **CHARGE: PARKING**

**Develop options and estimated costs for various options for on-site parking during the Concept Design phase, including:**

- 1. No structured parking and accessible parking spaces only provided on site**
- 2. A one-level 225 to 250-space, below-grade parking structure**
- 3. A two-level 450 to 500-space, below-grade parking structure**
- 4. Other parking solutions that may emerge during Concept Design**

**Next steps:**

- 1. BLPC/PFRC recommends the preferred parking option(s) to the School Board**
- 2. The School Board will approve a parking solution when it approves the Concept Design, to ultimately be approved by the County**



# PARKING SUMMARY

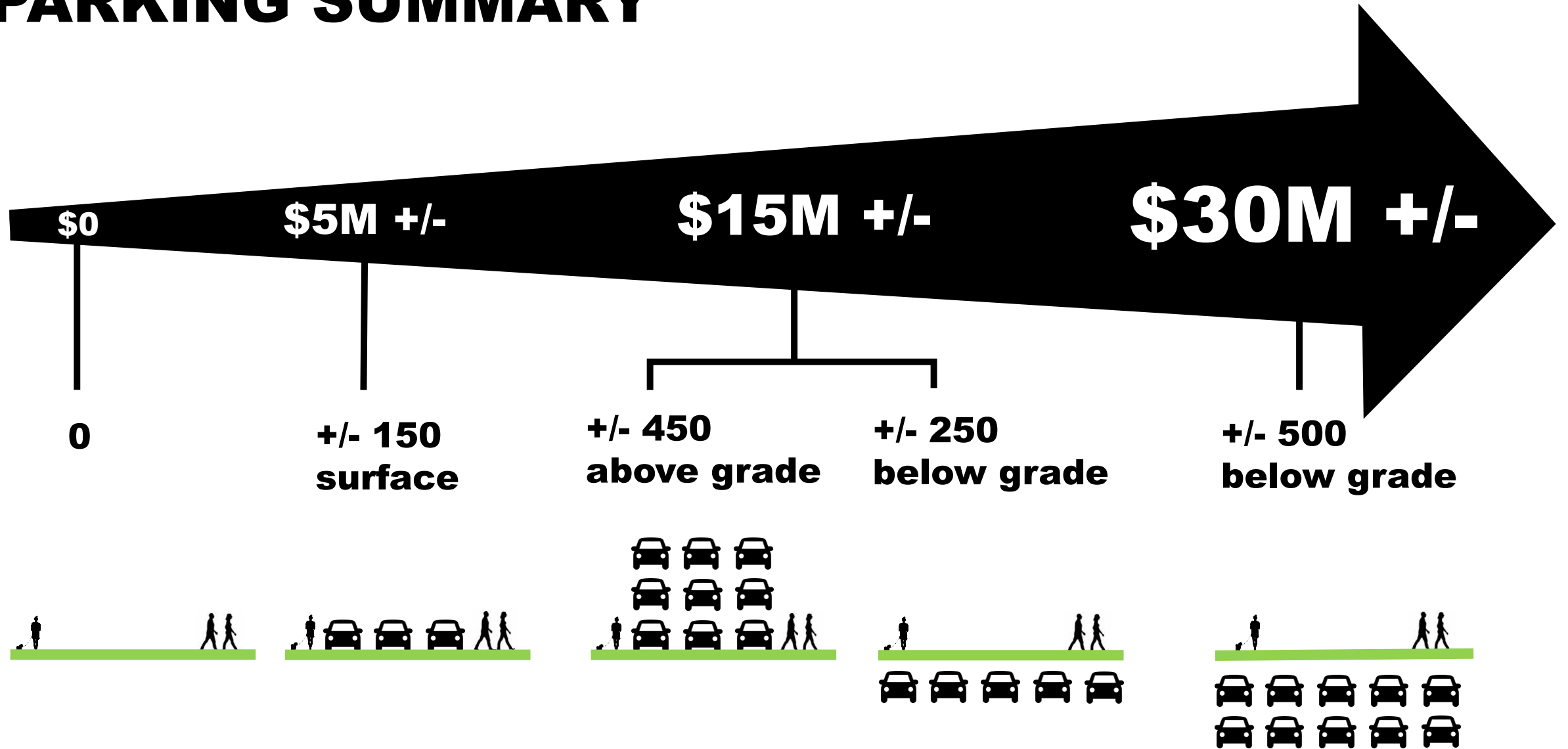

# BUS DROP-OFF OPTIONS

## Opt 1

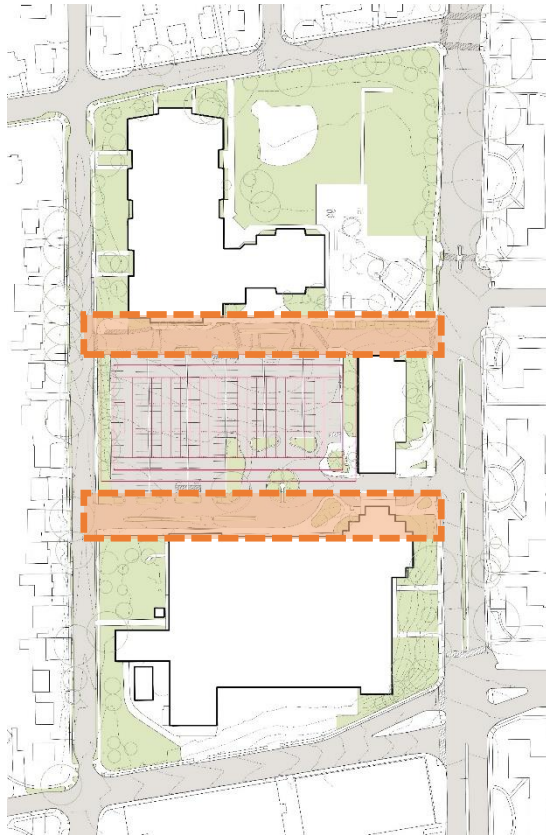

**Buses: on-site, split**

## Opt 2

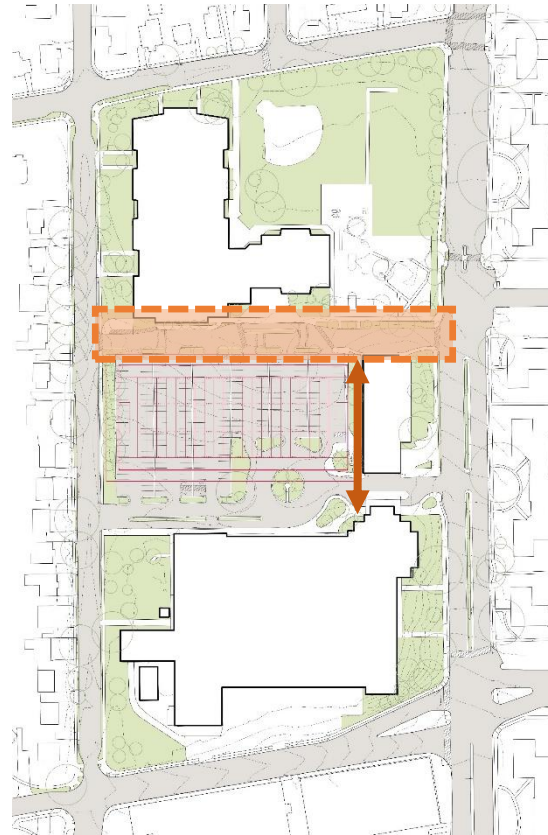

**Buses: on-site, shared**

## Opt 3

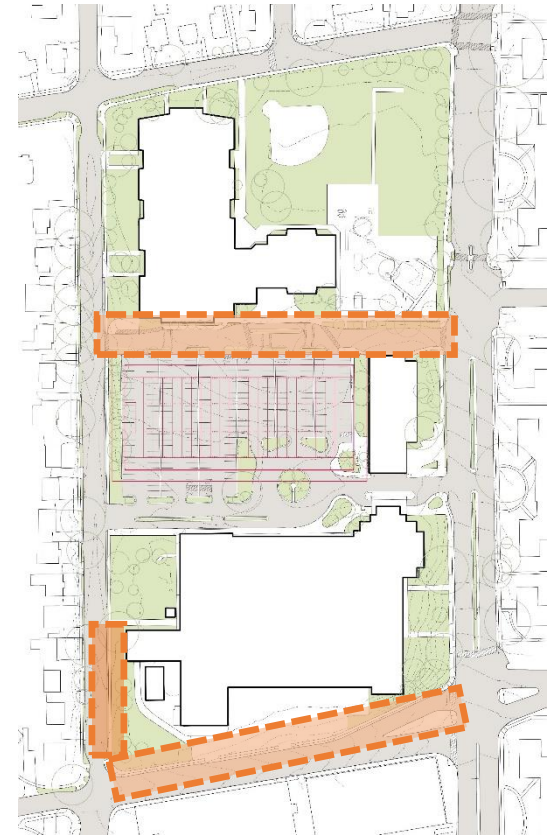

**Buses: Curbside**

# LEAST POPULAR

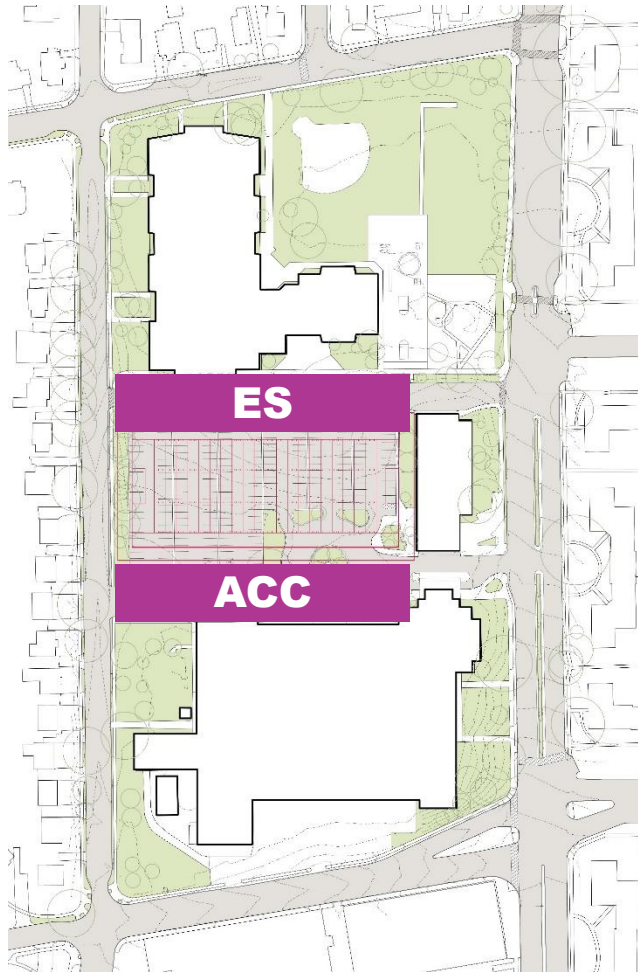

# MOST POPULAR

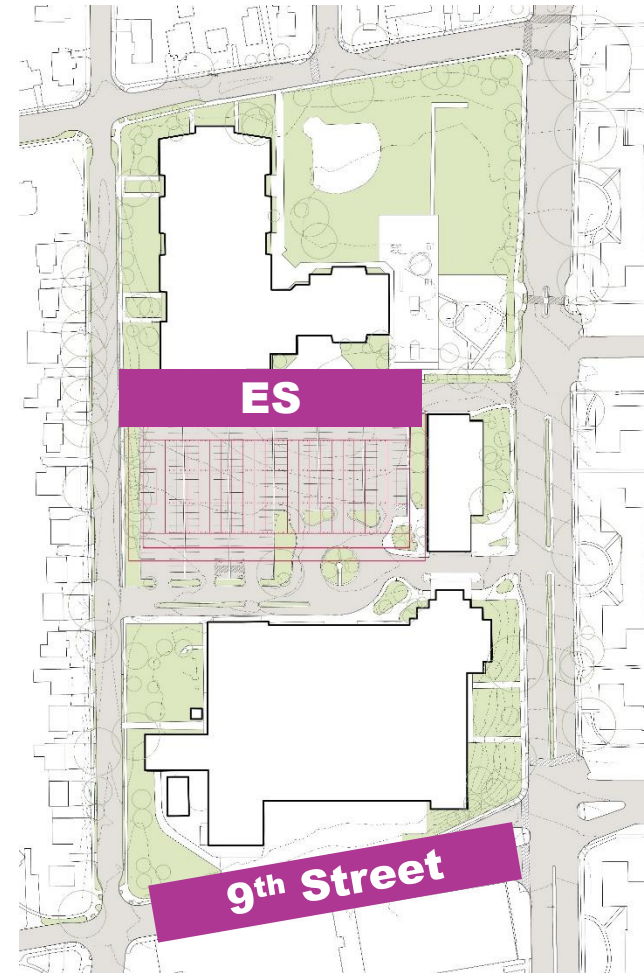

# PU/DO OPTIONS

## Opt 1



**PU/DO:**  
Option 1, 9th St

## Opt 2

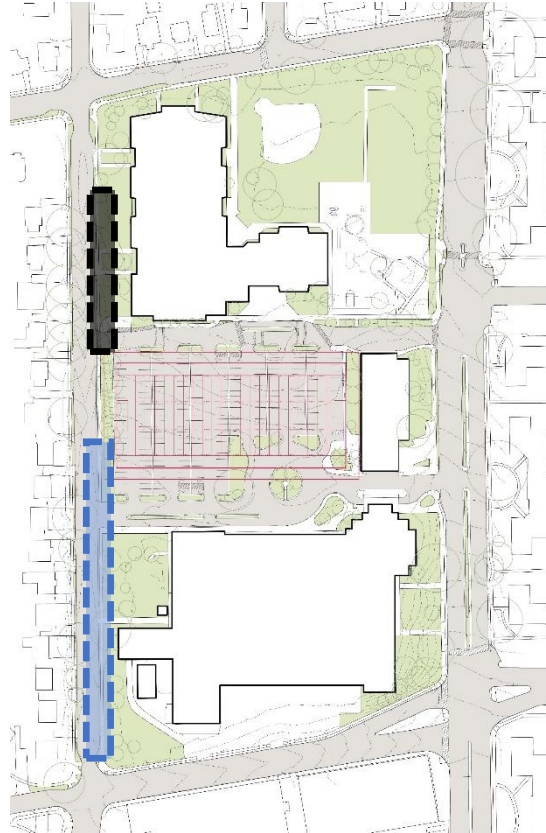

**PU/DO:**  
Option 2, Highland

## Opt 3

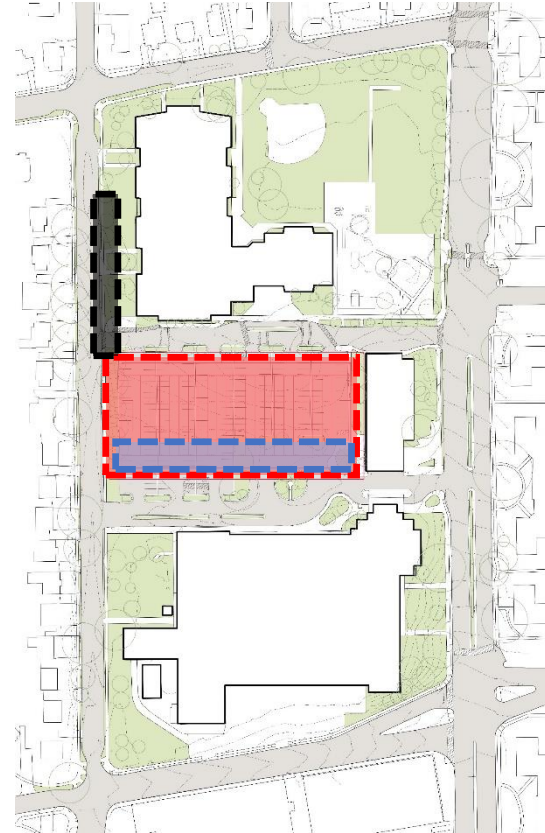

**PU/DO:**  
Option 3, garage

## LEAST POPULAR

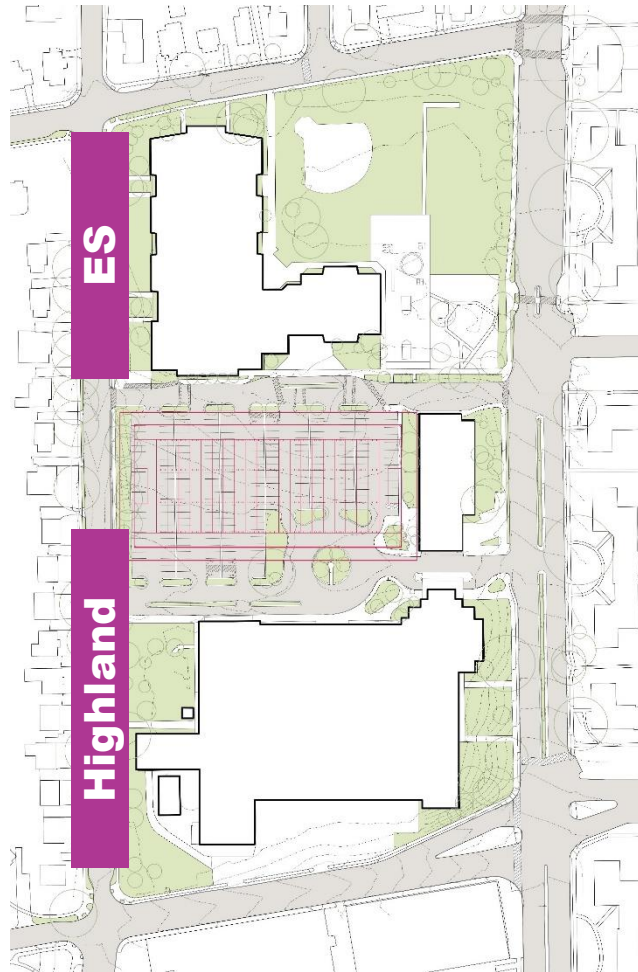

## MOST POPULAR

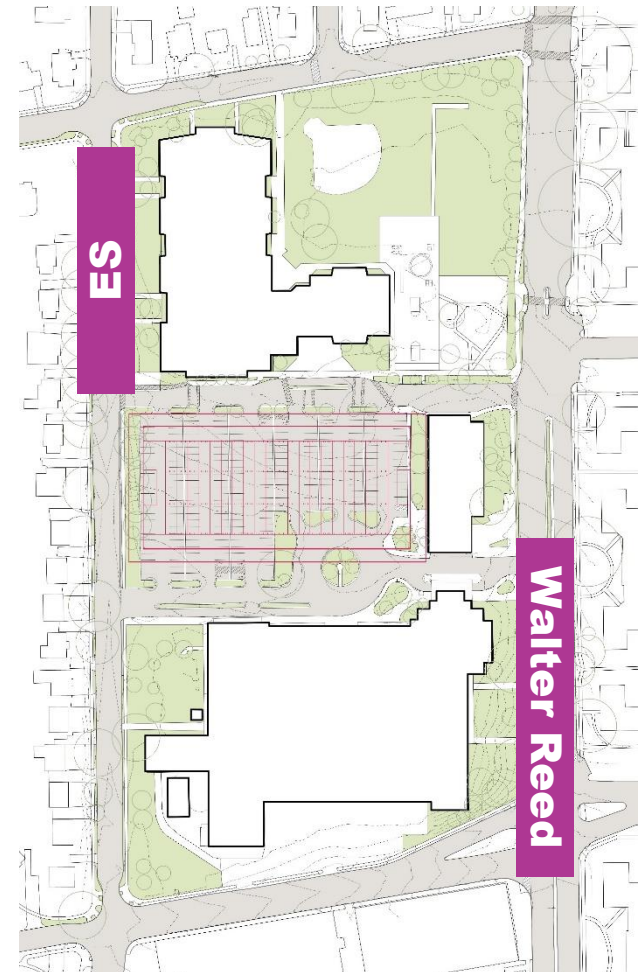

A group of people are gathered in a meeting. In the foreground, a woman with long, curly hair is holding a large, textured, brown object, possibly a piece of fabric or a large bag. She is looking towards the right. Behind her, several other people are visible, some looking towards the camera and others looking towards the right. The background is a plain, light-colored wall. The overall scene suggests a collaborative or creative activity.

# HIGHLIGHTS: GROUP DESIGN EXERCISE



# GROUP DESIGN PROPOSALS

TEAM 1

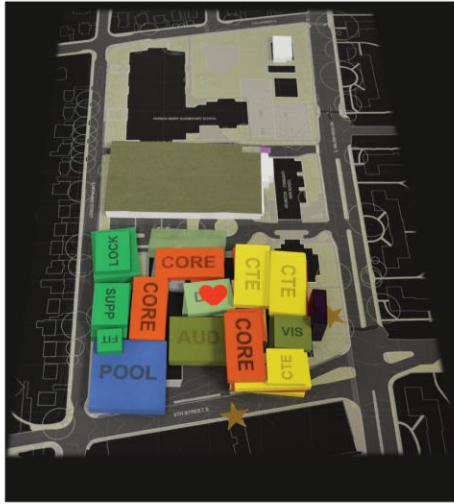

TEAM 2



TEAM 3



TEAM 4



TEAM 5





# CONCEPT DESIGN DRIVERS



# HOW MUCH MORE AREA (SF) DO WE NEED?

**370,800 SF (ED SPEC)**

**- 167,000 SF (EXISTING)**

---

**= 203,800 SF**

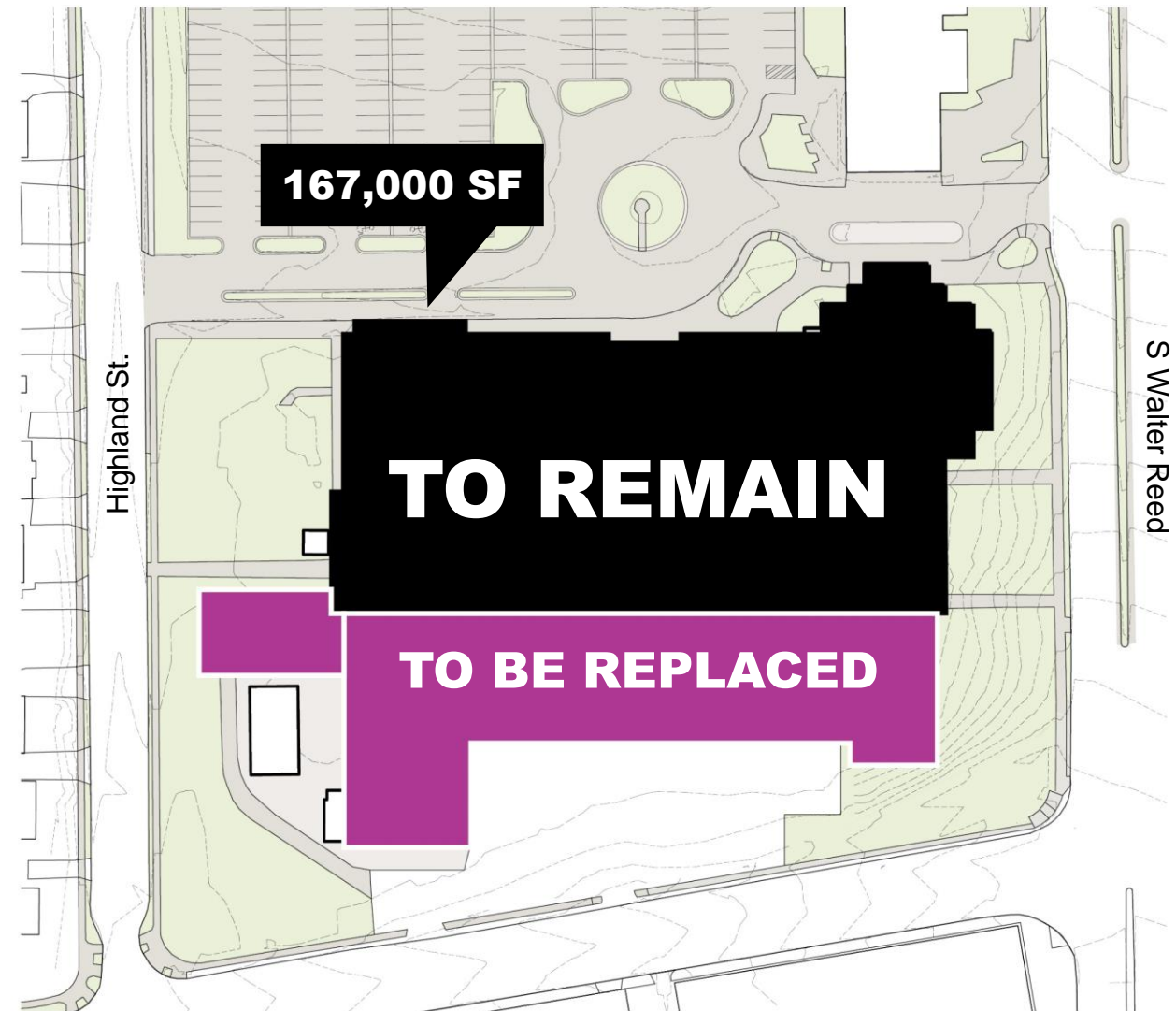

# COMMITTEE AREAS OF CONSENSUS



# MAXIMIZING OUR OPPORTUNITIES

$$\begin{array}{r} 167 \text{ KSF (EXISTING)} \\ + 35 \text{ KSF (HIGHLAND)} \\ + 168 \text{ KSF (9th ST)} \\ \hline = 370 \text{ KSF +/-} \end{array}$$

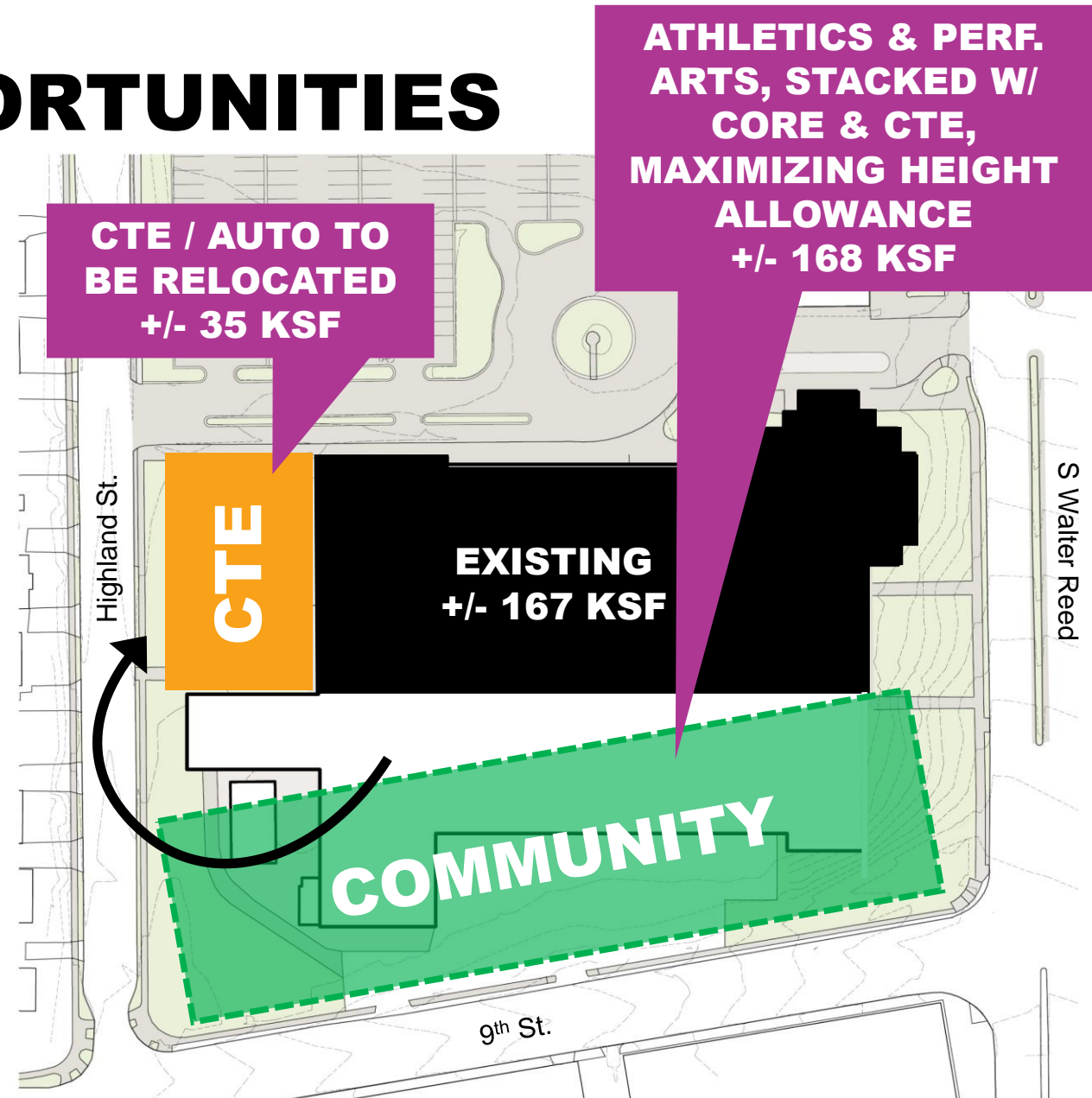

# WHAT ELSE MIGHT INFLUENCE A CONCEPT?

1. Circulation pattern through the building
2. Formal Entry @ 9<sup>th</sup> St. and Walter Reed
3. Bus loading/unloading @ 9<sup>th</sup> St.
4. 8'-10' Slope from Highland to Walter Reed
5. Tree Preservation
6. Service Location



# GALLERY WALK



# SHARE YOUR THOUGHTS!

## ACC EXPANSION BLPC / PFRC PROCESS

### OVERVIEW

The FY 2019-28 Capital Improvement Plan (CIP) contains two Career Center expansion projects:

- Additional 250 Arlington Tech seats for a total of 600 Arlington Tech seats by Sept. 2021
- Creation of 800 new high school seats by Sept. 2025

The concept design phase for the Career Center Expansion is planned to begin in September 2019 including meetings with the Building Level Planning Committee (BLPC) / Public Facility Review Committee (PFRC). The process will include planning for continued growth of the Arlington Tech program. The School Board is scheduled to act on the concept design in March 2020. The concept design will inform development of the FY 2021-30 CIP, with School Board adoption expected in June 2020.

<https://www.apsva.us/design-and-construction/arlington-career-center/>

### WHERE WE ARE...

Along the journey we've taken as a team, the following topics have been discussed:

- Meeting No. 1: BLPC-PFRC Charge, Urban Design, CIP ✓
- Meeting No. 2: CCWG, Transportation Study ✓
- Meeting No. 3: Ed Specs, ACC Programs ✓
- Meeting No. 4: Design Exercise ✓
- Meeting No. 5: Bus and Parent Pick Up / Drop Off ✓
- Meeting No. 6: Parking ✓
- Meeting No. 7: Auto Tack/Collision, Community Programs, Service ✓
- Meeting No. 8: Concept Design Review ✓

### WHAT DO YOU THINK?

Logos: Arlington Public Schools, Stantec, GOROVE SLADE, Gilbane

## ACC EDUCATIONAL SPECIFICATIONS

### OVERVIEW

Educational Specifications (Ed Specs) provide criteria critical for project success including:

- Planning parameters
- Framework for expansion
- Square footage allocations for program spaces
- Space types
- Principles of school planning and design

The ACC Ed Specs:

- Were developed through a series of collaborative meetings with representatives from Department of Teaching and Learning, Arlington Career Center and Facilities and Operations.
- Reflect APS and ACC pedagogy
- Are adaptable to future instructional changes

### SPACE PROGRAM AT A GLANCE

Space Program is organized by type. Each type includes (not limited to):

- ACADEMIC**
  - Classrooms
  - Labs
  - Collaboration Areas
  - Teacher Planning
- ATHLETICS**
  - Competition Gymnasium
  - Auxiliary Gymnasium
  - P.E. and Locker Rooms
  - Fitness and Health Rooms
- ADMINISTRATIVE**
  - Admin Offices
  - Counseling
  - Health Services
- ARTS & AUDITORIUM**
  - 500-Seat Auditorium
  - Black Box Theater
  - Visual & Performing Arts
- AUXILIARY**
  - Library
  - Student Dining
  - Food Prep
- ANCILLARY**
  - Technology Services
  - Building Services

### WHAT DO YOU THINK?

Logos: Arlington Public Schools, Stantec, GOROVE SLADE, Gilbane

## ACC EDUCATIONAL SPECIFICATIONS

### CAPACITY SUMMARY

PROGRAMS/SPACE	TEACHING SQUARE	TOT	THE WITH UTILIZATION	CAPACITY
<b>ACADEMIC</b>				
Classrooms	26	24	# 25	+ 152
Lab	10	11	# 11	+ 100
Support Space	10	24	# 24	+ 200
TECHNICAL				
CTE Lab	10	10	# 9	+ 90
CTE Classroom	26	26	# 17	+ 402
ARTS/PERFORMING ARTS				
500-Seat Auditorium	5	24	# 24	+ 90
Lab	5	24	# 24	+ 90
Black Box Theater	2	24	# 24	+ 90
<b>TOTAL</b>				<b>2194</b>
				<b>122</b>
				<b>2194</b>

1. 100% Teacher Workforce 2. Utilization factor is 90%

### FRAMEWORK FOR EXPANSION

The chart below illustrates the calculation of total capacity using the variables of teaching stations, teacher-student ratios and utilization factor. The difference between the planned enrollment of 1900 and the calculated capacity of 2194 students reflects an allowance of 294 seats for growth of CTE (from neighborhood HS), Academic Academy, EL and PEI programs.

These Ed Specs propose three pillars as the foundational elements of a Framework for Expansion of ACC. Together, they reflect what is already true for ACC and are represented here as sources of inspiration and opportunities for interpretation throughout the planning and design phases of the project.

### ACC'S THREE PILLARS

- COMMUNITY**
  - ACC is part of the community it serves.
  - Relies upon strong relationships with school, business and higher education partners.
- CONNECTED**
  - Students and staff at ACC connected in common purpose and experience.
  - Different instructional programs and students are united as a community of learners.
- CHANGE**
  - ACC is on the path of transformation from the inside-out, characteristics of:
    - "Not So Precious"
    - Easily Adaptable
    - Multi-Functional
    - Community-Oriented
  - ...will continue to define its campus.

### WHAT DO YOU THINK?

Logos: Arlington Public Schools, Stantec, GOROVE SLADE, Gilbane

# SHARE YOUR THOUGHTS!

## GROUP DESIGN EXERCISE

### OVERVIEW

BLPC and PFRC committee members participated in a design charrette: a collaborative session to draft solutions to multiple design challenges. The ultimate goal was to generate visions of the future of ACC.

Utilizing the PFRC Principles of Civic Design, the CCWG Recommendations for massing and density, and ACC Educational Specifications as reference documents; committee members answered the following design challenges:

- Where should ACC's front door be?  
*Thinking Site Access, Pedestrian Flows, Vehicular Flows.*
- What are the ideal locations for ACC's primary community spaces (gym, auditorium, etc)?  
*Thinking Shared Usage, Afternoon/Weekend Programs, Security.*
- How will proposed massing relate to ACC's phasing strategy?  
*Thinking CCWG Zoning Recommendations, Sensibility to Existing Building.*



### TEAM PROPOSALS AT A GLANCE

TEAM 1	TEAM 2	TEAM 3	TEAM 4	TEAM 5
<ul style="list-style-type: none"> <li>• Entry entrance</li> <li>• Entrance at 9th and Walter Reed</li> <li>• "bring building in to the street"</li> <li>• "walk back off site"</li> <li>• "underground parking"</li> <li>• "pedestrian path to site"</li> <li>• "open underground"</li> </ul>	<ul style="list-style-type: none"> <li>• "gymnasium on 2nd floor"</li> <li>• "off building"</li> <li>• "walkway at 9th and Walter Reed"</li> <li>• "shared program ground"</li> <li>• "along the street"</li> <li>• "CTE and academic on 3rd floor would help program"</li> <li>• "openness to existing building"</li> <li>• "connecting along 9th street"</li> <li>• "open underground"</li> <li>• "CTE focus both along 9th st"</li> </ul>	<ul style="list-style-type: none"> <li>• "entrance near where students arrive"</li> <li>• "open"</li> <li>• "set program close to entrance for "visibility of site and Walter Reed"</li> <li>• "open space to street"</li> <li>• "shared space"</li> <li>• "bring front core &amp; CTE"</li> <li>• "back into existing building"</li> <li>• "open program building"</li> <li>• "walk to better building"</li> <li>• "good location for future walk space for program"</li> </ul>	<ul style="list-style-type: none"> <li>• "entrance for program"</li> <li>• "entrance for performance"</li> <li>• "entrance to gym"</li> <li>• "entrance to site and Walter Reed"</li> <li>• "to bring on site"</li> <li>• "open program building"</li> <li>• "bring back to program building"</li> <li>• "bring back to program building"</li> <li>• "bring back to program building"</li> <li>• "bring back to program building"</li> <li>• "bring back to program building"</li> </ul>	<ul style="list-style-type: none"> <li>• "entrance and auditorium" (separate spaces of equal value if combination of core, recreation and CTE)</li> <li>• "bring back to program building"</li> <li>• "bring back to program building"</li> <li>• "bring back to program building"</li> <li>• "bring back to program building"</li> <li>• "bring back to program building"</li> <li>• "bring back to program building"</li> <li>• "bring back to program building"</li> </ul>

### WHAT DO YOU THINK?



## GROUP DESIGN EXERCISE

### REVEALING AREAS OF COMMON INTEREST

TEAM 1 TEAM 2 TEAM 3 TEAM 4 TEAM 5

Front door should be in the vicinity of S Walter Reed and 9th Street, strengthening the connection to Columbia Pike!

Prominent Performing Arts along 9th. Multiple Approaches to Gym (Highland St and 9th). Pool: Connected to ACC or not.

Integration of CTE into Core Academics. Making CTE part of early phases of construction. Location of Autotech near Highland.

As much green area as possible. Ample terrace spaces. Access to natural light.

### WHAT DO YOU THINK?



- CORE
- CTE
- PERF. ARTS
- ATHLETICS
- POOL

## ACC CONCEPT DESIGN DRIVERS

### HOW MUCH SF IS NEEDED?

TO REMAIN: 167,000 SF  
TO BE REPLACED: 34,200 SF

The amount of square footage (SF) needed to allocate the space program recommended in the ACC Ed Specs is calculated as follows:

370,832 SF (ED SPEC SPACE PROGRAM)  
-167,000 SF (REMAIN)  
=203,832 SF

### CONCEPT DESIGN DRIVERS

1. Circulation pattern connecting building.
2. Formal Entry at 9th St. and Walter Reed.
3. Bus loading/unloading along 9th St.
4. 8'-10' slope from Highland St to Walter Reed.
5. Tree Preservation.
6. Service Location.

### AREAS OF CONSENSUS

CTE / AUTO TO BE RELOCATED ALONG HIGHLAND

ATHLETICS & PERF. ARTS ALONG 9TH, STACKED W/ CORE & CTE, MAXIMIZING HEIGHT ALLOWANCE

### WHAT DO YOU THINK?





# SHARE YOUR THOUGHTS!

## PARKING

**CHARGE**  
 Develop options and estimated costs for various options for on-site parking during the Concept Design phase, including:  
 1) No structured parking and accessible parking spaces only provided on site  
 2) A one-level 225 to 250-space, below-grade parking structure  
 3) A two-level 450 to 500-space, below-grade parking structure  
 4) Other parking solutions that may emerge during Concept Design

**NEXT STEPS:**  
 1) BLP/PPFC recommends the preferred parking option(s) to the School Board  
 2) The School Board will approve a parking solution when it approves the Concept Design  
 3) The parking solution is ultimately approved by the County Board as part of the Use Permit

**COUNTY ZONING REQUIREMENTS**

	REQUIRED SPACES	CAPACITY
ARLINGTON CAREER CENTER	220 + 520 spaces	2,194 students
ARLINGTON COMMUNITY HIGH SCHOOL	20 spaces	200 students
MONTESSORI PUBLIC SCHOOL OF ARLINGTON	74 spaces	463 students
COLUMBIA PIKE LIBRARY	40 spaces	
<b>REQUIRED SPACES*</b>	<b>354 + 520 SPACES</b>	

\*County board has the authority to reduce the zoning-required parking

**PEAK SUPPLY AND DEMAND**

	SUPPLY			PEAK DEMAND (2 PM)	OPINION OF CDT
	ON-SITE	ON-STREET	OFF-SITE		
SCENARIO A	2 levels (450-500 spaces) below-grade			HS Staff: 210-247 ES Staff: 72-79 Students: 85-135 Library/Visitor: 35 Total: 402-496 spaces * Low assumes TDM	\$ 31.1 to 33.8 M
SCENARIO B	1 level (225-250 spaces) below-grade	Adjacent: 77 spaces	Lease in nearby private garages (up to 200 spaces)		\$ 15.5 to 16.9 M
SCENARIO C	Visitor/ADA Lot Only	Nearby Unrestricted: up to 144 spaces	*ECDC garage for temporary use only (up to 100 spaces under present agreement)		Leasing Costs \$ 3 M
SCENARIO D1	Surface lot (up to 150 spaces) on-grade				\$ 13.8 to 15 M
SCENARIO D2	1-3 levels (up to 300 spaces) above-grade				

**PARKING ACCESS POINT(S)**

- Option 1: In and Out on Highland St  
• Can be combined with Option 3
- Option 2: In on Highland St and Out on Walter Reed Dr  
• Most likely right-out only
- Option 3: In and Out on Walter Reed Dr  
• Most likely right-in/right-out only  
• Can be combined with Option 1
- Option 4: In and Out on 7<sup>th</sup> St  
• For above-grade scenarios (D1 & D2)

## TRANSPORTATION

**TRANSPORTATION GOALS**

- 1) Provide and promote multi-modal options to help reduce the amount of driving to the Career Center
- 2) Create a safe campus for all modes of travel
- 3) Minimize traffic impact generated by the Career Center
- 4) Minimize parking costs of project
- 5) Minimize on-street parking conflicts
- 6) Provide efficient and convenient transportation options for APS families and staff
- 7) Minimize space dedicated to transportation on the Career Center campus

**BUS FACILITIES**

Elementary: Unchanged    HS Option 1: On-site, split    HS Option 2: On-site, shared    HS Option 3: Curbside, 9<sup>th</sup> Street

**PICK-UP/DROP-OFF FACILITIES**

Elementary: Unchanged    HS Option 1: Curbside, 9<sup>th</sup> St    HS Option 2: Curbside, Highland St

HS Option 3: On-site, Garage    HS Option 4: Curbside, Walter Reed Dr

## TRANSPORTATION AND PARKING

**WHAT DO YOU THINK?**

# ADJOURN



# ADJOURN

As a reminder the APS Project Manager is:

**Steve Stricker**

(703) 228-7749

[steven.stricker@apsva.us](mailto:steven.stricker@apsva.us)

Public meeting dates and past presentations are posted on the APS project website: <https://www.apsva.us/design-and-construction/arlington-career-center/>

Next meeting: **February 19, 2020 @ 7:00pm**

To provide feedback and/or comments to APS use: [engage@apsva.us](mailto:engage@apsva.us)