



# Secondary School @Wilson

## Community Newsletter (March 2018)

### **Completed and ongoing tasks:**

- Below grade waterproofing ongoing.
- Concrete footings and foundation walls ongoing.
- Erection of elevator core walls ongoing.
- Installation of below grade utilities ongoing.
- Installation of concrete slab on grade at B2 level ongoing.
- Major structural steel in fabrication.
- Curtainwall material released for fabrication.
- Received full building permit.

### **Construction activities next month:**

- Delivery and start of erection of structural steel framing.
- Continue installation of foundation walls and concrete slab on grade at G1 level.

### **Process related activities:**

- Construction activities will continue between 7am to 5pm on week days, and 9am to 5pm on weekends and holidays.





Elevator core formed @ penthouse









Installation of below grade utilities

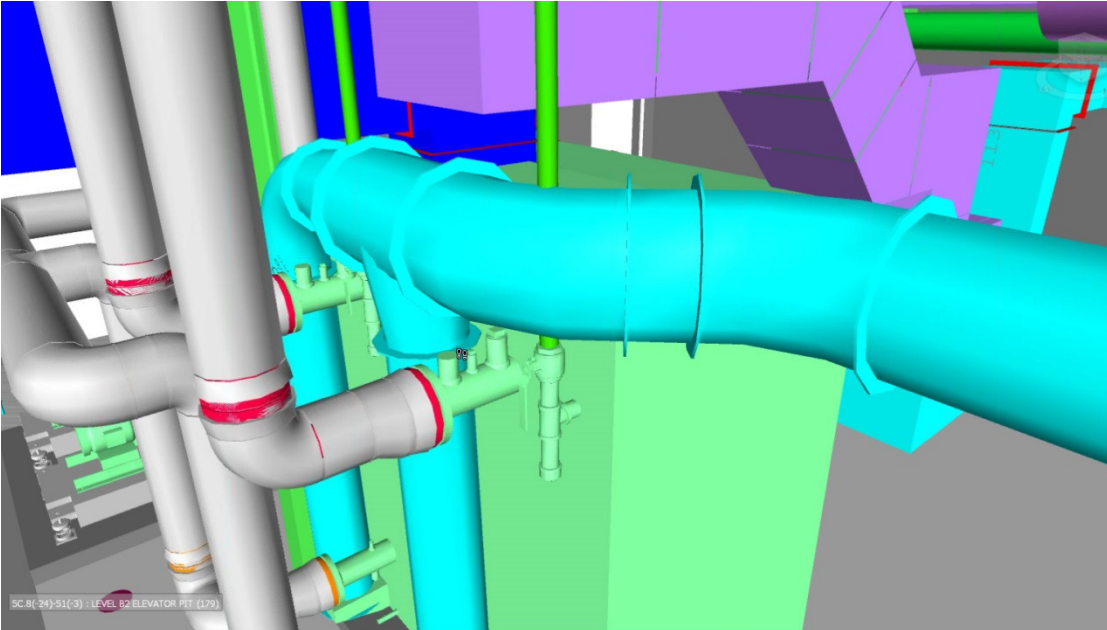

MEP coordination





Backfill elevator pit



2 level elevator core