

Career Center Working Group

Meeting # 1: January 22, 2018

Arlington Career Center: Programs and Campus Facilities

Margaret Chung, Principal | Arlington Career Center
Derk Jeffrey, Senior Principal | Stantec Architecture



Outline

Part 1: Arlington Career Center

- Programs
- Arlington Tech
- CTE Programs
- Partnerships
- Profile of a Virginia Graduate
- Mission, Vision, Core Values

Part 2: Campus Facilities

- Previous Studies and Improvements (2007 – 2017)
- Site and Buildings
- Career Center (space utilization, existing structure)
- Phase 1 Expansion

Arlington Career Center – Programs and Campus Facilities

Part 1: Arlington Career Center

Arlington Career Center – Programs

Arlington Career Center

CTE

900 CTE students
districtwide

Academic
Academy

50 Gr 9-12,
transformative,
individualized support

HILT Institute

80 ESOL, age 16-21,
newly arrived,
sheltered academics

Program for
Employment
Preparedness

60 SPED, age 18-21,
transition to work &
independent living

Arlington Tech

130 students, choice
CTE-PBL program, DE,
work-based capstone

Teen Parenting
Program

25-40 teen parents,
academic/counseling/daycare
support, social services,
transportation

Arlington Career Center – Arlington Tech



- CTE/STEM-in-Action
- Project Based Learning
- Dual Enrollment 11th/12th Grade
- Industry Certification
- Work-Based Internships



Arlington Career Center – Arlington Tech

Course Offerings:

Arlington Tech Proposed Schedule (DE) indicates dual enrolled courses				
Subject	Grade 9	Grade 10	Grade 11	Grade 12
Math	Geometry Int Geom Algebra II Int Alg II/Trig	Algebra II Alg II Int Pre-Calculus (DE)	Pre-Calculus (DE) Calculus(DE)	Calculus(DE) Vector Calculus(DE) Stat (DE)
English	English 9 Eng 9 Int	English 10 Eng 10 Int	English 11 (DE)	English 12 (DE)
Science	Biology Bio Int	Chemistry Chem Int	Phy (DE) Bio (DE)	Physics (DE) Bio (DE)
Social Studies	World History W. Hist Int	Econ/Persona I Finance	US/VA History (DE)	US Govt (DE)
CTE	CTE Rotations	CTE	CTE Or	CTE
Health/PE or CTE	Health/PE	Health/PE	CTE	CTE Capstone Internship
World Lang	Level I Level II or Level III	Level II Level III or Level IV	Span (DE)	

Arlington Career Center – Arlington Tech

Projected Enrollment:

Proposed Arlington Tech Student Enrollment						
Grade	2016-17	2017-18	2018-19	2019-20	2020-21	2021-22
9	40	100	200	200	200	200
10		40	100	200	200	200
11			40	100	200	200
12				40	100	200
Total	40	140	340	540	700	800

Arlington Career Center – CTE Programs

Engineering / Trades-Industrial:

- Aviation*
- Auto-Tech*(DE)
- Auto Body
- Energy & Power/Robotics
- Engineering
- Engineering Drawing*
- Architectural Drawing*
- Networking/Electricity*

*denotes National/State Licensure or Certification
(DE) denotes Dual-Enrolled Courses

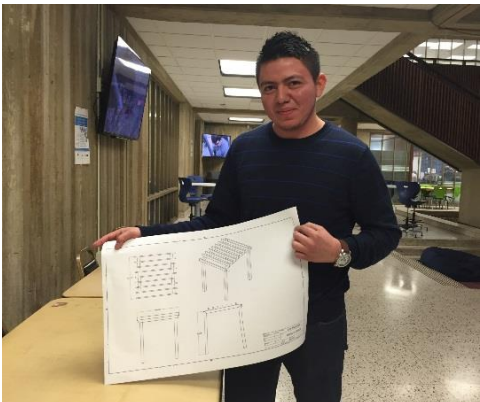

Arlington Career Center – CTE Programs

IT/Digital Media:

- Cyber Security*(DE)
- Computer Programming (DE)
- Advanced Topics in IT (DE)
- TV Production (DE)
- Computer Graphics/Animation*

*denotes National/State Licensure or Certification
(DE) denotes Dual-Enrolled Courses



Arlington Career Center – CTE Programs

Health and Medical:

- Animal Science/Vet Tech
- EMT*(DE)
- Forensic Science
- Health and Medical Terminology(DE)
- Pharmacy Tech*
- Physical Therapy/Sports Medicine

*denotes National/State Licensure or Certification
(DE) denotes Dual-Enrolled Courses



Arlington Career Center – CTE Programs

Human/Public Services:

- Culinary Arts
- Cosmetology*
- Early Childhood Education*(DE)
- AF-JROTC

*denotes National/State Licensure or Certification
(DE) denotes Dual-Enrolled Courses

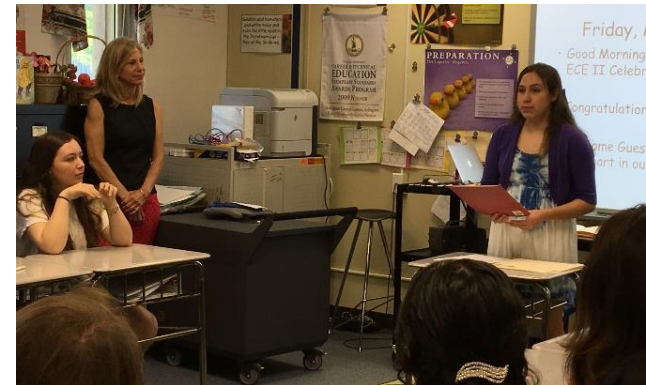

Arlington Career Center – Partnerships

Community and Business Partnership Tiers:

Tier 1: Community or business partner comes to Career Center speak to class, guest panel, Career Expo, mentors student

Tier 1 Example: A Cyber-Security Data Analyst presents about data warehouse storage within the Federal Government to the Cyber Security class.

Tier 2: Career Center students go to a community business to visit or job shadow (either in a small group or whole class).

Tier 2 Example: Physical Therapy students view open heart surgery at INOVA Fairfax.

Tier 3: An individual Career Center student is assigned to a work experience (paid or unpaid).

Tier 3 Example: A student works as a paid 8-week summer intern at American Service Center and is mentored by a master technician.

Arlington Career Center – Aligned to the Future

Profile of a Virginia Graduate In Virginia, the Life Ready Individual Will, During His or Her K-12 Educational Experience:

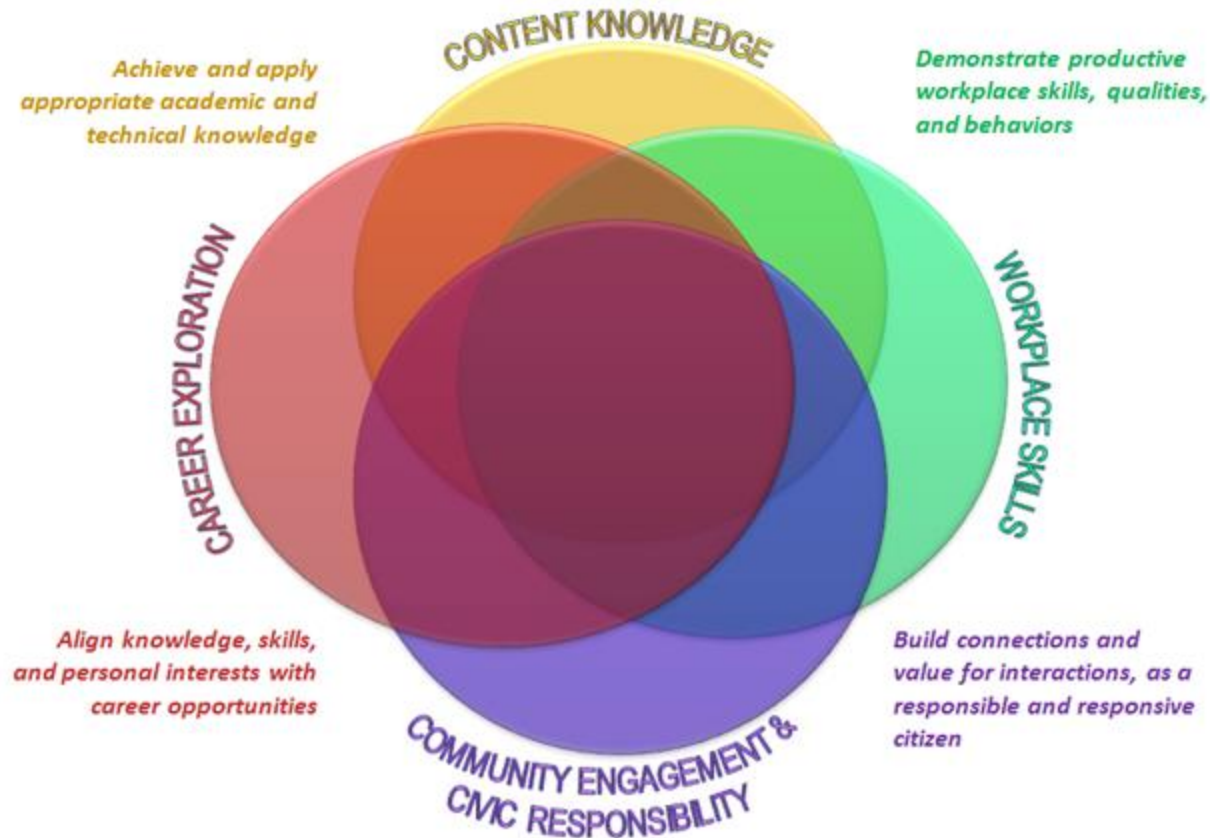

Arlington Career Center – Mission, Vision, Core Values



Feed the Soil.

Arlington Career Center – Programs and Campus Facilities

Part 2: Campus Facilities

In 2017, APS engaged Stantec Architecture to study options for expansion of the Career Center to accommodate the projected enrollment of 800 students in Arlington Tech by 2022. This would create a school population of approximately 1300 students by 2022: (500 existing students plus 800 more for Arlington Tech).

The scope of that study included: 1) establishing the space requirements for a 1300-pupil campus, 2) consideration of the operational and construction phasing concerns associated with facility expansion, and 3) development of preliminary options for an initial, **Phase 1** scope of work.

The Phase 1 expansion project has been suspended pending the recommendations of the CCWG. However, interior alterations are occurring at the Career Center to serve the growing Arlington Tech program.

Arlington Career Center – 2007 through 2017

Timeline

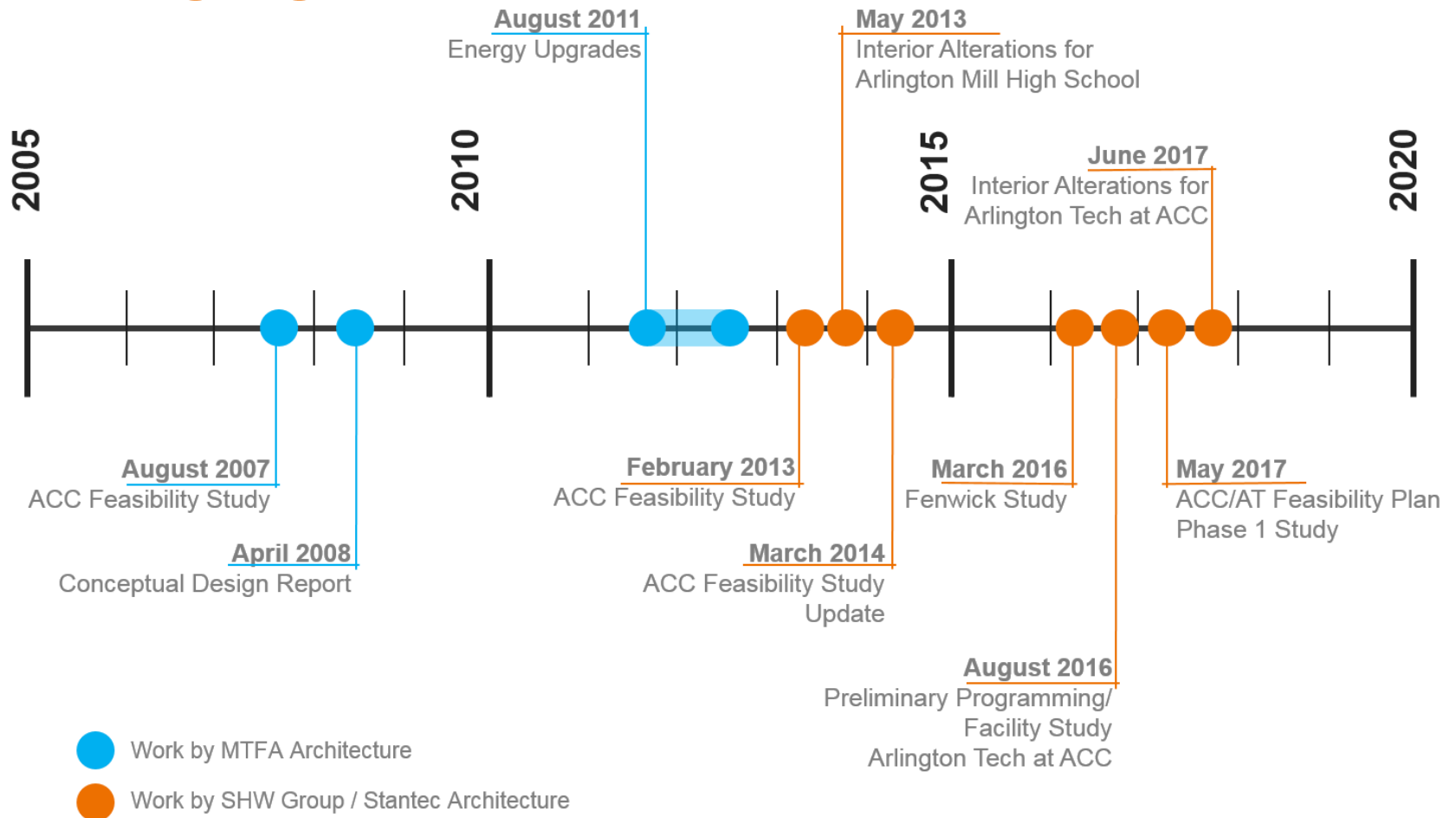

Arlington Career Center – Campus Facilities

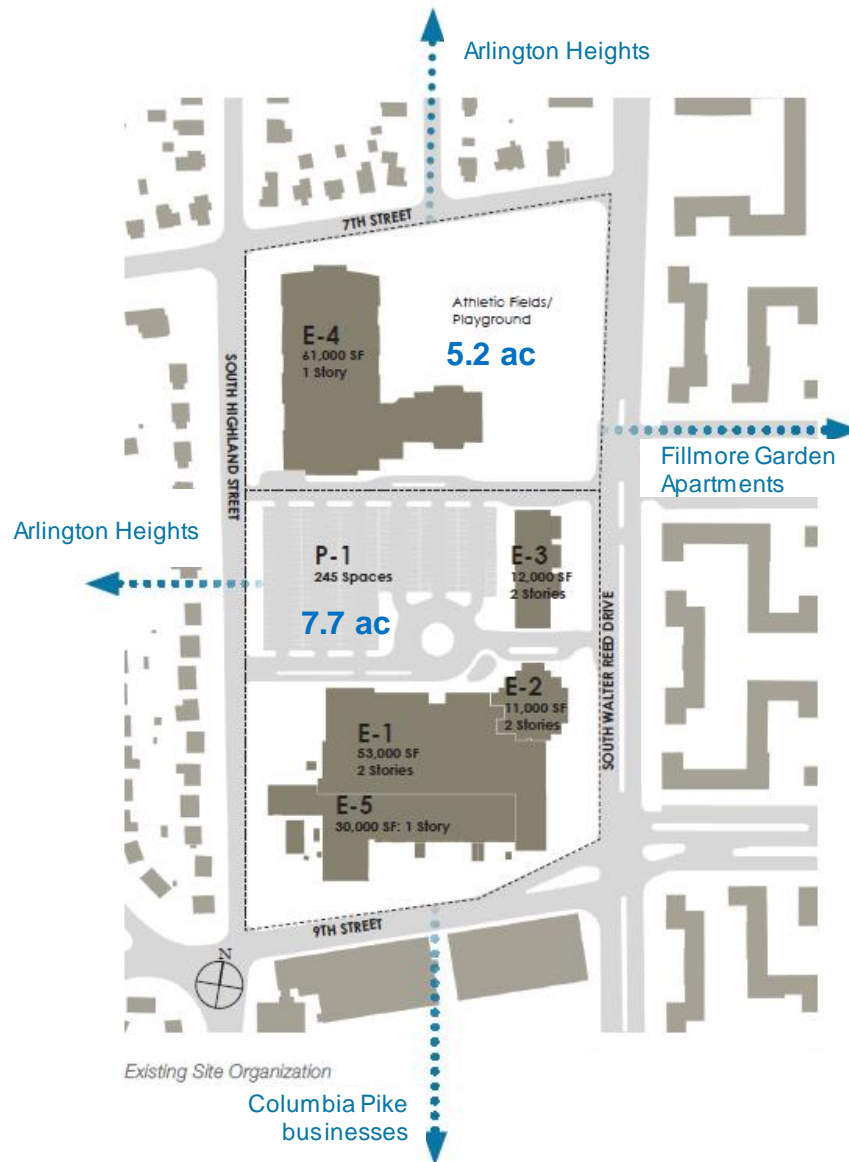

Total Site Area- 564,000 SF
 Elementary Site- 228,000 SF
 Career Center Site- 336,000 SF

Gross SF (All Buildings)- 248,000 SF
 Elementary Site- 61,000 SF
 Career Center Site- 187,000 SF

Gross SF- 248,000 SF
 High School- 143,500 SF
 Public Library- 21,500 SF
 Elementary- 61,000 SF
 Fenwick Building- 22,000 SF
Total Required Parking- 179 Spaces
Total Existing Parking- 245 Spaces

Arlington Career Center – Campus Facilities

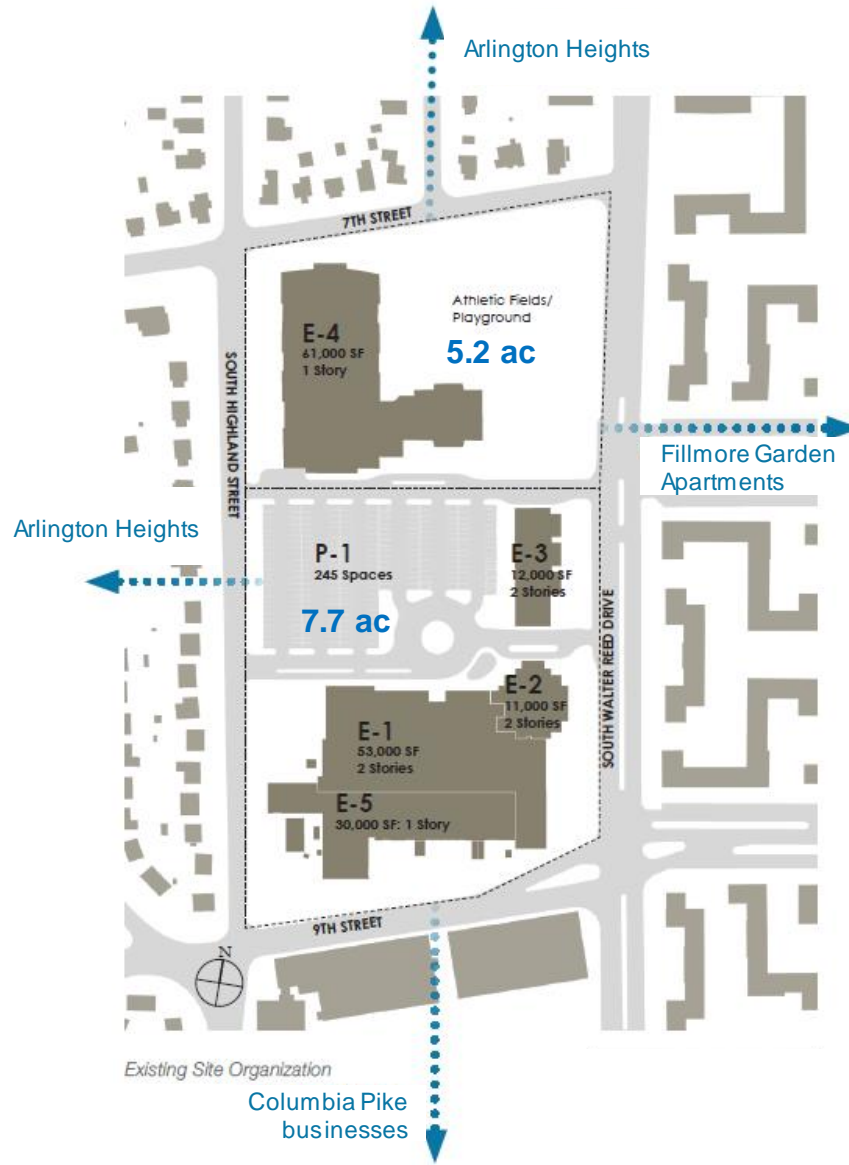

Existing Buildings

- E-1-**
Use- High School
Height- 2 Stories
Footprint- 53,000 SF
Floor Area- 100,000 SF
- E-2-**
Use- Public Library
Height- 2 Stories
Footprint- 11,500 SF
Floor Area- 21,500 SF
- E-3-**
Use- Fenwick Building
Height- 2 Stories
Footprint- 12,000 SF
Floor Area- 22,000 SF
- E-4-**
Use- Elementary School
Height- 1 Story
Footprint- 61,000 SF
Floor Area- 61,000 SF
- E-5-**
Use- High School
Height- 1 Story + Mezzanine
Footprint- 30,000 SF
Floor Area- 43,500 SF
- P-1-**
Parking- 245 Existing Spaces

Arlington Career Center – Space Utilization

First Floor Areas:

Career Center: 84,244 GSF
 Library: 10,248 GSF
 Subtotal: 94,492 GSF

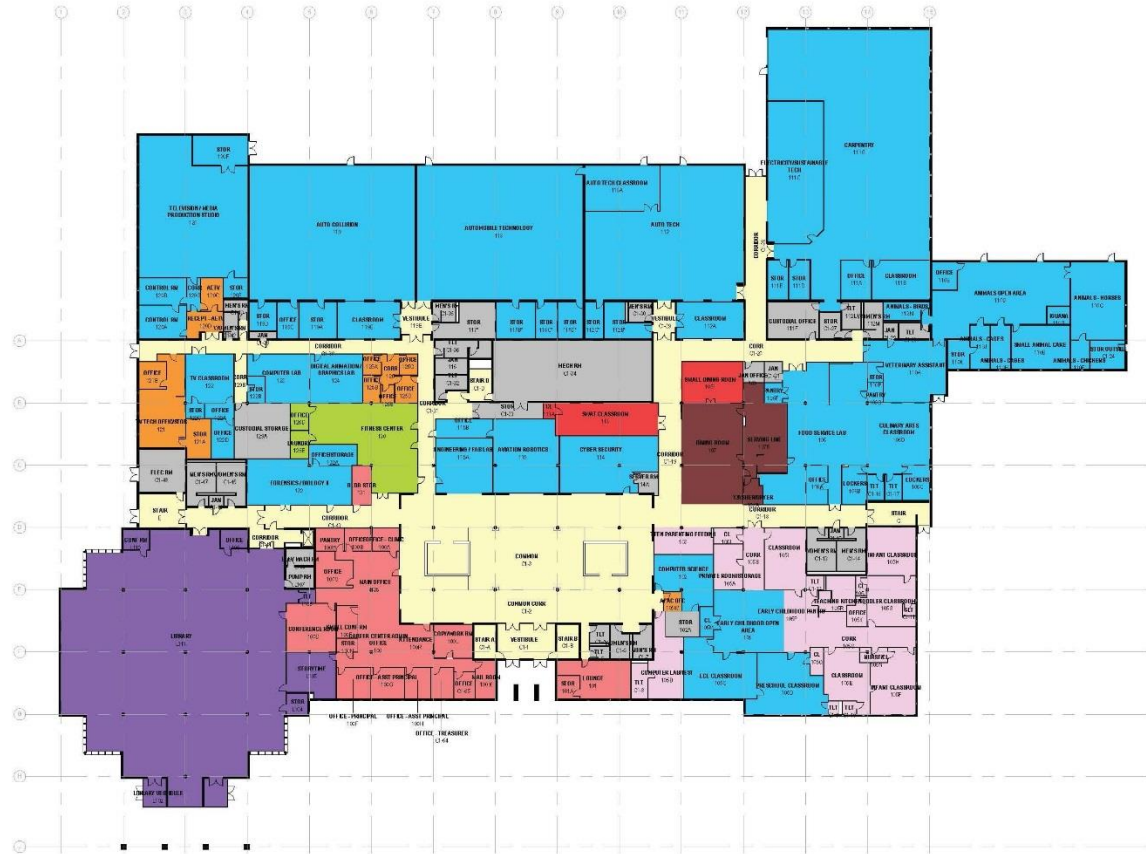

- LEGEND**
- BLDG SUPPORT
 - CIRCULATION
 - COUNTY
 - CTE
 - EARLY CHILDHOOD
 - FOOD SERVICES
 - LIBRARY
 - MAIN OFFICE
 - PE
 - PEP

Arlington Career Center – Space Utilization

Second Floor Area:

Career Center: 53,139 GSF
 Library: 9,959 GSF
 Subtotal: 63,098 GSF (excl. areas open to below)

Total Building Area:

Career Center: 137,383 GSF
 Library: 20,207 GSF
 Total: 157,590 GSF

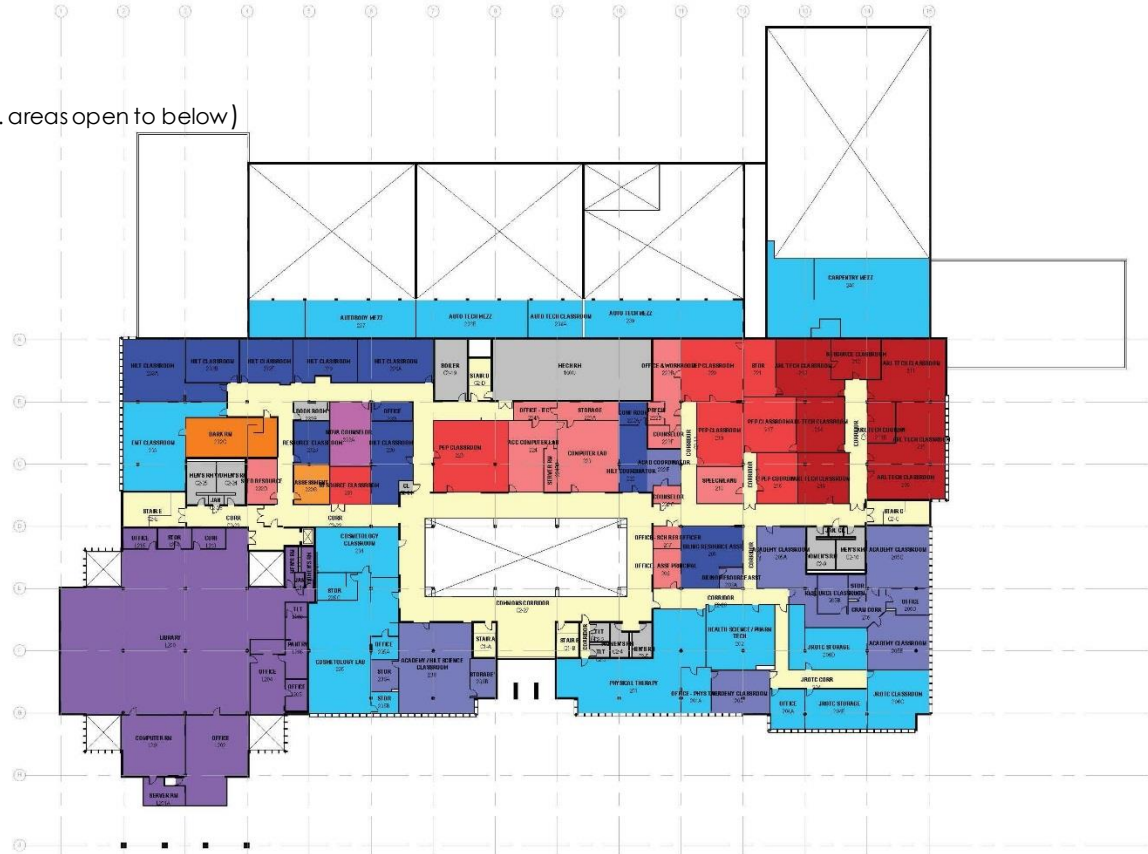

- LEGEND**
- BLDG SUPPORT
 - CIRCULATION
 - COUNTY
 - CTE
 - EARLY CHILDHOOD
 - FOOD SERVICES
 - LIBRARY
 - MAIN OFFICE
 - PE
 - PEP
 - HILT
 - ACADEMIC ACADEMY
 - ARLINGTON TECH

Arlington Career Center – Existing Structure (modeled)

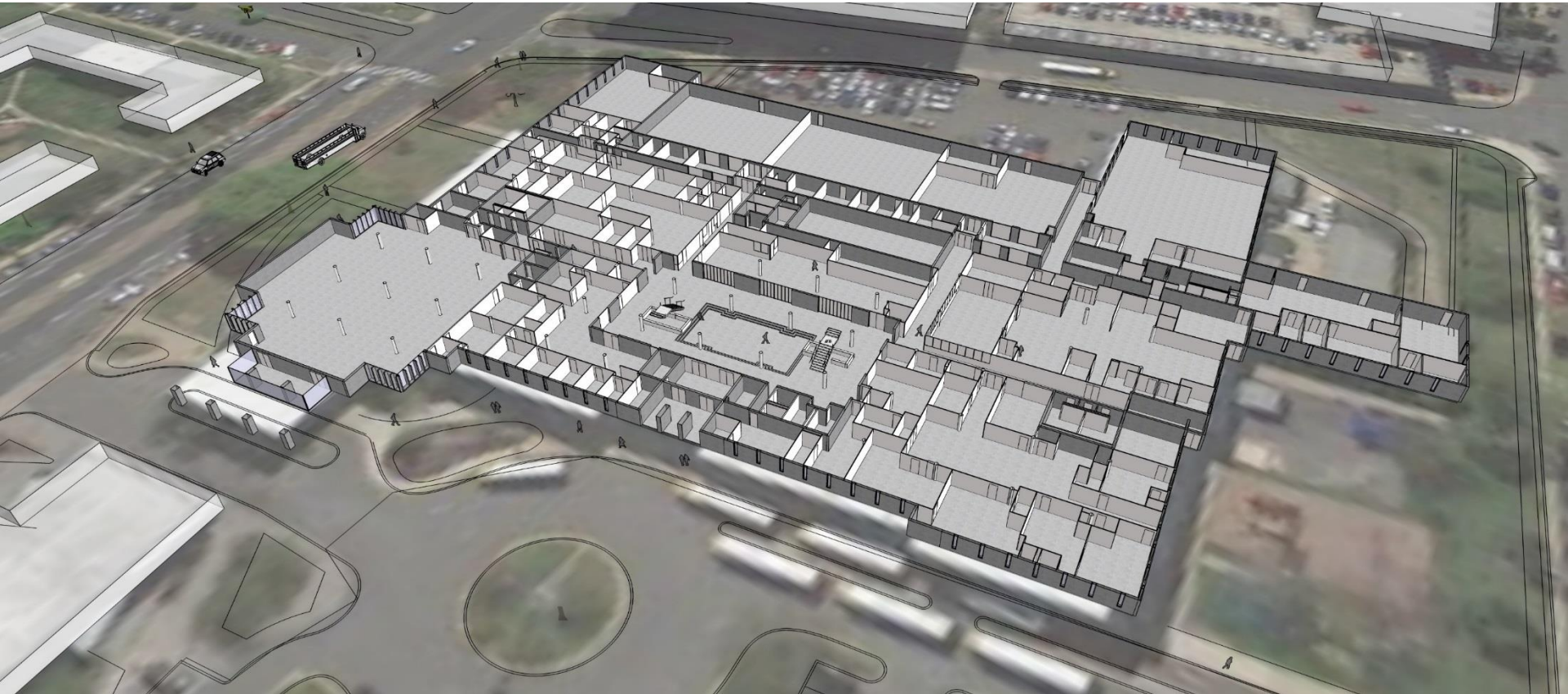

Arlington Career Center – Existing Structure (modeled)

(highlighted partitions are non load-bearing)

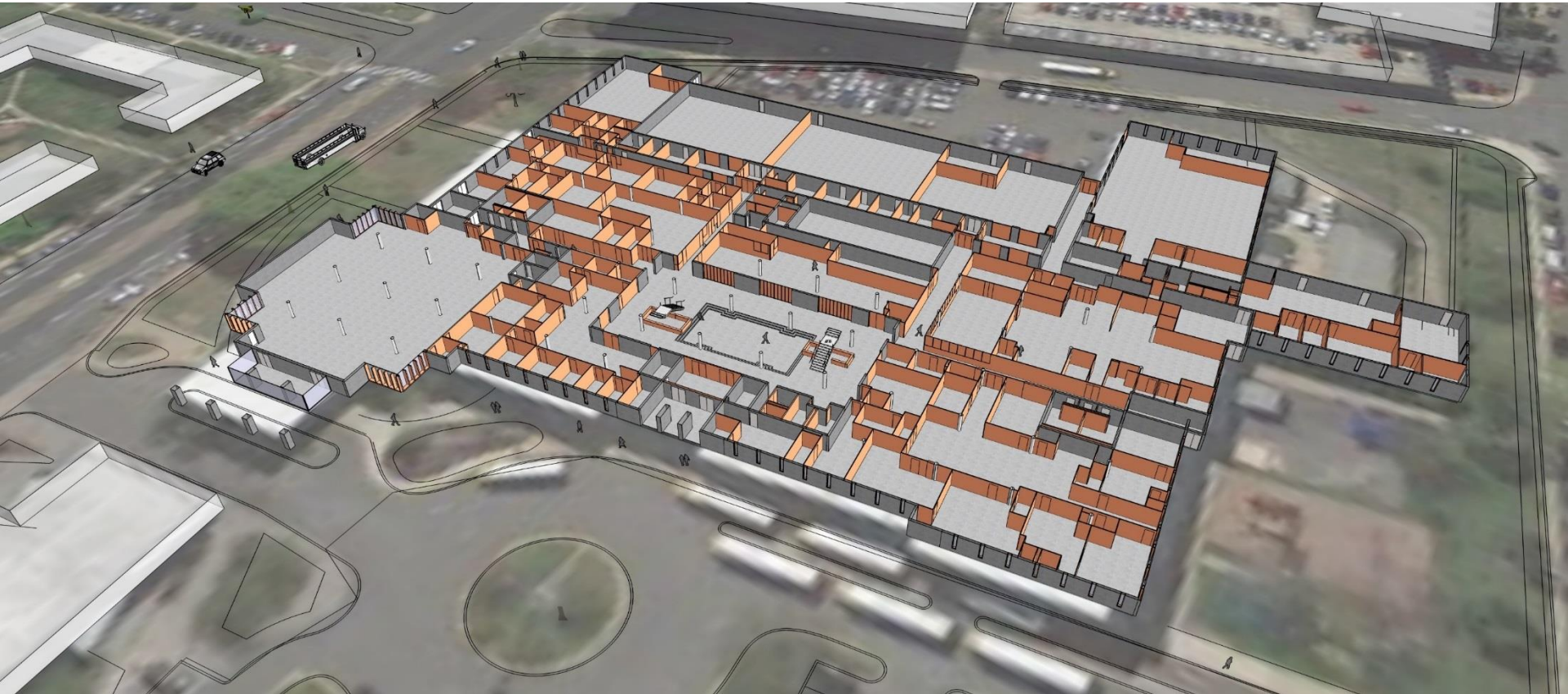

Arlington Career Center – Existing Structure (modeled)

(shown with all non load-bearing partitions removed)

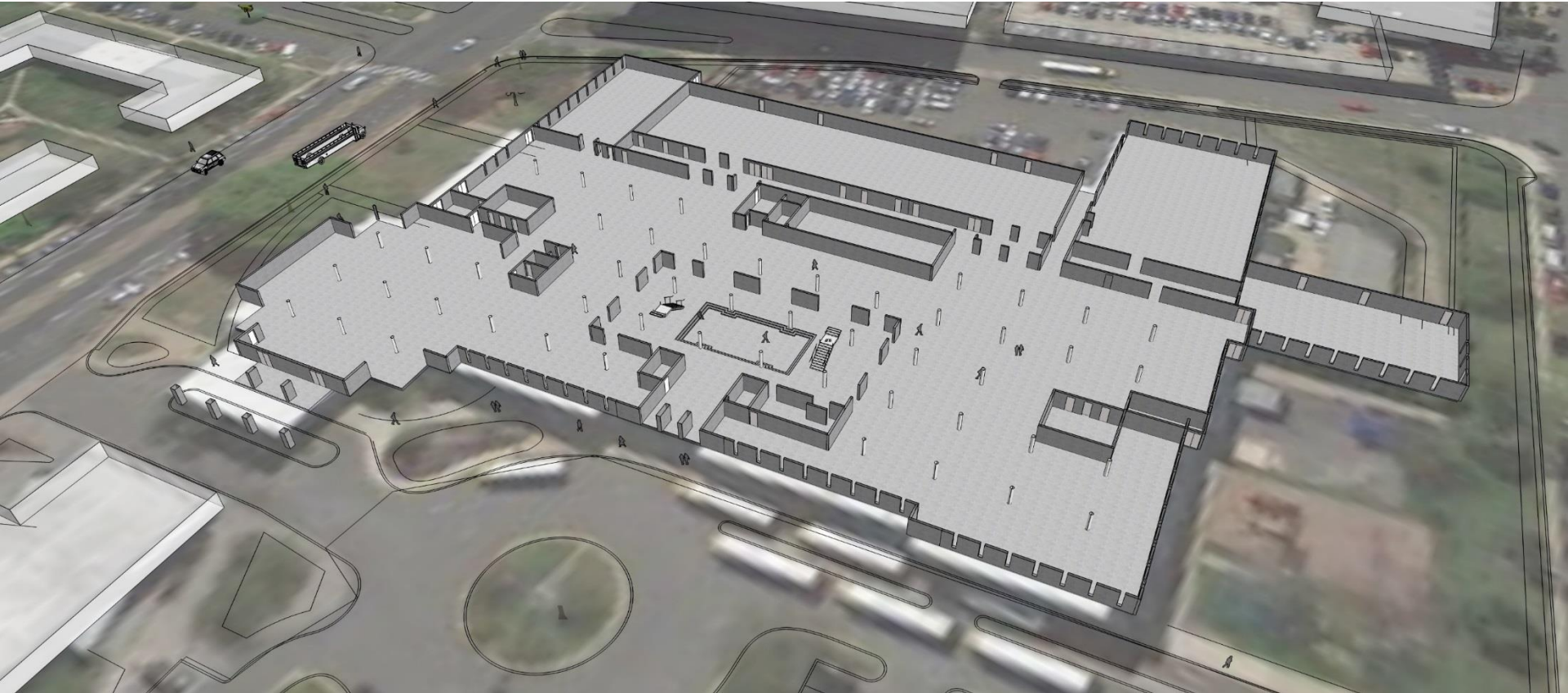

Arlington Career Center – Existing Structure (modeled)

(shown with potential, 3rd floor expansion on existing roof)

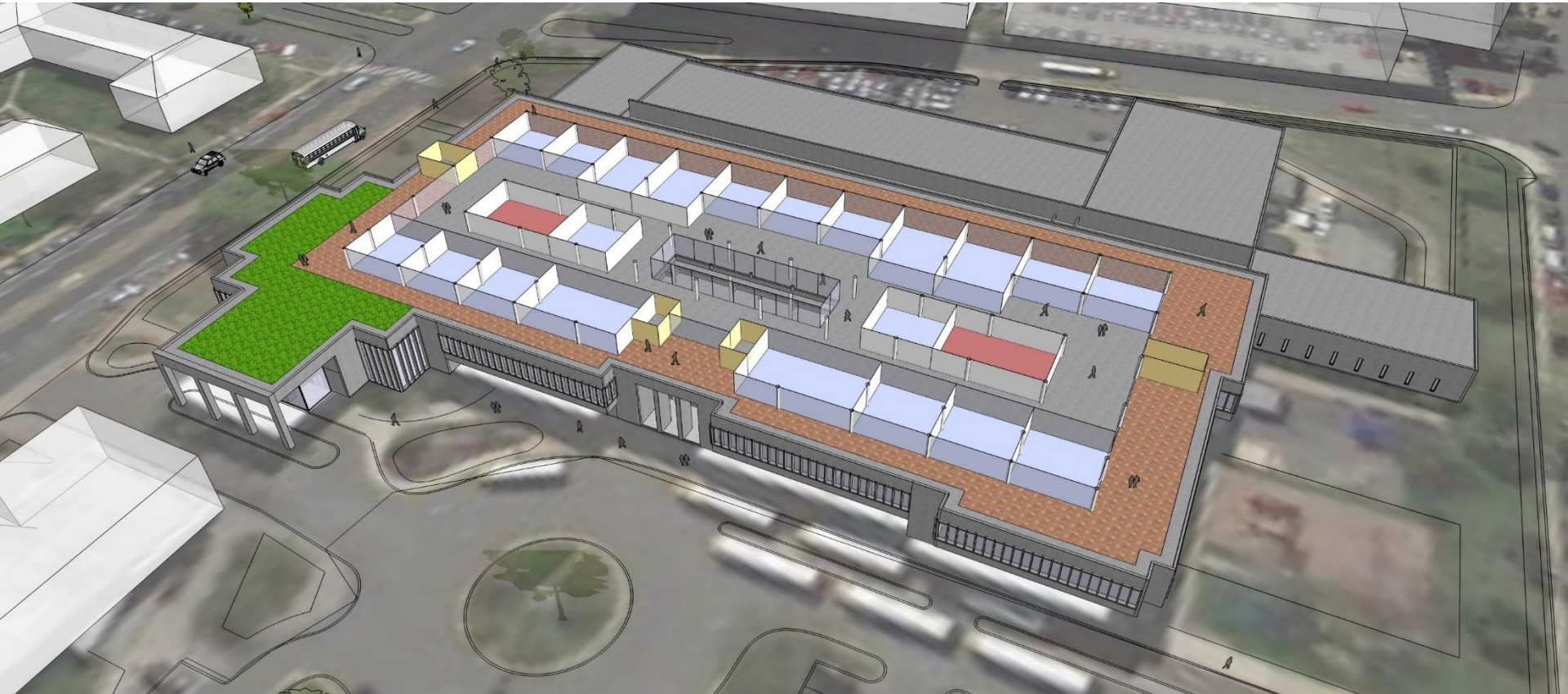

Phase 1 Expansion Requirements

- Accommodate 600 Arlington Tech Students
- Accomplish Within Construction Budget of \$10M - \$12M
- Complete by 2018 – 2019
- Minimize Disruption & Disturbance to Existing School Operations
- Create Swing Space for Future Renovations
- Improve Facility Image

Arlington Career Center – Phase 1 Expansion

- Block schedule, 8 instructional periods / 2 days
- 100% utilization (every instructional space used every period)
- Every 8 sections of instruction requires one **Learning Space (LS)**

Program	Capacity	Students/Teacher	LS (@ 85%)		
Arlington Tech	800	20:1	800/17	=	47
Academic Academy	50	15:1	50/13	=	4
HILT Institute	90	15:1	90/13	=	7
PEP	60	10:1	60/9	=	7
CTE	300	20:1	300/17	=	18
Total	1300				83

Total LS Required for 1300 Students = 83. This is more than twice the number of existing LS at the career center.

Arlington Career Center – Phase 1 Expansion

Integrated Learning Community x (4), Arlington Tech + CTE

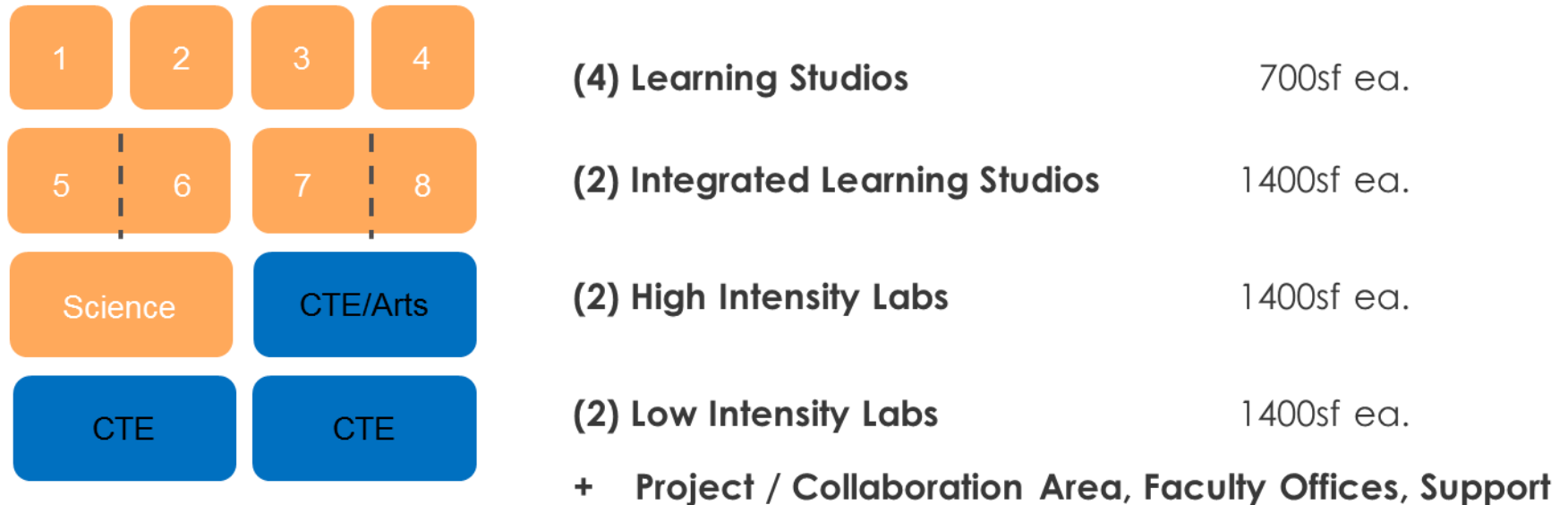

This diagram illustrates the integration of Academic and Technical Learning Spaces.

Arlington Career Center – Phase 1 Expansion

Integrated Learning Community x (1), Academic Academy, HILT, PEP + CTE

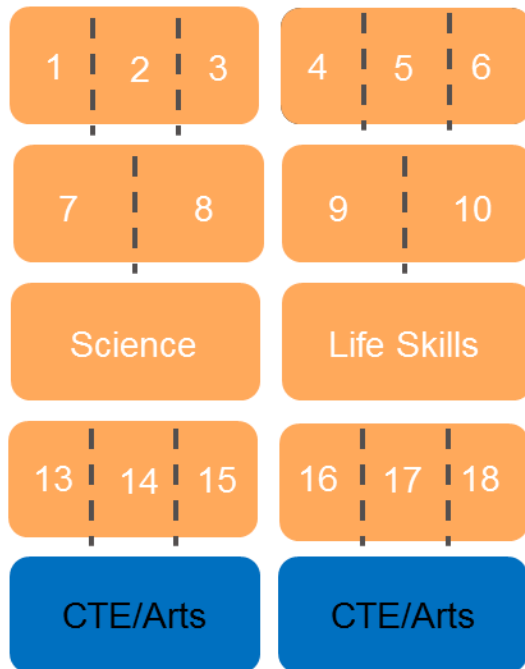

(2) Integrated Learning Studios

1400sf ea.

(2) Integrated Learning Studios

1400sf ea.

(2) High Intensity Labs

1400sf ea.

(2) Low Intensity Labs

1400sf ea.

(2) High Intensity Labs

1400sf ea.

+ Project / Collaboration Area, Faculty Offices, Support

This diagram illustrates the integration of Academic and Technical Learning Spaces.

Arlington Career Center – Phase 1 Expansion

(side-by-side comparison of existing building area to a future, expanded Career Center for 1300 students)

Existing Career Center

Expanded Career Center for 1300

Significant Program / Space Increases

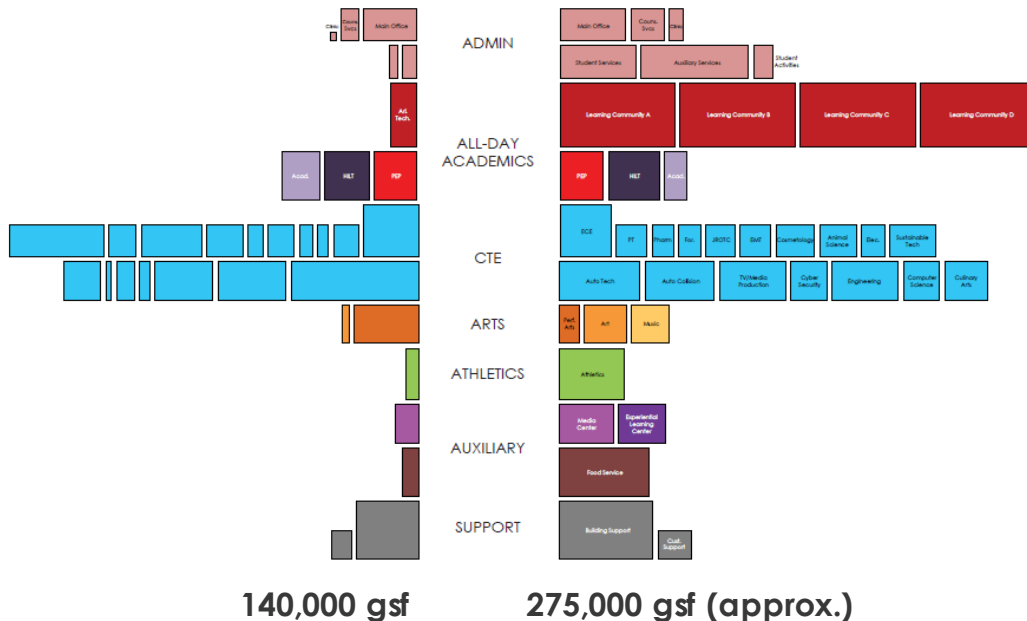

- Capacity increased by 800 Students.
- All instructional spaces are “right-sized,” meaning most classrooms are larger and most labs are proposed as 1400 sf each.
- Fitness, Food Service/Dining and Performance Spaces are added or expanded.
- A Media Center / Maker Space is added.
- Teacher Planning spaces are added.
- Service / support areas are added or expanded.

Rule of Thumb for Comprehensive HS Planning:
 (180 – 200sf/pupil) x enrollment = approx. sf
 1000 pupils x 200sf = 200,000sf + CTE (65Ksf, net)

Arlington Career Center – Expansion for 1300 Students

Illustration of **one possible** expansion of Career Center to serve 1300 students.

- All existing programs, including ACHS, Henry ES and the Public Library remain on-site
- Leverages expansion opportunities by utilizing existing roof for additional instructional space.
- Complies with zoning requirements for building height, setback and lot coverage.

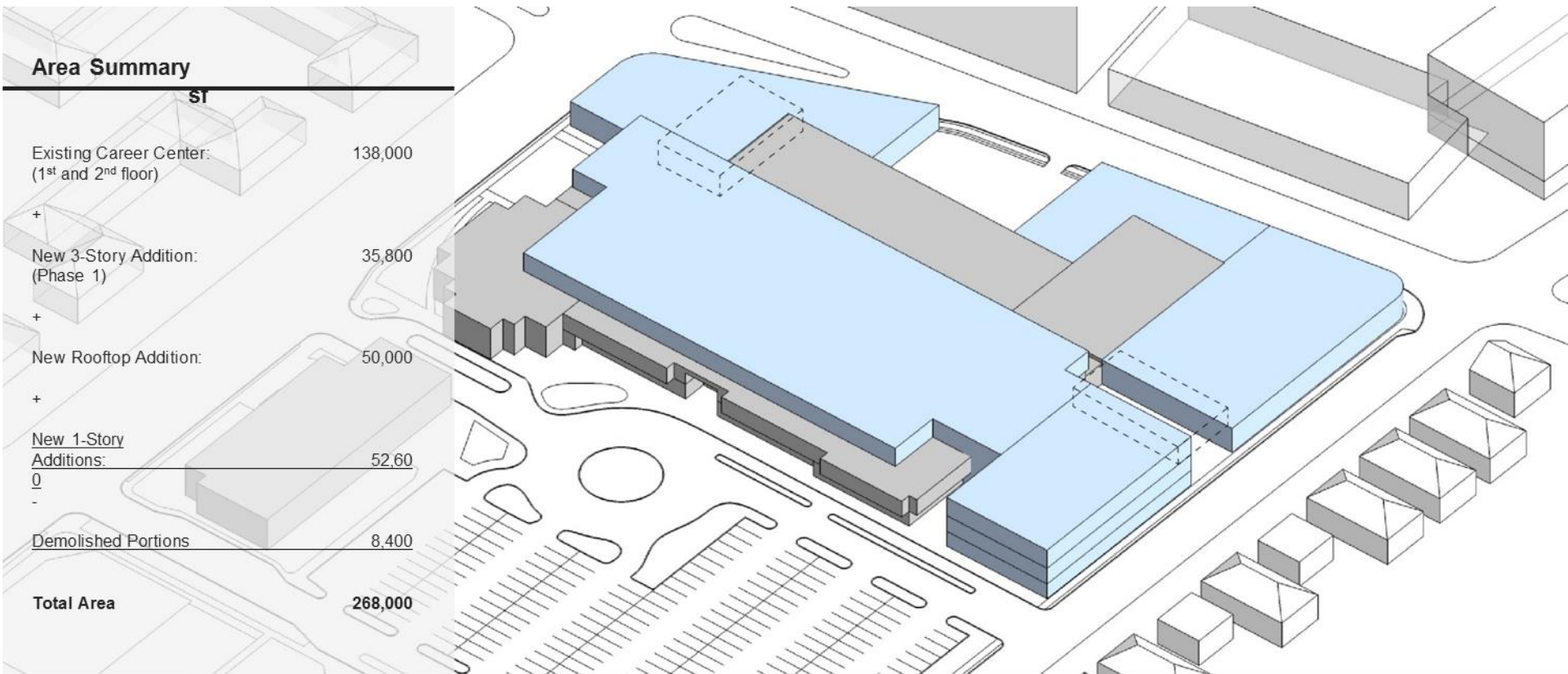

Arlington Career Center – Phase 1 Expansion

Illustration of **one possible** Phase 1 Expansion of the Career Center.

- All existing programs, including ACHS, Henry ES and the Public Library remain on-site
- Complies with zoning requirements for building height, setback and lot coverage.
- Allows future projects to occur in logical, sequential manner with relatively low impact.

